

INDUSTRIAL ALUMINIUM PROFILE SYSTEMS

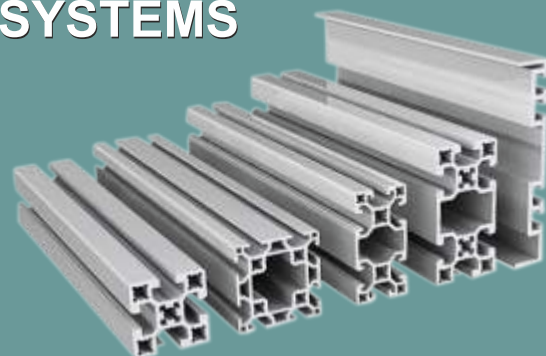

MODULAR CONSTRUCTION TECHNOLOGIES
ACCESSORIES CONVEYORS SYSTEMS

ΚΑΤΑΛΟΓΟΣ
2021



e-mail: sales@aluminium-profile.gr

www.aluminium-profile.gr

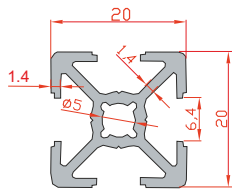

Code	Product Name	Material	Moment of Inertia		Moment of Resistance		Volume	Weight
			I_x	I_y	W_x	W_y		
M 63	20x20	6063	0,61cm ⁴	0,61cm ⁴	0,61cm ³	0,61cm ³	1,42cm ²	0,38 Kg/m

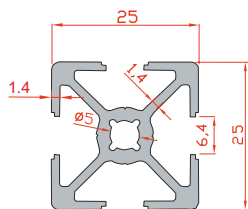

Code	Product Name	Material	Moment of Inertia		Moment of Resistance		Volume	Weight
			I_x	I_y	W_x	W_y		
M 63/A	25x25	6063	1,39cm ⁴	1,39cm ⁴	1,11cm ³	1,11cm ³	2,12cm ²	0,55 Kg/m

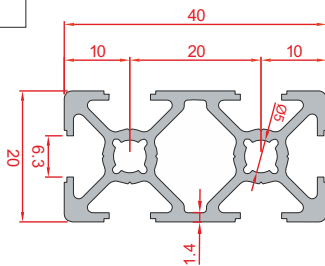

Code	Product Name	Material	Moment of Inertia		Moment of Resistance		Volume	Weight
			I_x	I_y	W_x	W_y		
M 99	20x40	6063	4,17cm ⁴	1,12cm ⁴	2,08cm ³	1,12cm ³	2,6cm ²	0,73 Kg/m

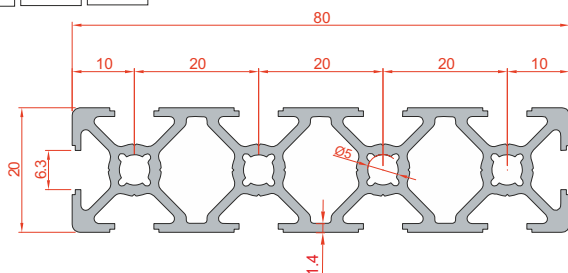

Code	Product Name	Material	Moment of Inertia		Moment of Resistance		Volume	Weight
			I_x	I_y	W_x	W_y		
M 95	20x80	6063	29,14cm ⁴	2,12cm ⁴	7,28cm ³	2,12cm ³	4,88cm ²	1,32 Kg/m

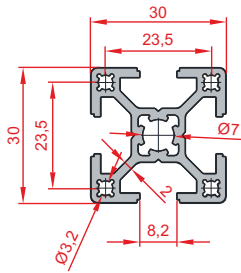

Code	Product Name	Material	Moment of Inertia		Moment of Resistance		Volume	Weight
			I_x	I_y	W_x	W_y		
M 22	30X30	6063	2,95cm ⁴	2,95cm ⁴	1,97cm ³	1,97cm ³	3,16cm ²	0,85 Kg/m

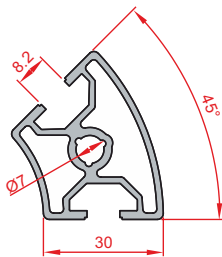

Code	Product Name	Material	Moment of Inertia		Moment of Resistance		Volume	Weight
			I_x	I_y	W_x	W_y		
M 30X45 D	30x45	6063	3,02cm ⁴	4,57cm ⁴	2,1cm ³	2,2cm ³	3,35cm ²	0,91 Kg/m

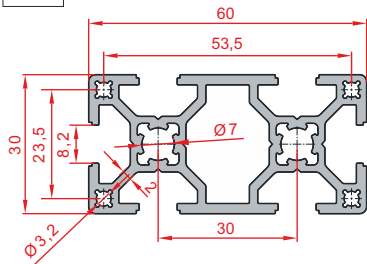

Code	Product Name	Material	Moment of Inertia		Moment of Resistance		Volume	Weight
			I_x	I_y	W_x	W_y		
M 26	30X60	6063	20,12cm ⁴	5,46cm ⁴	6,71cm ³	3,64cm ³	5,59cm ²	1,51 Kg/m

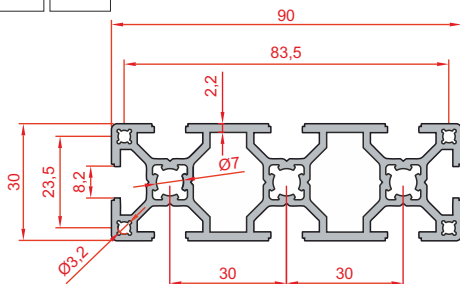

Code	Product Name	Material	Moment of Inertia		Moment of Resistance		Volume	Weight
			I_x	I_y	W_x	W_y		
M 19	30X90	6063	63,29cm ⁴	7,99cm ⁴	14,06cm ³	5,32cm ³	8,12cm ²	2,19 Kg/m

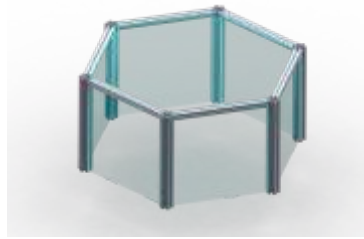
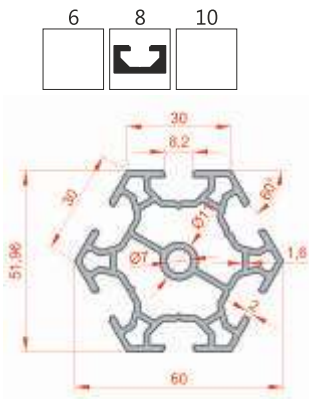

Code	Product Name	Material	Moment of Inertia		Moment of Resistance		Volume	Weight
			lx	ly	Wx	Wy		
HEX 30	HEXAGON STAND 30	6063	14,6 cm ⁴	14,9 cm ⁴	cm ³	cm ⁴	6,3 cm ²	1,72Kg/m

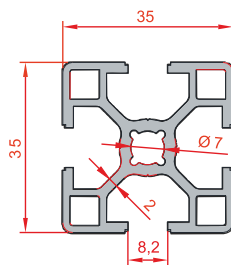

Code	Product Name	Material	Moment of Inertia		Moment of Resistance		Volume	Weight
			lx	ly	Wx	Wy		
M 11	35X35	6063	4,55cm ⁴	4,55cm ⁴	2,6cm ³	2,6cm ³	3,67cm ²	0,98 Kg/m

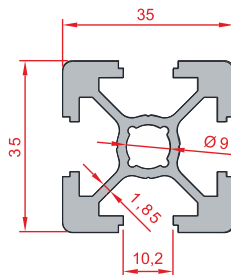

Code	Product Name	Material	Moment of Inertia		Moment of Resistance		Volume	Weight
			lx	ly	Wx	Wy		
M 11/A	35x35 Heavy	6063	6,7cm ⁴	6,7cm ⁴	3,8cm ³	3,8cm ³	4,92cm ²	1,29 Kg/m

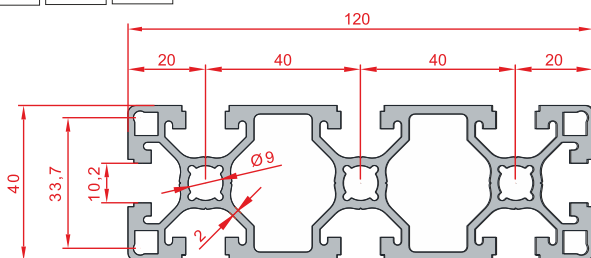
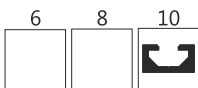

Code	Product Name	Material	Moment of Inertia		Moment of Resistance		Volume	Weight
			lx	ly	Wx	Wy		
M 21	40x120	6063	200,5 cm ⁴	25,7 cm ⁴	33,1 cm ³	13,2 cm ³	13,93 cm ²	3,76 Kg/m

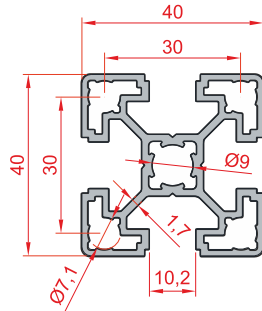

Code	Product Name	Material	Moment of Inertia		Moment of Resistance		Volume	Weight
			I_x	I_y	W_x	W_y		
M 04	40x40	6063	7,10cm ⁴	7,10cm ⁴	3,55cm ³	3,55cm ³	4,49cm ²	1,21Kg/m

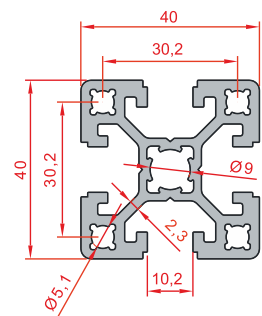

Code	Product Name	Material	Moment of Inertia		Moment of Resistance		Volume	Weight
			I_x	I_y	W_x	W_y		
M 04/A	40x40 Heavy (S10)	6063	10,37cm ⁴	10,37cm ⁴	6,05cm ³	6,05cm ³	6,12cm ²	1,65 Kg/m

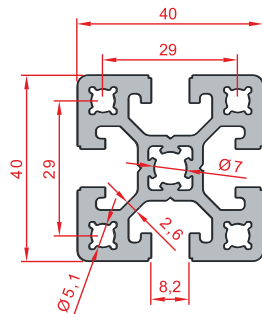

Code	Product Name	Material	Moment of Inertia		Moment of Resistance		Volume	Weight
			I_x	I_y	W_x	W_y		
M 04/G	40x40 Heavy (S8)	6063	12,1cm ⁴	12,1cm ⁴	5,18cm ³	5,18cm ³	7,32cm ²	1,98 Kg/m

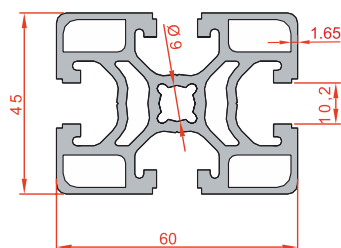
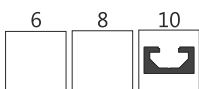

Code	Product Name	Material	Moment of Inertia		Moment of Resistance		Volume	Weight
			I_x	I_y	W_x	W_y		
M 13	45x60	6063	31,29 cm ⁴	18,45 cm ⁴	10,4cm ³	8,2cm ³	9,45 cm ²	2,61 Kg/m

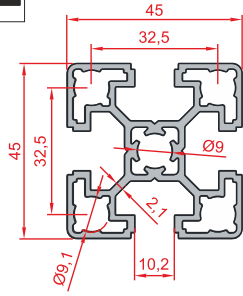
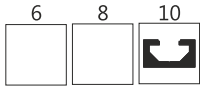

Code	Product Name	Material	Moment of Inertia		Moment of Resistance		Volume	Weight
			I_x	I_y	W_x	W_y		
M 12	45x45	6063	11,09 cm ⁴	11,09 cm ⁴	4,93cm ³	4,93cm ³	5,62cm ²	1,52 Kg/m

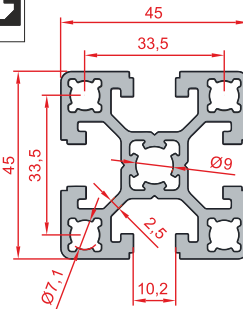

Code	Product Name	Material	Moment of Inertia		Moment of Resistance		Volume	Weight
			I_x	I_y	W_x	W_y		
M 12/E	45x45 Heavy	6063	15,65 cm ⁴	15,65 cm ⁴	6,9cm ³	6,9cm ³	7,63cm ²	2,06 Kg/m

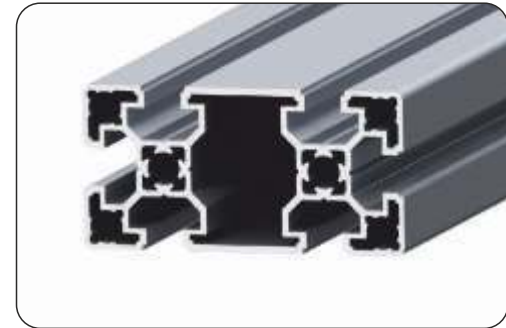
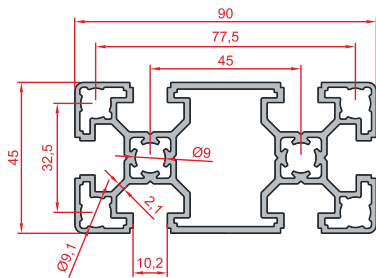
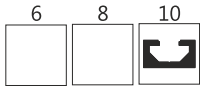

Code	Product Name	Material	Moment of Inertia		Moment of Resistance		Volume	Weight
			I_x	I_y	W_x	W_y		
M 10	45x90	6063	78,98 cm ⁴	20,74 cm ⁴	17,5cm ³	9,2cm ³	9,63 cm ²	2,60 Kg/m

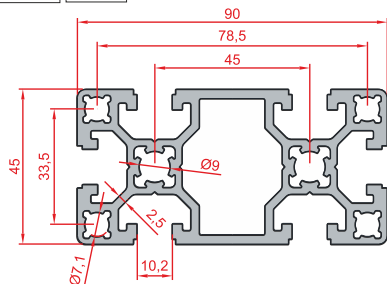

Code	Product Name	Material	Moment of Inertia		Moment of Resistance		Volume	Weight
			I_x	I_y	W_x	W_y		
M 10/B	45x90 Heavy	6063	108,14 cm ⁴	28,67 cm ⁴	24,03cm ³	12,74cm ³	12,86 cm ²	3,47 Kg/m

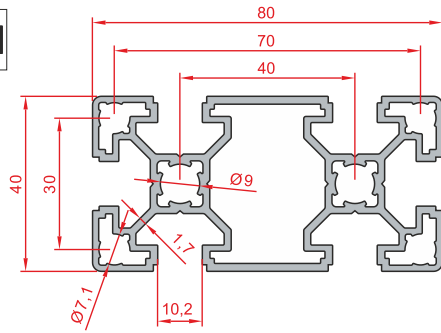
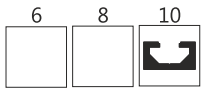

Code	Product Name	Material	Moment of Inertia		Moment of Resistance		Volume	Weight
			I_x	I_y	W_x	W_y		
M 03	40x80	6063	49,98 cm ⁴	13,13 cm ⁴	12,49cm ³	6,56cm ³	7,67 cm ²	2,07 Kg/m

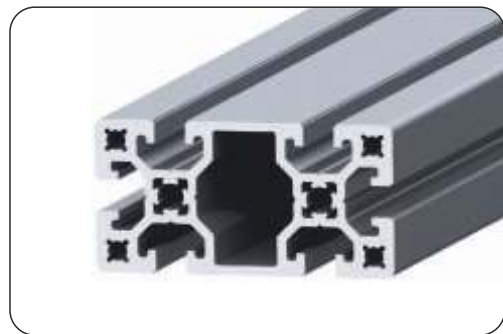
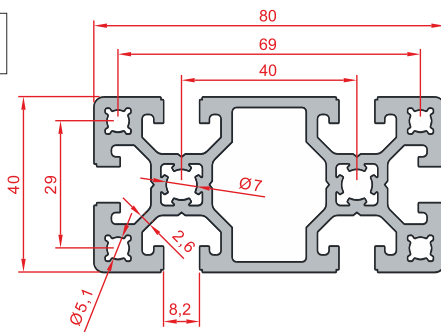

Code	Product Name	Material	Moment of Inertia		Moment of Resistance		Volume	Weight
			I_x	I_y	W_x	W_y		
M 03/B	40x80 Heavy (S8)	6063	82,3 cm ⁴	20,9 cm ⁴	17,38cm ³	9,25cm ³	11,9 cm ²	2,72 Kg/m

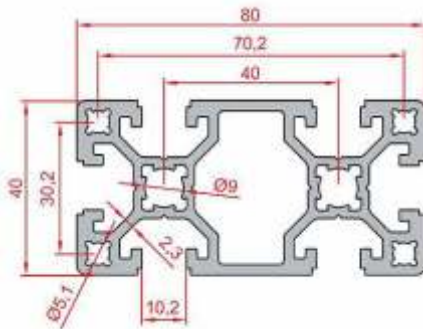
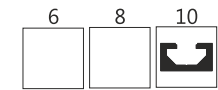

Code	Product Name	Material	Moment of Inertia		Moment of Resistance		Volume	Weight
			I_x	I_y	W_x	W_y		
M 03/A	40x80 Heavy (S10)	6063	69,52 cm ⁴	18,51 cm ⁴	17,38 cm ³	9,25 cm ³	10,23 cm ²	2,76 Kg/m

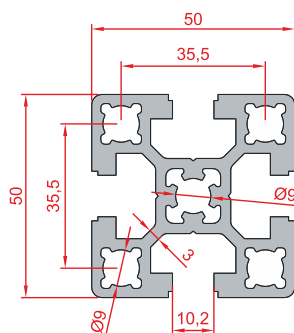
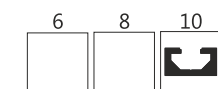

Code	Product Name	Material	Moment of Inertia		Moment of Resistance		Volume	Weight
			I_x	I_y	W_x	W_y		
M 46	50x50	6063	24,7 cm ⁴	24,5 cm ⁴	9,88cm ³	9,8cm ³	10 cm ²	2,70 Kg/m

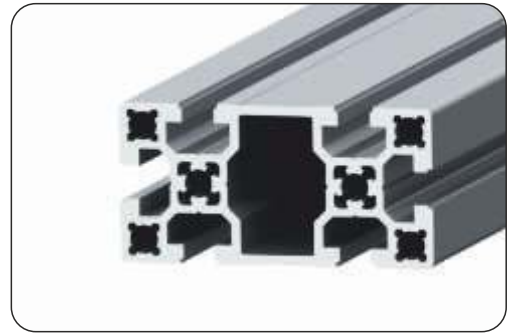
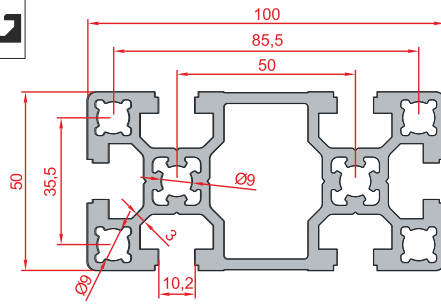

Code	Product Name	Material	Moment of Inertia		Moment of Resistance		Volume	Weight
			I_x	I_y	W_x	W_y		
M 101	50x100	6063	175 cm ⁴	45,2 cm ⁴	35cm ³	18,1cm ³	16,92 cm ²	4,57 Kg/m

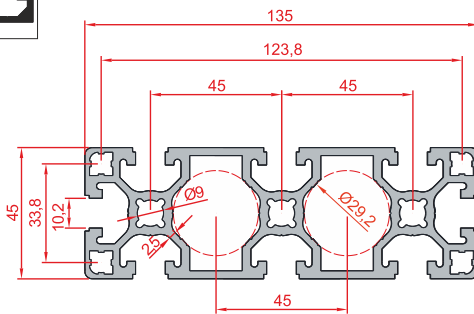

Code	Product Name	Material	Moment of Inertia		Moment of Resistance		Volume	Weight
			I_x	I_y	W_x	W_y		
M 60	45x135	6063	41,8cm ⁴	32,4cm ⁴	6,19cm ³	14,4cm ³	18,3cm ²	

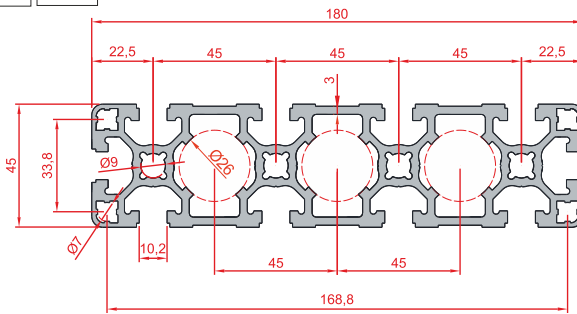
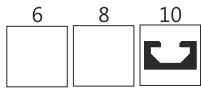

Code	Product Name	Material	Moment of Inertia		Moment of Resistance		Volume	Weight
			I_x	I_y	W_x	W_y		
M 15	45x180	6063	747cm ⁴	56,7cm ⁴	83cm ³	25,2cm ³	25,1cm ²	6,82 Kg/m

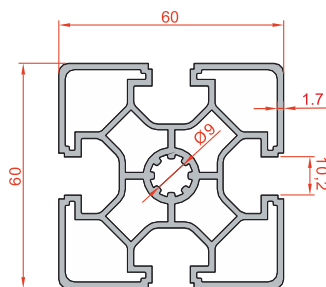
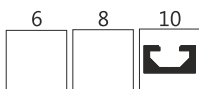

Code	Product Name	Material	Moment of Inertia		Moment of Resistance		Volume	Weight
			I_x	I_y	W_x	W_y		
M 28	60x60	6063	29,85 cm ⁴	29,85 cm ⁴	9,9cm ³	9,9cm ³	8,8cm ²	2,46 Kg/m

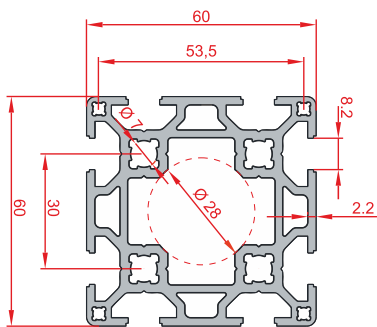

Code	Product Name	Material	Moment of Inertia		Moment of Resistance		Volume	Weight
			I_x	I_y	W_x	W_y		
M 28/B	60x60 Heavy	6063	41 cm ⁴	41 cm ⁴	13,6cm ³	13,6cm ³	11,06 cm ²	3,05 Kg/m

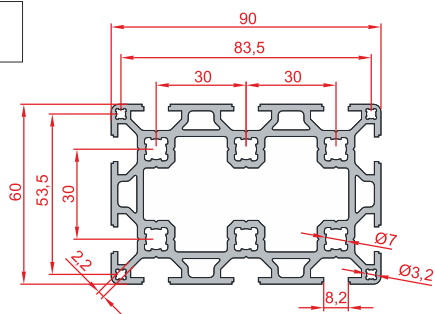
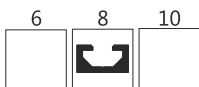

Code	Product Name	Material	Moment of Inertia		Moment of Resistance		Volume	Weight
			I_x	I_y	W_x	W_y		
M 28/X	60x90	6063	59,4cm ⁴	122cm ⁴	26,8cm ³	46,51cm ³	14,7cm ²	4 Kg/m

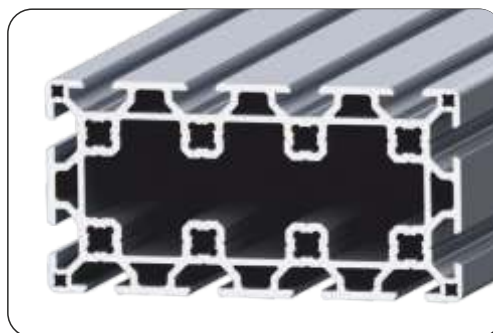
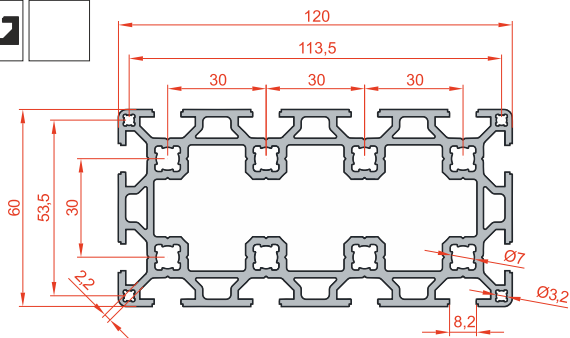

Code	Product Name	Material	Moment of Inertia		Moment of Resistance		Volume	Weight
			I_x	I_y	W_x	W_y		
M 28/Y	60x120	6063	80,9cm ⁴	280,4cm ⁴	26,8cm ³	46,51cm ³	19,7cm ²	5,33 Kg/m

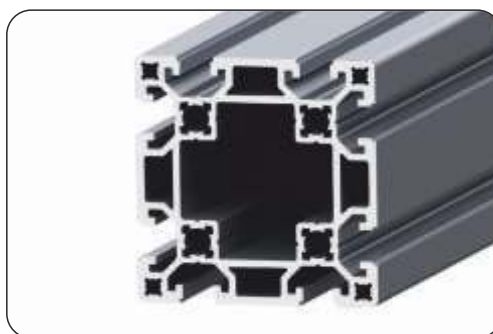
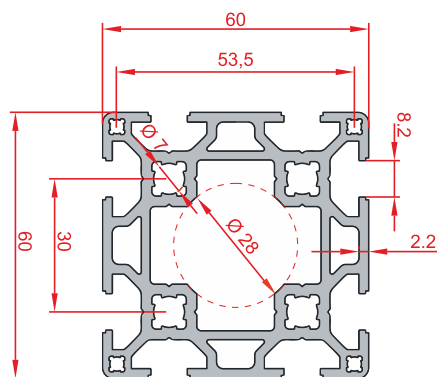
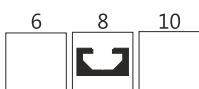

Code	Product Name	Material	Moment of Inertia		Moment of Resistance		Volume	Weight
			I_x	I_y	W_x	W_y		
M 02/B	80x80 Heavy S8	6063	41 cm ⁴	41 cm ⁴	13,6 cm ³	13,6 cm ³	11,06 cm ²	5,37 Kg/m

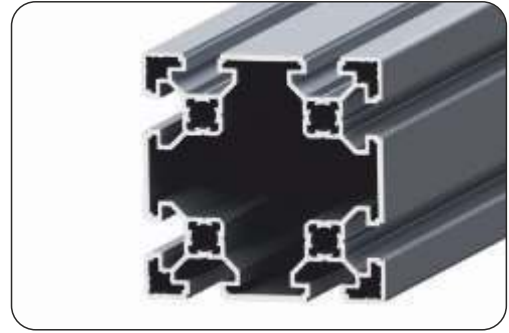
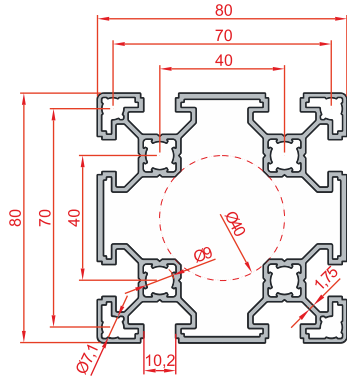
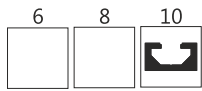

Code	Product Name	Material	Moment of Inertia		Moment of Resistance		Volume	Weight
			I_x	I_y	W_x	W_y		
M 02	80x80	6063	88,08cm ⁴	88,08cm ⁴	22,02cm ³	22,02cm ³	11,91cm ²	3,22 Kg/m

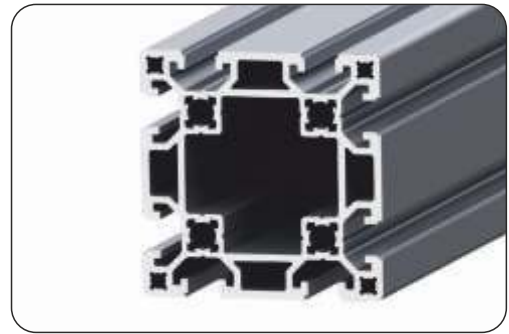
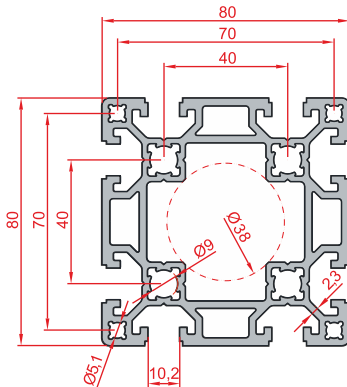

Code	Product Name	Material	Moment of Inertia		Moment of Resistance		Volume	Weight
			I_x	I_y	W_x	W_y		
M 02/A	80x80 Heavy	6063	127,1cm ⁴	127,1cm ⁴	31,78cm ³	31,78cm ³	17,77cm ²	4,80 Kg/m

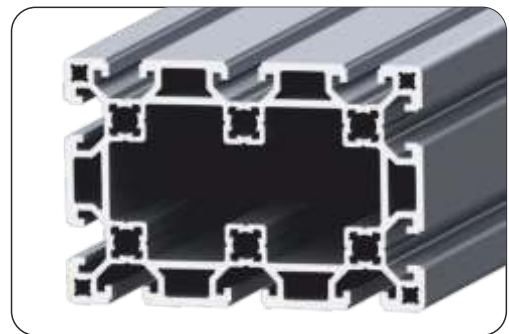
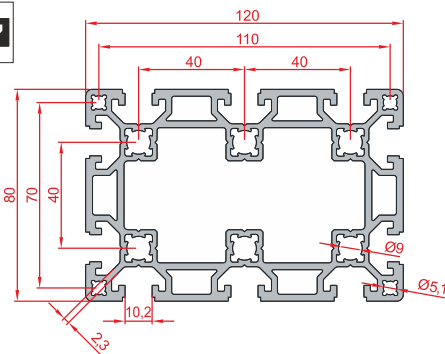
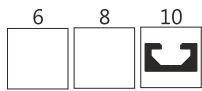

Code	Product Name	Material	Moment of Inertia		Moment of Resistance		Volume	Weight
			I_x	I_y	W_x	W_y		
M 02/X	80x120	6063	185,3cm ⁴	379,5cm ⁴	60,55cm ³	210,95cm ³	24,3cm ²	6,57 Kg/m

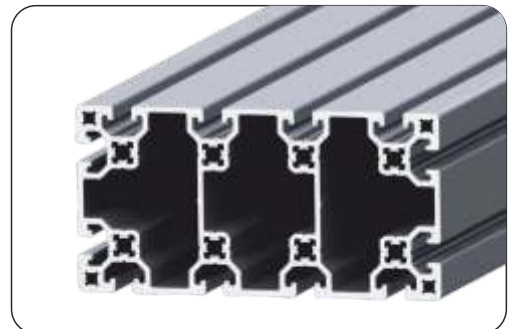
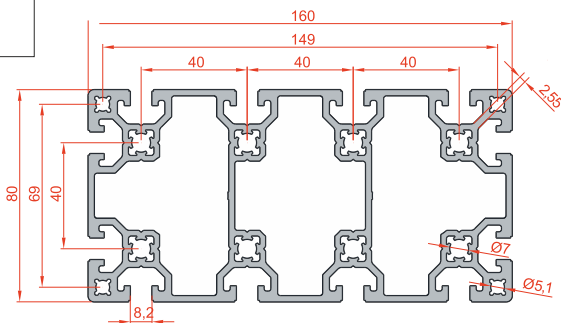

Code	Product Name	Material	Moment of Inertia		Moment of Resistance		Volume	Weight
			I_x	I_y	W_x	W_y		
MG 160	80x160	6063	242,2cm ⁴	843,8cm ⁴	60,55cm ³	210,95cm ³	30,5cm ²	8,25 Kg/m

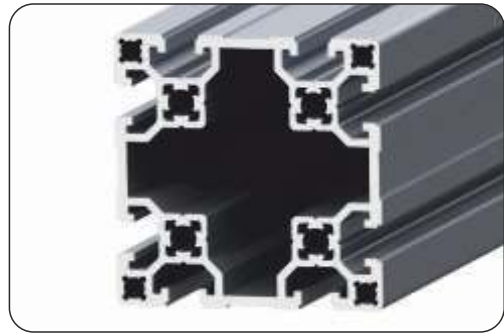
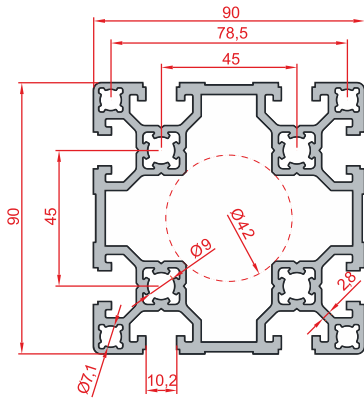
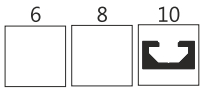

Code	Product Name	Material	Moment of Inertia		Moment of Resistance		Volume	Weight
			I _x	I _y	W _x	W _y		
M 30	90x90	6063	192,84cm ⁴	192,84cm ⁴	42,8cm ³	42,8cm ³	20,67cm ²	5,58 Kg/m

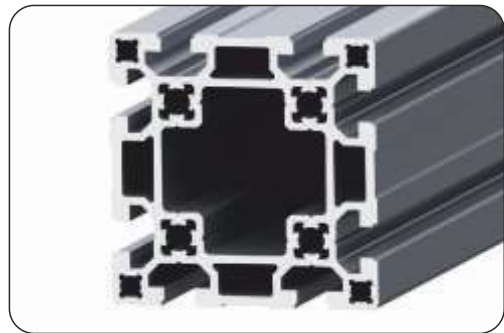
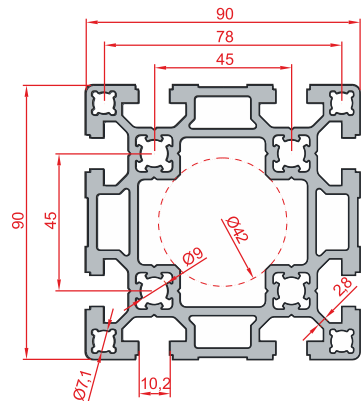
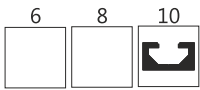

Code	Product Name	Material	Moment of Inertia		Moment of Resistance		Volume	Weight
			I _x	I _y	W _x	W _y		
M 30/A	90x90 Heavy	6063	220,49cm ⁴	220,49cm ⁴	48,9cm ³	48,9cm ³	25,31cm ²	6,83 Kg/m

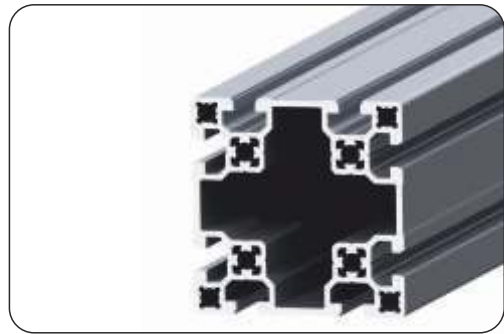
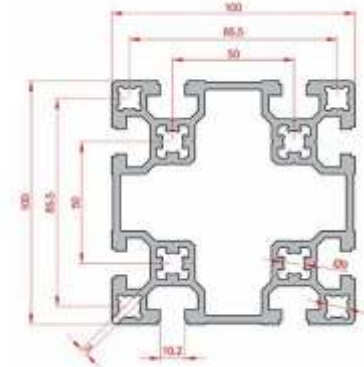

Code	Product Name	Material	Moment of Inertia		Moment of Resistance		Volume	Weight
			I _x	I _y	W _x	W _y		
MG 100	100 X 100	6063-T5	295,4 cm ⁴	295,4 cm ⁴	cm ³	cm ⁴	25,5 cm ²	6,89Kg/m

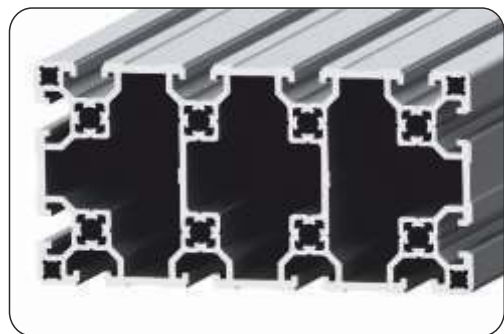
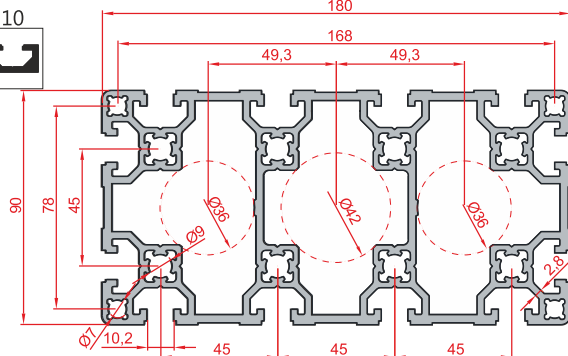
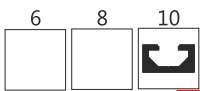

Code	Product Name	Material	Moment of Inertia		Moment of Resistance		Volume	Weight
			I _x	I _y	W _x	W _y		
M 14/L	90x180	6063	1240,6cm ⁴	361,5cm ⁴	137,8cm ³	80,3cm ³	37,1cm ²	10,01 Kg/m

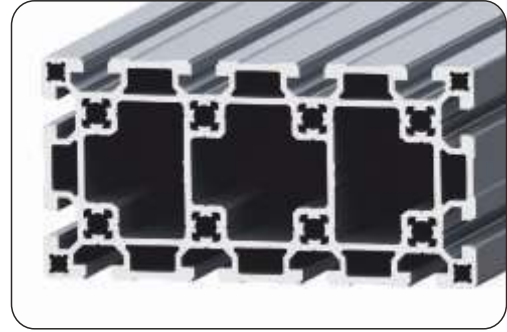
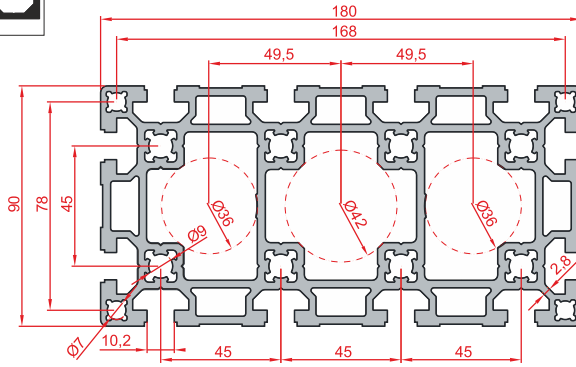
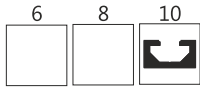

Code	Product Name	Material	Moment of Inertia		Moment of Resistance		Volume	Weight
			I _x	I _y	W _x	W _y		
M 14	90x180 Heavy	6063	1499cm ⁴	427,6cm ⁴	166,5cm ³	95,02cm ³	46,7cm ²	12,60 Kg/m

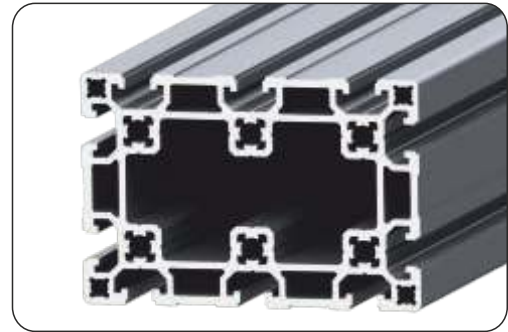
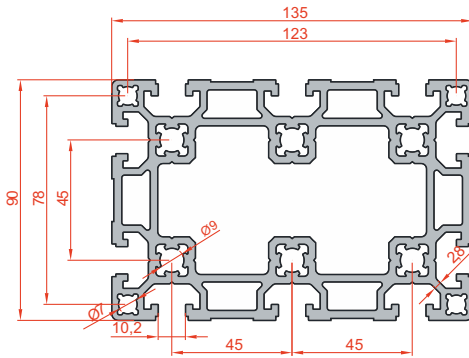

Code	Product Name	Material	Moment of Inertia		Moment of Resistance		Volume	Weight
			I _x	I _y	W _x	W _y		
M 32/A	90x135	6063	313,64cm ⁴	653cm ⁴	69,18cm ³	96,74cm ³	34,42cm ²	9,29 Kg/m

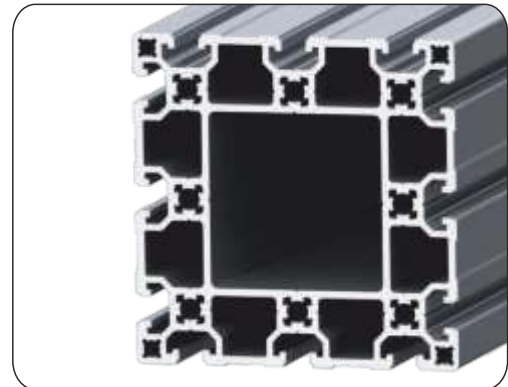
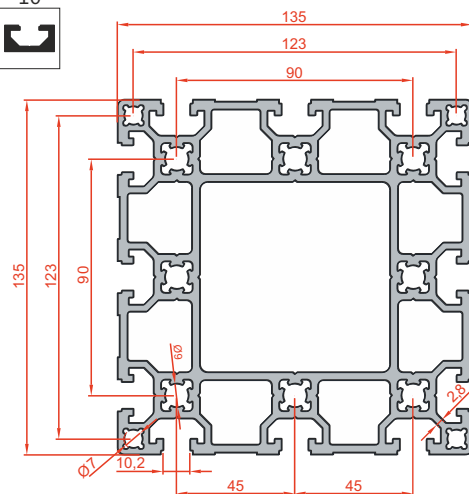

Code	Product Name	Material	Moment of Inertia		Moment of Resistance		Volume	Weight
			I _x	I _y	W _x	W _y		
M 32	135x135	6063	897,64cm ⁴	897,64cm ⁴	132,91cm ³	132,91cm ³	44,52cm ²	12,02 Kg/m

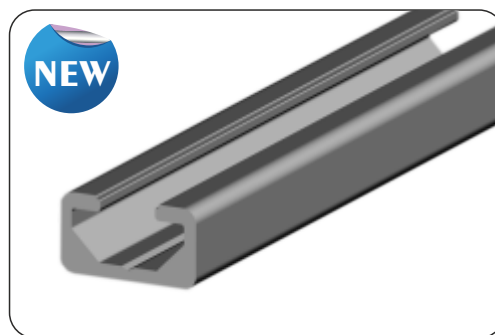
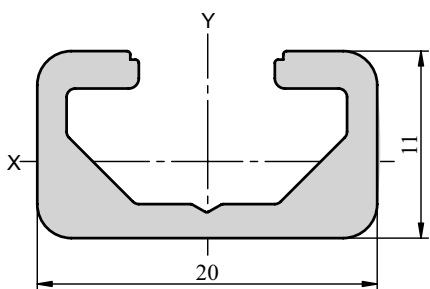
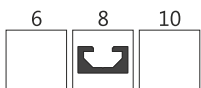

Code	Product Name	Material	Moment of Inertia		Moment of Resistance		Volume	Weight
			I_x	I_y	W_x	W_y		
AL 112	11x20	6063	0,13cm ⁴	0,52cm ⁴	0,20cm ³	0,52 cm ³	1,02 cm ²	0,28 Kg/m

*ΠΩΛΕΙΤΑΙ ΜΟΝΟ 2 ΜΕΤΡΗ ΒΕΡΓΑ

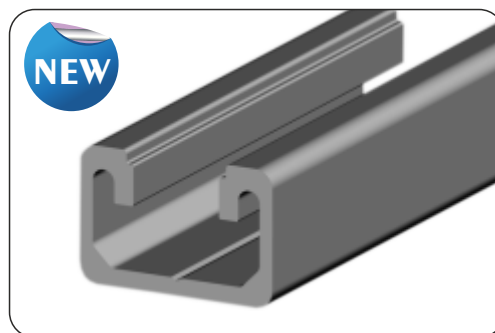
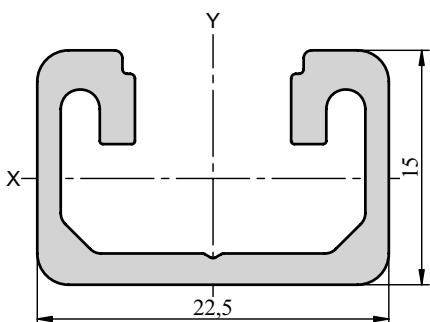
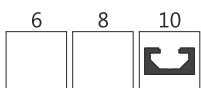

Code	Product Name	Material	Moment of Inertia		Moment of Resistance		Volume	Weight
			I_x	I_y	W_x	W_y		
AL 152	15x22.5	6063	0,33 cm ⁴	0,81 cm ⁴	0,40 cm ³	0,72 cm ³	1,21 cm ²	0,33 Kg/m

*ΠΩΛΕΙΤΑΙ ΜΟΝΟ 3 ΜΕΤΡΗ ΒΕΡΓΑ

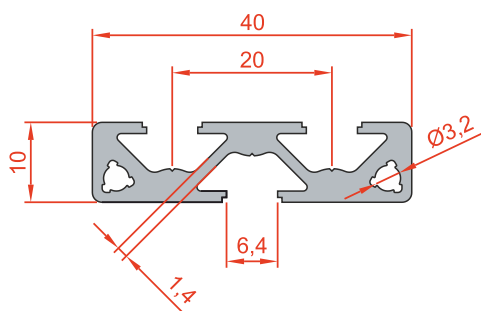
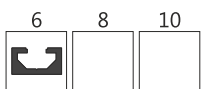

Code	Product Name	Material	Moment of Inertia		Moment of Resistance		Volume	Weight
			I_x	I_y	W_x	W_y		
FC 40	Floor Cover Profile 10x40	6063	3,37cm ⁴	20cm ⁴	61cm ³	69cm ³	04cm ²	0,55 Kg/m

*ΕΛΑΧΙΣΤΟ ΜΗΚΟΣ ΚΟΠΗΣ 1200 χιλ. (ΓΙΑ 6ΜΕΤΡΕΣ ΒΕΡΓΕΣ)

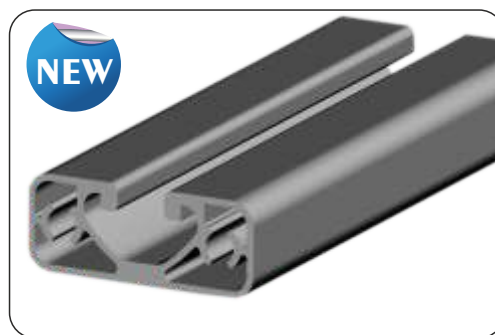
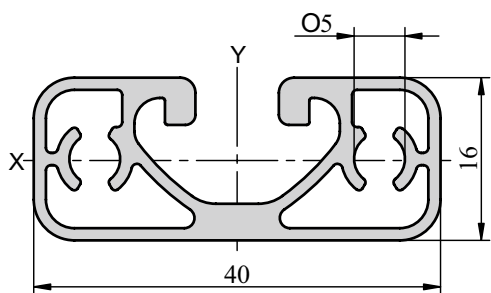
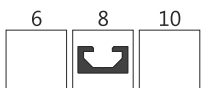

Code	Product Name	Material	Moment of Inertia		Moment of Resistance		Volume	Weight
			I_x	I_y	W_x	W_y		
AL 164	16x40	6063	0,69cm ⁴	3,71 cm ⁴	0,84 cm ³	1,86 cm ³	2,45 cm ²	0,66 Kg/m

*ΕΛΑΧΙΣΤΟ ΜΗΚΟΣ ΚΟΠΗΣ 1000 χιλ. (ΓΙΑ 3ΜΕΤΡΕΣ ΒΕΡΓΕΣ)

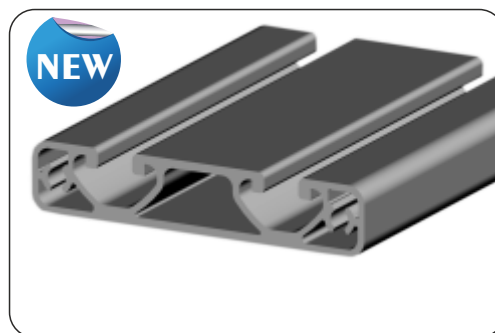
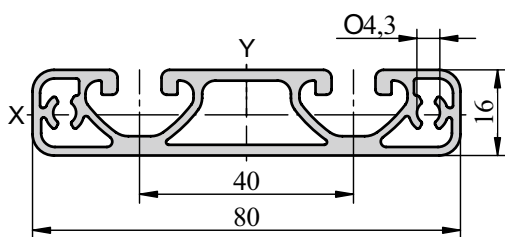
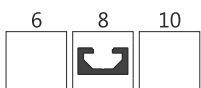

Code	Product Name	Material	Moment of Inertia		Moment of Resistance		Volume	Weight
			I_x	I_y	W_x	W_y		
AL 168	16x80	6063	1,57cm ⁴	31,32 cm ⁴	1,89 cm ³	7,83 cm ³	4,98 cm ²	1,34 Kg/m

*ΕΛΑΧΙΣΤΟ ΜΗΚΟΣ ΚΟΠΗΣ 1000 χιλ. (ΓΙΑ 3ΜΕΤΡΕΣ ΒΕΡΓΕΣ)

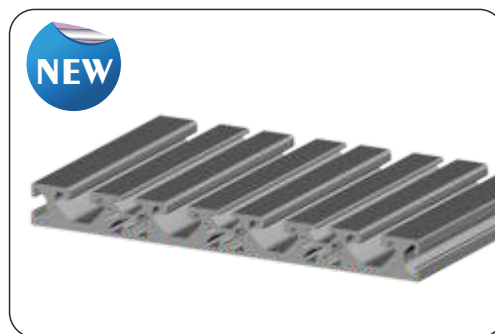
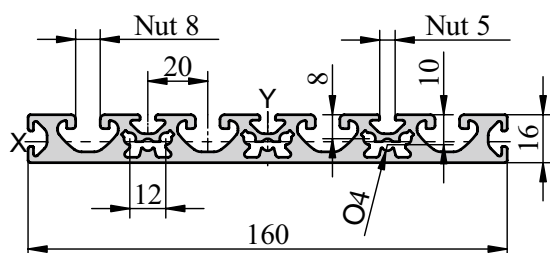

Code	Product Name	Material	Moment of Inertia		Moment of Resistance		Volume	Weight
			I_x	I_y	W_x	W_y		
AL 160	16x160	6063	3,37cm ⁴	20cm ⁴	61cm ³	69cm ³	04cm ²	0,55 Kg/m

*ΕΛΑΧΙΣΤΟ ΜΗΚΟΣ ΚΟΠΗΣ 1000 χιλ. (ΓΙΑ 3ΜΕΤΡΕΣ ΒΕΡΓΕΣ)

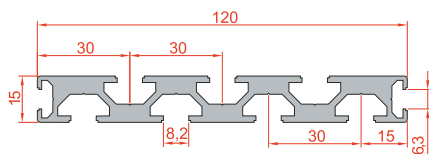

Code	Product Name	Material	Moment of Inertia		Moment of Resistance		Volume	Weight
			I_x	I_y	W_x	W_y		
M 17	15x120	6063	105,7cm ⁴	2,1cm ⁴	17,6cm ³	2,8cm ³	8,6 cm ²	2,33 Kg/m

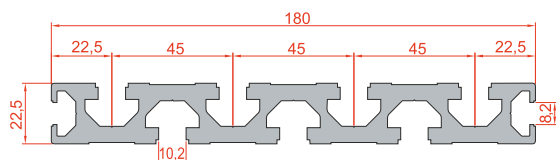

Code	Product Name	Material	Moment of Inertia		Moment of Resistance		Volume	Weight
			I_x	I_y	W_x	W_y		
M 16	22,5x180	6063	570,9cm ⁴	11,7cm ⁴	63,43cm ³	10,4cm ³	21,1cm ²	5,70 Kg/m

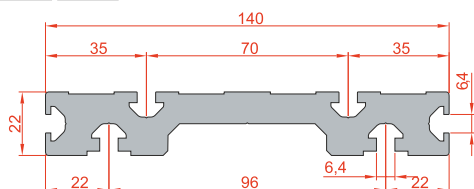

Code	Product Name	Material	Moment of Inertia		Moment of Resistance		Volume	Weight
			I_x	I_y	W_x	W_y		
M 15 ZE	22x140	6063	365cm ⁴	7,2cm ⁴	52,14cm ³	6,54cm ³	19,8cm ²	5,39 Kg/m

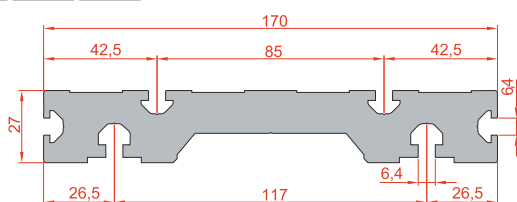

Code	Product Name	Material	Moment of Inertia		Moment of Resistance		Volume	Weight
			I_x	I_y	W_x	W_y		
M 20 ZE	27x170	6063	852cm ⁴	16,8cm ⁴	100,2cm ³	12,4cm ³	32,44cm ²	8,79 Kg/m

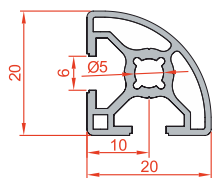

Code	Product Name	Material	Moment of Inertia		Moment of Resistance		Volume	Weight
			I_x	I_y	W_x	W_y		
M 63/R	20x20 Radius	6063	0,65 cm ⁴	0,65 cm ⁴	0,61cm ³	0,61cm ³	1,42 cm ²	0,38 Kg/m

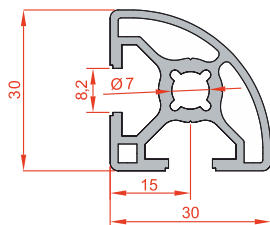

Code	Product Name	Material	Moment of Inertia		Moment of Resistance		Volume	Weight
			I_x	I_y	W_x	W_y		
M 22/R	30x30 Radius	6063	2,15 cm ⁴	2,15 cm ⁴	1,30cm ³	1,30cm ³	2,78 cm ²	0,77 Kg/m

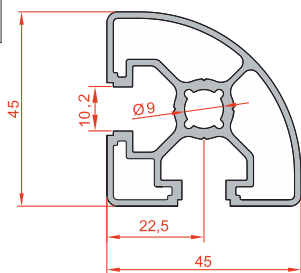

Code	Product Name	Material	Moment of Inertia		Moment of Resistance		Volume	Weight
			I_x	I_y	W_x	W_y		
M 21/R	45x45 Radius	6063	8,5 cm ⁴	8,5 cm ⁴	3,38cm ³	3,38cm ³	4,46 cm ²	1,24 Kg/m

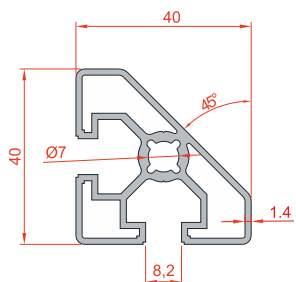

Code	Product Name	Material	Moment of Inertia		Moment of Resistance		Volume	Weight
			I_x	I_y	W_x	W_y		
M 39/A	40x40 (45°)	6063	4,4cm ⁴	4,4cm ⁴	1,90cm ³	1,90cm ³	3,43cm ²	0,93 Kg/m

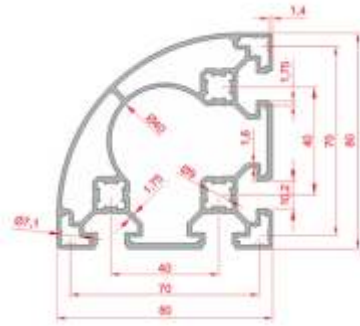

Code	Product Name	Material	Moment of Inertia		Moment of Resistance		Volume	Weight
			I_x	I_y	W_x	W_y		
M 83/R	80x80 Radius	6063	48,43 cm ⁴	48,43 cm ⁴	12,10 cm ³	12,10 cm ³	10,23 cm ²	2,76 Kg/m

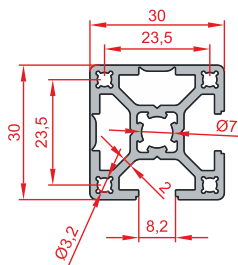

Code	Product Name	Material	Moment of Inertia		Moment of Resistance		Volume	Weight
			I_x	I_y	W_x	W_y		
M 22-K	30x30 Closed	6063	3,17cm ⁴	3,18cm ⁴	2,05cm ³	2,05cm ³	3,37cm ²	0,91 Kg/m

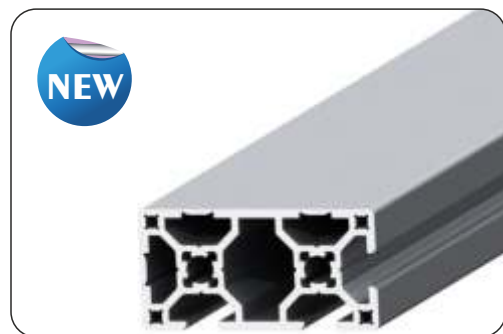
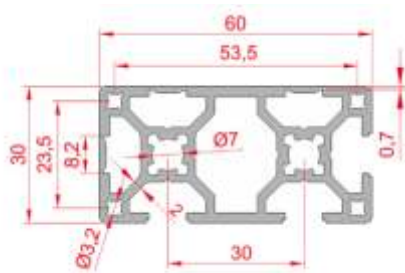

Code	Product Name	Material	Moment of Inertia		Moment of Resistance		Volume	Weight
			I_x	I_y	W_x	W_y		
M 23-K	30x60 Closed	6063	21,55 cm ⁴	5,90 cm ⁴	7,18 cm ³	3,93 cm ³	5,92 cm ²	1,60 Kg/m

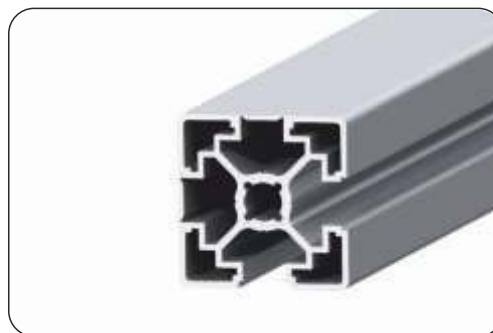
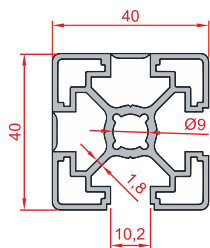

Code	Product Name	Material	Moment of Inertia		Moment of Resistance		Volume	Weight
			I_x	I_y	W_x	W_y		
M 04-K	40x40 Closed	6063	7,24cm ⁴	7,27cm ⁴	3,52cm ³	3,52cm ³	4,6cm ²	1,27 Kg/m

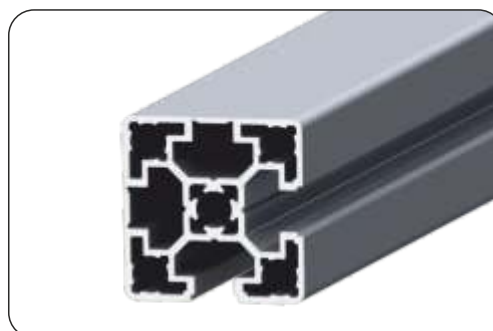
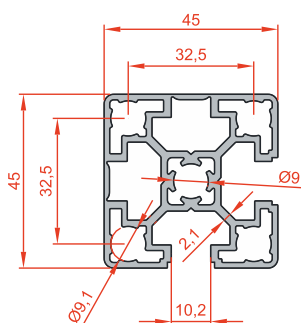

Code	Product Name	Material	Moment of Inertia		Moment of Resistance		Volume	Weight
			I_x	I_y	W_x	W_y		
M 05-K	45x45 Closed	6063	11,78cm ⁴	11,78cm ⁴	5,24cm ³	5,24cm ³	5,90cm ²	1,59 Kg/m

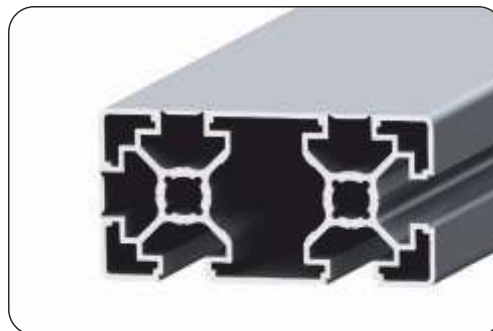
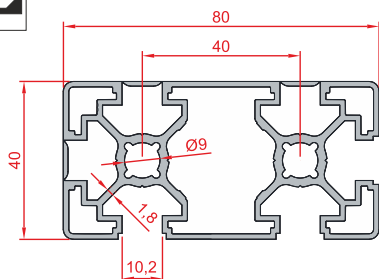

Code	Product Name	Material	Moment of Inertia		Moment of Resistance		Volume	Weight
			I_x	I_y	W_x	W_y		
M 03-K	40x80 Closed	6063	50,9cm ⁴	12,9cm ⁴	12,51cm ³	6,23cm ³	7,7cm ²	2,08 Kg/m

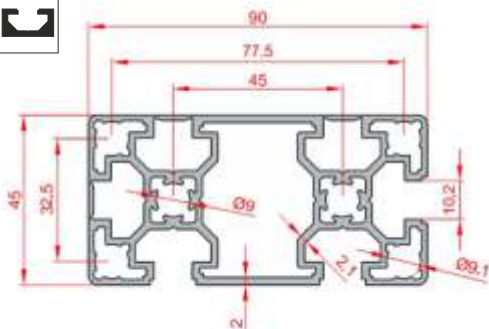

Code	Product Name	Material	Moment of Inertia		Moment of Resistance		Volume	Weight
			I_x	I_y	W_x	W_y		
M 09-K	45x90 Closed	6063	83,69 cm ⁴	22,22 cm ⁴	18,59 cm ³	9,87 cm ³	10,01 cm ²	2,73 Kg/m

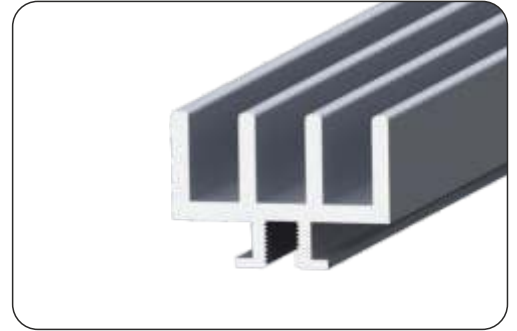
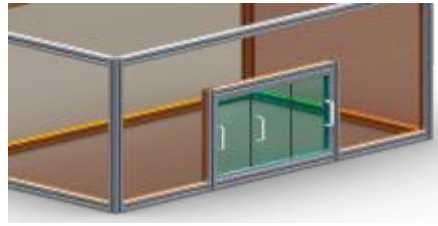
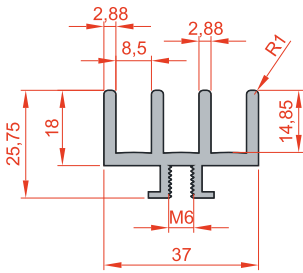

Code	Product Name	Material	Moment of Inertia		Moment of Resistance		Volume	Weight
			lx	ly	Wx	Wy		
MG 37	SLIDE PROFILE 18 X 37	6063	1,37 cm ⁴	4,15 cm ⁴	cm ³	cm ³	3,37cm ²	0,89 Kg/m

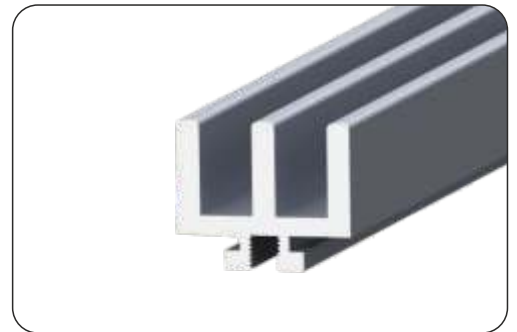
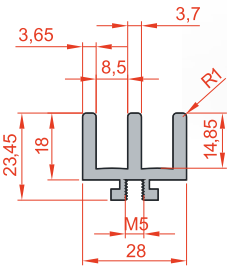
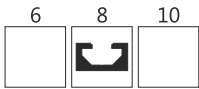

Code	Product Name	Material	Moment of Inertia		Moment of Resistance		Volume	Weight
			lx	ly	Wx	Wy		
MG 28	SLIDE PROFILE 18 X 28	6063	1,09 cm ⁴	2,24 cm ⁴	cm ³	cm ³	3,37cm ²	0,76 Kg/m



ØD	Κωδικός	Βάρος kg/m	Διαστάσεις (mm)			Μήκος: 6000 χιλιοστά				
			A	H	H1	B	Ød1	C1	C2	K DIN 6912
12	M DP 12	0,69	40	22 ±0,1	5	29	4,5	50	75	M 4x16
16	M DP 16	0,84	45	26 ±0,1	5	33	5,5	50	100	M 5x20
20	M DP 20	1,23	52	32 ±0,1	5,8	37	6,5	50	100	M 6x25
25	M DP 25	1,44	57	36 ±0,1	6	42	6,5	60	120	M 8x30
30	M DP 30	2,00	69	42 ±0,15	7	51	8,5	75	150	M 10x35
40	M DP 40	2,60	73	50 ±0,15	8	55	9	100	200	M 10x40

* Στα παραπάνω προφίλ δεν περιλαμβάνονται οι άξονες

*ΕΛΑΧΙΣΤΟ ΜΗΚΟΣ ΚΟΠΗΣ 1200 χιλ. (ΓΙΑ 6ΜΕΤΡΕΣ ΒΕΡΓΕΣ)

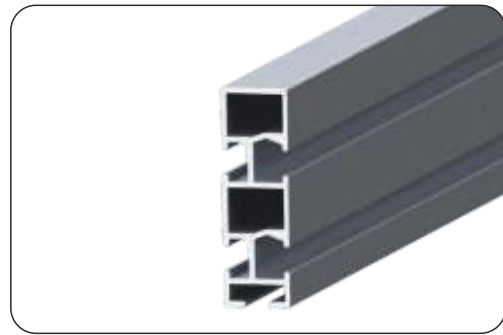
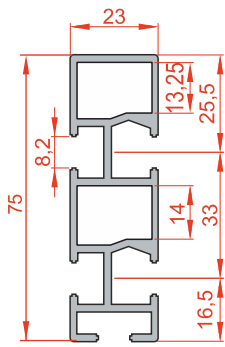
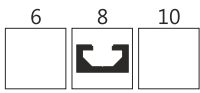

Code	Product Name	Material	Moment of Inertia		Moment of Resistance		Volume	Weight
			I_x	I_y	W_x	W_y		
M 24/D	23x75	6063	3,11cm ⁴	26,03cm ⁴	3,65cm ³	3,65cm ³	4,86cm ²	1,31 Kg/m

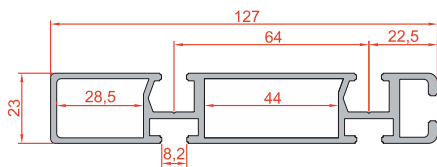

Code	Product Name	Material	Moment of Inertia		Moment of Resistance		Volume	Weight
			I_x	I_y	W_x	W_y		
M 29	23x127	6063	114,6cm ⁴	5,5cm ⁴	17,47cm ³	4,8cm ³	7,4cm ²	2,05 Kg/m

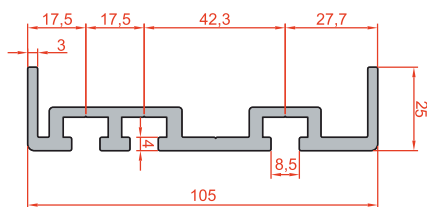

Code	Product Name	Material	Moment of Inertia		Moment of Resistance		Volume	Weight
			I_x	I_y	W_x	W_y		
M 29/A	25x105	6063	87,1cm ⁴	2,4cm ⁴	15,07cm ³	1,49cm ³	7,45cm ²	1,98 Kg/m

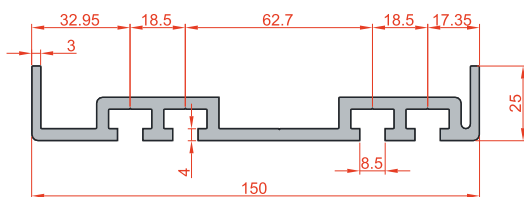

Code	Product Name	Material	Moment of Inertia		Moment of Resistance		Volume	Weight
			I_x	I_y	W_x	W_y		
M 29/B	25x150	6063	87,1cm ⁴	2,4cm ⁴	11,46cm ³	1,9cm ³	7,45cm ²	2,90 Kg/m

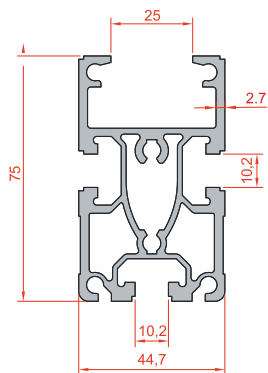
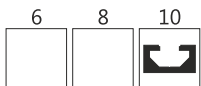

Code	Product Name	Material	Moment of Inertia		Moment of Resistance		Volume	Weight
			I_x	I_y	W_x	W_y		
M 24	45x75 Conveyor	6063	23,46cm ⁴	45,80cm ⁴	10,7cm ³	9,21cm ³	9,42cm ²	2,56 Kg/m

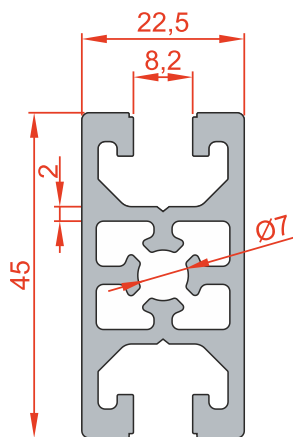
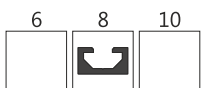

Code	Product Name	Material	Moment of Inertia		Moment of Resistance		Volume	Weight
			I_x	I_y	W_x	W_y		
PP 45	Panel Profile 22,5x45	6063	2,95cm ⁴	8,15cm ⁴	0,42cm ³	0,82cm ³	4,63cm ²	1,25 Kg/m

*ΕΛΑΧΙΣΤΟ ΜΗΚΟΣ ΚΟΠΗΣ 1200 χιλ. (ΓΙΑ 6ΜΕΤΡΕΣ ΒΕΡΓΕΣ)

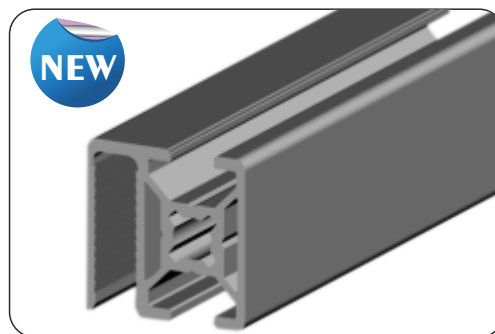
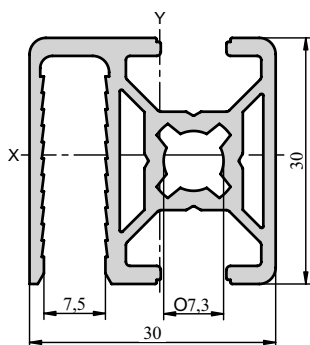
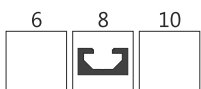

Code	Product Name	Material	Moment of Inertia		Moment of Resistance		Volume	Weight
			I_x	I_y	W_x	W_y		
AL 30 SG	Cover Profile 30x30	6063	2,48cm ⁴	2,91cm ⁴	1,58cm ³	1,83cm ³	3,13 cm ²	0,85 Kg/m

*ΕΛΑΧΙΣΤΟ ΜΗΚΟΣ ΚΟΠΗΣ 1000 χιλ. (ΓΙΑ 3ΜΕΤΡΕΣ ΒΕΡΓΕΣ)

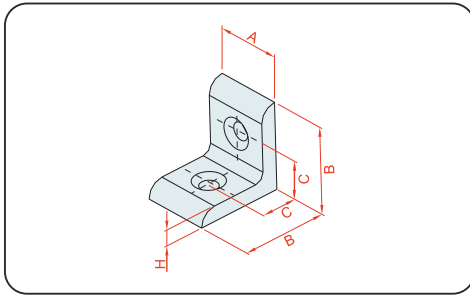

Code	Profile External	Product Name	A	B	C	D	H	Material	Weight
M 53	30x30	Straight Corner Connection	28	22.5	40	Ø6	7	Aluminium	21 gr
M 53/C	40x40	Straight Corner Connection	37	37	20	Ø8.2	6.5	Aluminium	39 gr
M 53/A	45x45	Straight Corner Connection	42	42	22.5	Ø8.2	7	Aluminium	56 gr
M 53/B	80x80	Straight Corner Connection	76	20	76	Ø8.5	8,3	Aluminium	206 gr

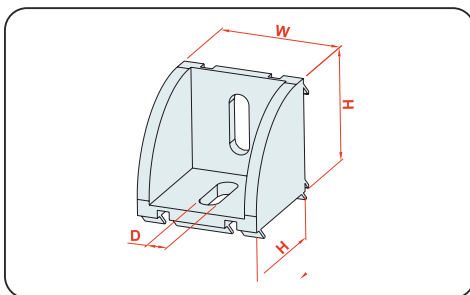

Code	Prof External	Product Name	H	W	D	Material	Weight
M 54/K	20-25	Wide Corner Connection	20	17.5	5	Aluminium	15.5 gr
M 55/G	30x30	Wide Corner Connection	28	28	6.5	Aluminium	41.5 gr
M 55/H	40x40	Wide Corner Connection	37	37.7	9	Aluminium	49 gr
M 55/H8	40x40	Wide Corner Connection S8	37	37.7	9	Aluminium	49 gr
M 54/G	45x45	Wide Corner Connection	44	43	9	Aluminium	75 gr
M 54/F	60x60	Wide Corner Connection	57	57	6.5	Aluminium	98 gr
M 54/I	80x80	Wide Corner Connection	78	77	10	Aluminium	226 gr
M 54/I 8	80x80	Wide Corner Connection S8	78	77	10	Aluminium	226 gr
M 52	90x90	Wide Corner Connection	84.7	86.5	9	Aluminium	366 gr
M 96/K	20-25	Wide Corner Connection Cover	-	-	-	Plastic	2 gr
M 97/G	30x30	Wide Corner Connection Cover	-	-	-	Plastic	4 gr
M 97/A	40x40	Wide Corner Connection Cover	-	-	-	Plastic	8 gr
M 96/G	45x45	Wide Corner Connection Cover	-	-	-	Plastic	10 gr
M 97/B	60x60	Wide Corner Connection Cover	-	-	-	Plastic	8 gr
M 97/C	80x80	Wide Corner Connection Cover	-	-	-	Plastic	27 gr
M 96/D	90x90	Wide Corner Connection Cover	-	-	-	Plastic	24 gr

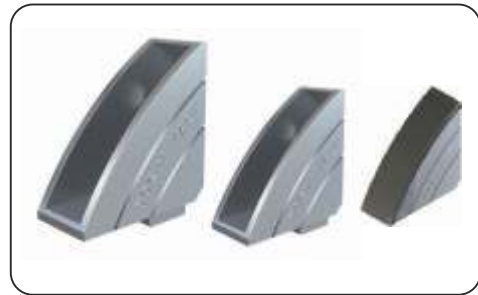
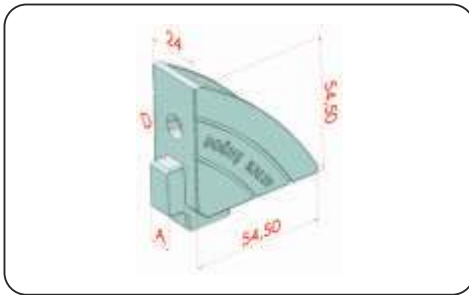

Code	Prof External	Product Name	A	D	Material	Weight
M 55	30x30	Corner Connection Narrow	8	Ø6.5	Aluminium	54 gr
M 54	45x45	Corner Connection Narrow	10	Ø8.5	Aluminium	59 gr
G 45	45x45 30x30	Corner Connection Narrow Cover	-	-	Plastic	7.5 gr

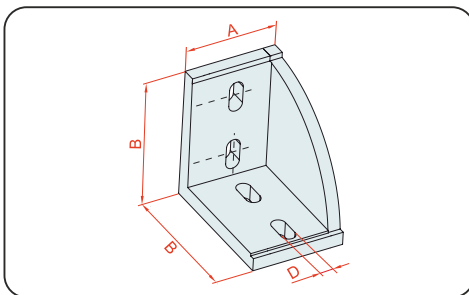

Code	Prof External	Product Name	A	B	D	Malzeme	Weight
M 54/C	30x60	Corner Connection Long	27.2	57	6.5	Aluminium	48 gr
M 54/A	40x80	Corner Connection Long	37.5	78	10.5	Aluminium	114 gr
M 54/U	45x90	Corner Connection Long	42	84.2	9	Aluminium	142 gr
M 54/P	30x60	Corner Connection Long Cover	-	-	-	Plastic	10 gr
M 54/B	40x80	Corner Connection Long Cover	-	-	-	Plastic	10 gr

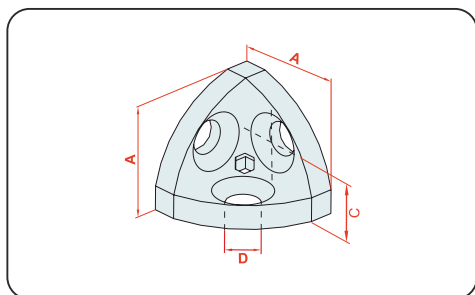

Code	Prof External	Prof External	A	C	D	Material	Weight
M 56/R	20x20	Radius Corner Connection	18.5	10	6.5	Aluminium	12 gr
M 55/R	30x30	Radius Corner Connection	28	15	8.5	Aluminium	42 gr
M 54/R	45x45	Radius Corner Connection	42	22,5	10.5	Aluminium	136 gr
M 96/C	20x20	Radius Corner Connection Cover	20	3	-	Plastic	2 gr
M 96/A	30x30	Radius Corner Connection Cover	30	3	-	Plastic	4 gr
M 96/B	45x45	Radius Corner Connection Cover	45	3	-	Plastic	14 gr
M 87/A	20x20	Square Corner Connection Cover	20	2	-	Plastic	3 gr
M 87/B	30x30	Square Corner Connection Cover	30	3	-	Plastic	8 gr
M 87/C	45x45	Square Corner Connection Cover	45	3	-	Plastic	22 gr

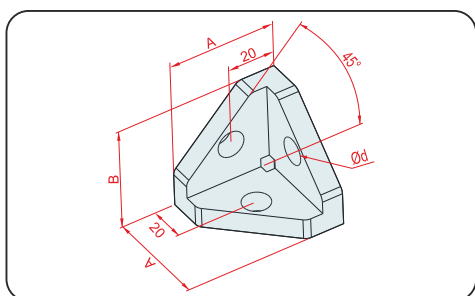

Code	Prof External	Prof External	A	B	D	Material	Weight
M 1/T	40x40 A	Triangle Corner Connection	36	36	Ø8.5	Aluminium	56 gr
M 2/T	40x40 A	Triangle Corner Connection Cover	40	40	-	Plastic	7 gr
M 3/T	40x40	Square Corner Connection Cover	40	40	-	Plastic	13.5 gr

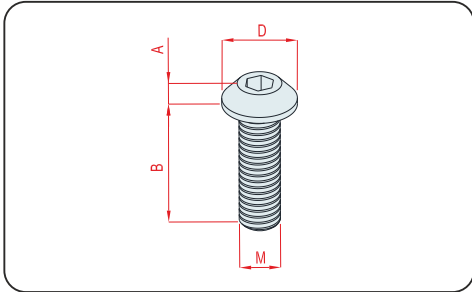

Code		Product Name	M	A	B	ØD	Material	Weight
M 44/C	Slot 6	Head Bolt	M6	3.5	20	10.5	8.8 Steel	4.5 gr
M 44/B	Slot 8	Head Bolt	M8	5.2	25	16	8.8 Steel	13 gr
M 44	Slot 10	Head Bolt	M10	6	30	17.5	8.8 Steel	21 gr

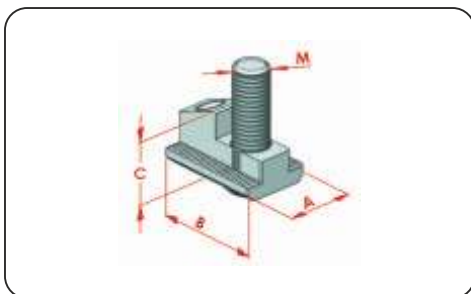

Code		Product Name	M	A	B	C	Material	Weight
M 86/B	Slot 8	Inner Slot Connector	M8	15	26.4	12.5	Steel	15 gr
M 86/J	Slot 10	Inner Slot Connector	M10	19	30	17.5	Steel	27 gr

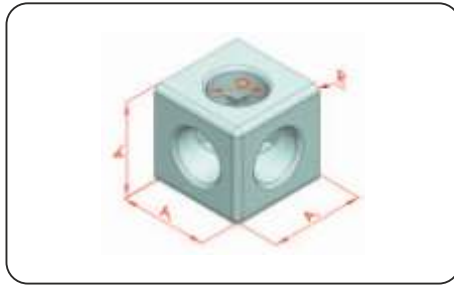

Code	Prof External	Product Name	A	D	R	Material	Weight
M 115	30x30	Three Corner Cube Connector	30	Ø20,5	2	Aluminium	38,5 gr
M 117	40x40 S8	Three Corner Cube Connector	40	Ø26,6	4	Aluminium	94,5 gr
M 117/S10	40x40 S10	Three Corner Cube Connector	40	Ø26,6	4	Aluminium	94,5 gr
M 116	45x45	Three Corner Cube Connector	45	Ø26,6	4	Aluminium	151 gr

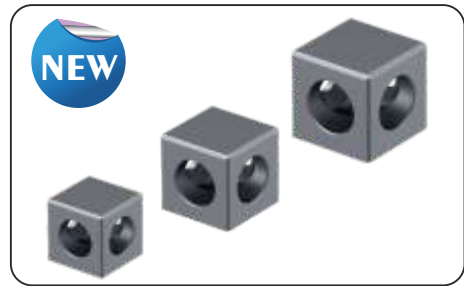
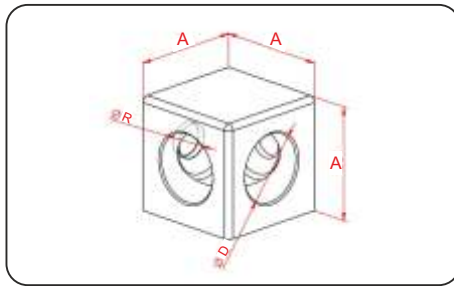
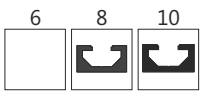

Code	Prof External	Product Name	A	D	R	Material	Weight
M 115/2	30x30	Two Corner Cube Connector	30	Ø18	9	Aluminium	44,26 gr
M 117/2	40x40 S8	Two Corner Cube Connector	40	Ø24	8,5	Aluminium	106,40 gr
M 117/SD	40x40 S10	Two Corner Cube Connector	40	Ø24	12,5	Aluminium	104,88 gr
M 116/2	45x45	Two Corner Cube Connector	45	Ø24	13	Aluminium	168,13 gr

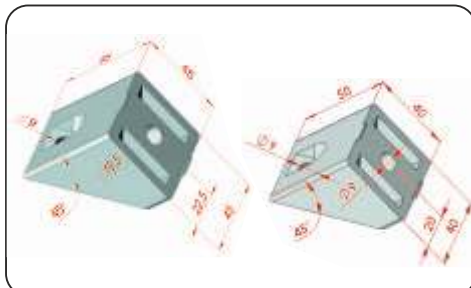

Code	Prof External	Product Name	D	Material	Weight
M 120	40x40	45° Angle Corner Connector	Ø8.5	Aluminium	86 gr
M 121	45x45	45° Angle Corner Connector	Ø10	Aluminium	98 gr

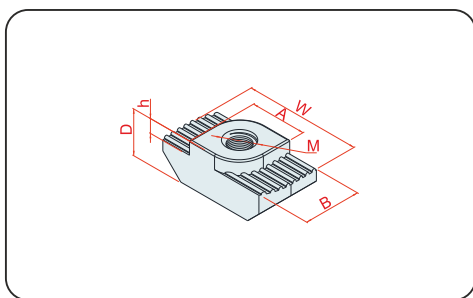

Code		Product Name	M	B	W	D	H	A	Material	Weight
M 47/A	Slot 6	Jagged Nut	M4	5.7	11.4	4.1	1.2	5.6	8.8 Steel	1.2 gr
M 47/S	Slot 6	Jagged Nut	M5	5.7	11.4	4.1	1.2	5.6	8.8 Steel	1 gr
M 42/B	Slot 8	Jagged Nut	M4	7.9	16	6.3	2	7.7	8.8 Steel	3.6 gr
M 42/A	Slot 8	Jagged Nut	M5	7.9	16	6.3	2	7.7	8.8 Steel	3.3 gr
M 42	Slot 8	Jagged Nut	M6	7.9	16	6.3	2	7.7	8.8 Steel	3 gr
M 43/B	Slot 10	Jagged Nut	M4	10	19	8.7	3	9.8	8.8 Steel	7.5 gr
M 43/A	Slot 10	Jagged Nut	M5	10	19	8.7	3	9.8	8.8 Steel	7 gr
M 43	Slot 10	Jagged Nut	M6	10	19	8.7	3	9.8	8.8 Steel	6.5 gr
M 41	Slot 10	Jagged Nut	M8	10	19	8.7	3	9.8	8.8 Steel	5.5 gr
NEW M 42/SS	Slot 8	Jagged Nut Inox	M6	7.9	16	6.3	2	7.7	Stainless Steel	2.7 gr
NEW M 43/SS	Slot 10	Jagged Nut Inox	M6	10	19	8.7	3	9.8	Stainless Steel	5.9 gr
NEW M 41/SS	Slot 10	Jagged Nut Inox	M8	10	19	8.7	3	9.8	Stainless Steel	5 gr

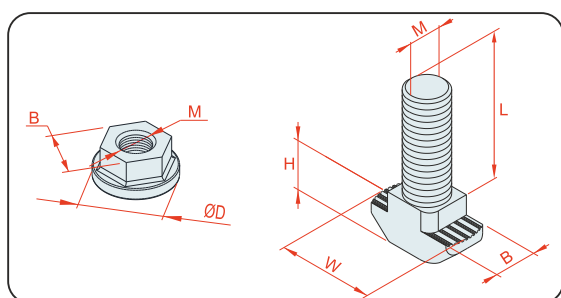

Code		Product Name	D	L	M	H	W	B	Material	Weight
M 40/B	Slot 8	M6x20 Hammer Screw Nut	-	18,5	6	6,8	16,5	7,7	8.8 Steel	7.5 gr
M 40/G	Slot 8	M6x25 Hammer Screw Nut	-	23,5	6	6,8	16,5	7,7	8.8 Steel	8 gr
M 40/C	Slot 10	M8x25 Hammer Screw Nut	-	17	8	9,7	19,5	8,3	8.8 Steel	14 gr
M 40/A	Slot 10	M8x30 Hammer Screw Nut	-	27	8	9,7	19,5	8,3	8.8 Steel	16 gr
M 40/D	Slot 10	M8x40 Hammer Screw Nut	-	37	8	9,7	19,5	8,3	8.8 Steel	18.5 gr
M 40/F	Slot 10	M8x60 Hammer Screw Nut	-	57	8	9,7	19,5	8,3	8.8 Steel	25.5 gr
M 40/E	Slot 8	Round Head Bolt	Ø13	-	6	-	-	9,8	8.8 Steel	3 gr
M 40/I	Slot 10	Round Head Bolt	Ø21	-	8	-	-	12,7	8.8 Steel	9,5 gr

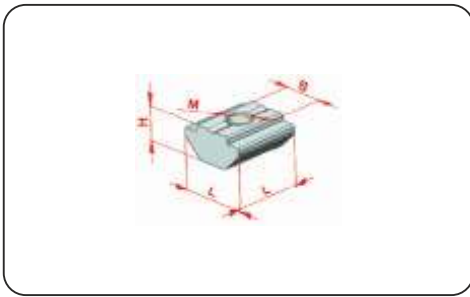

Code		Product Name	M	B	L	H	Material	Weight
M 102 T	Slot 6	Small Nuts	M4	6	10	5	8.8 Steel	2.5 gr
M 102 R	Slot 6	Small Nuts	M5	6	10	5	8.8 Steel	2 gr
M 102 Z	Slot 6	Small Nuts	M6	6	10	5	8.8 Steel	2 gr
M 102 P	Slot 8	Small Nuts	M4	7.8	16	6	8.8 Steel	9 gr
M 102 L	Slot 8	Small Nuts	M5	7.8	16	6	8.8 Steel	8.5 gr
M 102 F	Slot 8	Small Nuts	M6	7.8	16	6	8.8 Steel	8.5 gr
M 102 E	Slot 8	Small Nuts	M8	7.8	16	6	8.8 Steel	7.5 gr
M 102 D	Slot 10	Small Nuts	M4	10.1	20	10,5	8.8 Steel	21.5 gr
M 102 C	Slot 10	Small Nuts	M5	10.1	20	10,5	8.8 Steel	20.5 gr
M 102 B	Slot 10	Small Nuts	M6	10.1	20	10,5	8.8 Steel	19.5 gr
M 102 A	Slot 10	Small Nuts	M8	10.1	20	10,5	8.8 Steel	18.5 gr

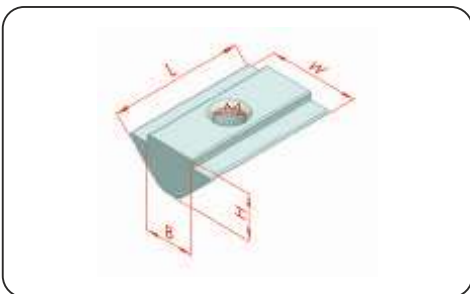
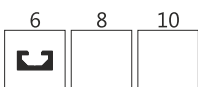

Code		Product Name	M	B	W	L	H	Material	Weight
M 105	Slot 6	Modular T Slot Nut	M4	6.1	11	16	5.5	8.8 Steel	4 gr
M 105/A	Slot 6	Modular T Slot Nut	M5	6.1	11	16	5.5	8.8 Steel	4 gr
M 105/B	Slot 6	Modular T Slot Nut	M6	6.1	11	16	5.5	8.8 Steel	3 gr

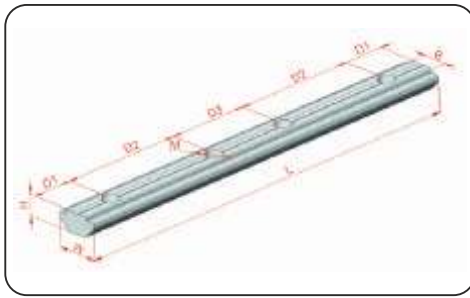

Code		Product Name	M	B	W	L	D3	D2	D1	H	Material	Weight
M 107 A	Slot 6	Long Nuts	M5	6	10	100	20	30	10	5	8.8 Steel	29 gr
M 107 B	Slot 8	Long Nuts	M6	7,8	16	120	35	35	7,5	6	8.8 Steel	77.5 gr
M 107 C	Slot 10	Long Nuts	M8	10	20	140	30	40	15	10,5	8.8 Steel	150 gr

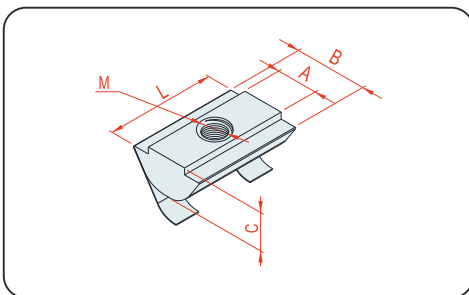

Code		Product Name	M	A	B	C	L	Material	Weight
M 45/K	Slot 8	Spring Slot Nut	M4	8	13	5.5	16	8.8 Steel	3.8 gr
M 45/C	Slot 8	Spring Slot Nut	M5	8	13	5.5	16	8.8 Steel	4 gr
M 45/B	Slot 8	Spring Slot Nut	M6	8	13	5.5	16	8.8 Steel	5.5 gr
M 45/D	Slot 8	Spring Slot Nut	M8	8	13	5.5	16	8.8 Steel	4.5 gr
M 45/H	Slot 10	Spring Slot Nut	M4	10	15	7.5	20	8.8 Steel	12 gr
M 45/F	Slot 10	Spring Slot Nut	M5	10	15	7.5	20	8.8 Steel	11.5 gr
M 45/A	Slot 10	Spring Slot Nut	M6	10	15	7.5	20	8.8 Steel	11.5 gr
M 45	Slot 10	Spring Slot Nut	M8	10	15	7.5	20	8.8 Steel	10.5 gr

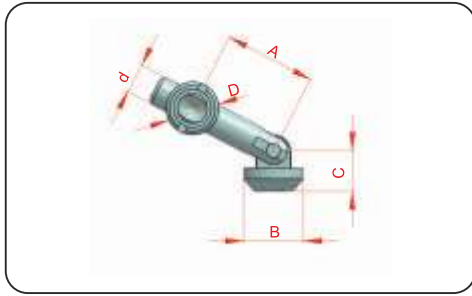
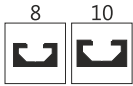

Code		Product Name	A	B	C	D	d	Material	Weight
M 85/G	Slot 8	Angled Puller Type Connection	12.5	15	9	12	6.8	Steel	22.5 gr
M 85/C	Slot 10	Angled Puller Type Connection	26	17	11.5	15	8.5	Steel	53 gr

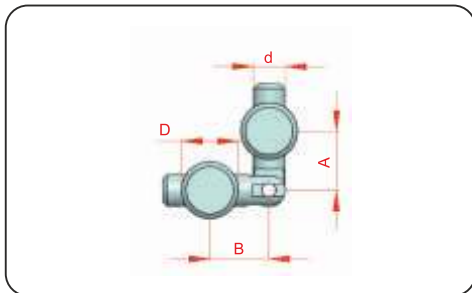
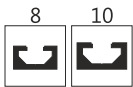

Code		Product Name	A	D	d	Material	Weight
M 85/F	Slot 8	Puller Type Connection With Joint	12.5	12	6.8	Steel	32.5 gr
M 85/B	Slot 10	Puller Type Connection With Joint	26	15	8.5	Steel	84 gr

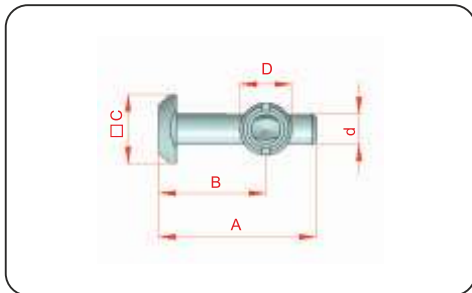
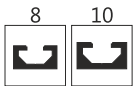

Code		Product Name	A	B	C	D	d	Material	Weight
M 85/A	Slot 8	Plain Puller Type Connection	29	21	16	12	6.8	Steel	24.5 gr
M 85	Slot 10	Plain Puller Type Connection	45.5	31	20	15	8.5	Steel	54 gr

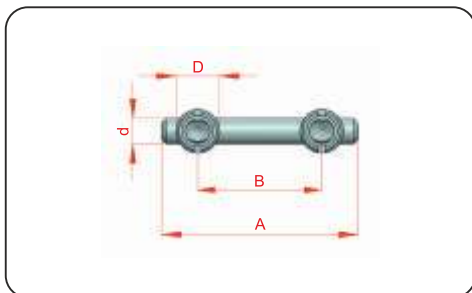
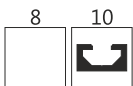

Code		Product Name	A	B	D	d	Material	Weight
M 85/D	Slot 10	Head Puller Type Connection	68	48	15	8.8	Steel	80.5 gr

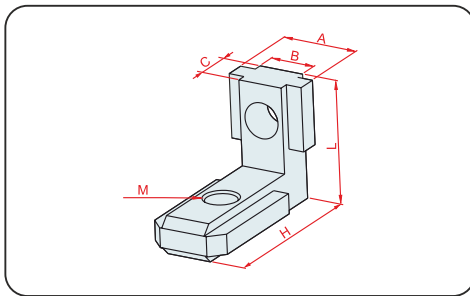

Code		Product Name	M	A	B	C	L	H	Material	Weight
M 106	Slot 6	Hidden Corner Connections	M5	9	6	4.8	13.5	20	Alloys	6 gr
M 106 A	Slot 8	Hidden Corner Connections	M6	13	8	6.7	21	30	Alloys	18.5 gr
M 106 B	Slot 10	Hidden Corner Connections	M8	17	10	8.4	27	40	Alloys	41 gr

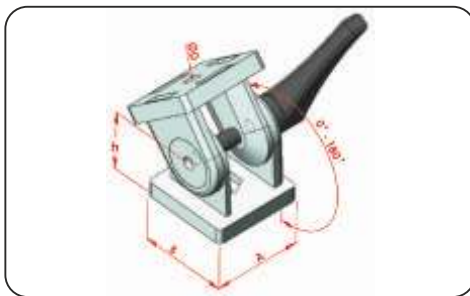

Code	Product Name	A	B	D	H	Material	Weight
M 36	30x30 Moving Joint	30	30	Ø8.5	22.5	Alloys	154 gr
M 37/A	40x40 Moving Joint	40	40	Ø8.5	30	Alloys	372 gr
M 37	45x45 Moving Joint	45	45	Ø10.5	30	Alloys	342 gr

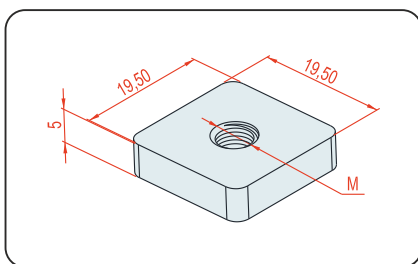

**ΔΕΝ ΜΠΑΙΝΟΥΝ ΣΕ
ΟΛΑ ΤΑ ΠΡΟΦΙΛ
SLOT 10**



Code		Product Name	M	E	Material	Weight
M 46/F	Slot 10	Square Nut	M4	5	Steel	13.5 gr
M 46/H	Slot 10	Square Nut	M5	5	Steel	13 gr
M 46/E	Slot 10	Square Nut	M6	5	Steel	13 gr
M 46/I	Slot 10	Square Nut	M8	5	Steel	12 gr
M 46/D	Slot 10	Square Nut	M10	5	Steel	10.5 gr

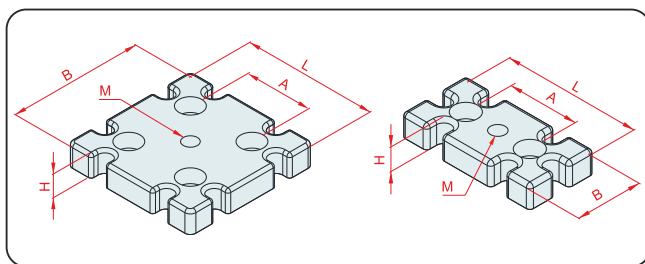

Code	Prof External	Product Name	M	A	L	B	H	Material	Weight
M 81/C	30x60	Levelling Feet Plate	M6	30	60	30	16	Aluminium	45 gr
M 81/B	40x80	Levelling Feet Plate	M10	40	80	40	15	Aluminium	76 gr
M 81/A	45x90	Levelling Feet Plate	M12	45	90	45	15	Aluminium	100 gr
M 81/F	60x60	Levelling Feet Plate	M12	30	60	60	15	Aluminium	119 gr
M 81/G	80x80	Levelling Feet Plate	M12	40	80	80	15	Aluminium	217.5 gr
M 81	90x90	Levelling Feet Plate	M16	45	90	90	15	Aluminium	195 gr

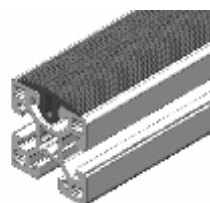
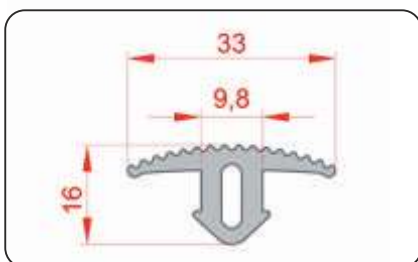
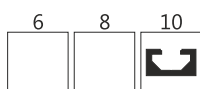

Code	Product Name
PE 33	Προστατευτικό ελαστικό προφίλ 40x40 - 45x45 ενιαία επιφάνεια

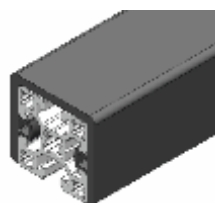
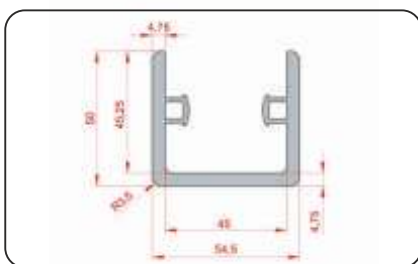

Code	Product Name
PE 54	Προφίλ προστατευτικού ελαστικού 45x45 Τρεις πλευρές

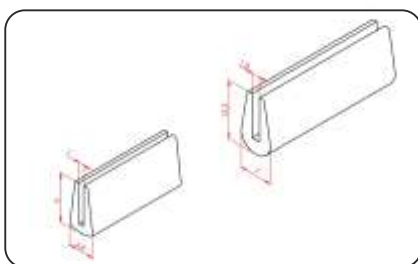

Code	Product Name
SW 15	Προφίλ προστατευτικού λαμαρίνας 1,00mm έως 1,50mm
SW 25	Προφίλ προστατευτικού λαμαρίνας 2,00mm έως 2,50mm

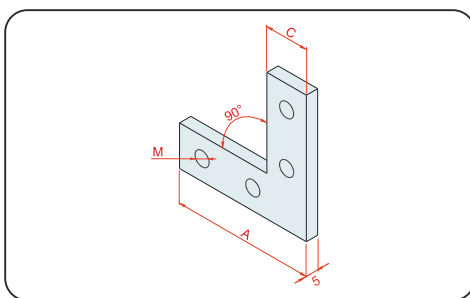

Code	Prof External	Product Name	A	C	M	Material	Weight
M 034/A	20x20	90° Connection Part	9.3	45	M4	Steel	17.5 gr
M 032/A	25x25	90° Connection Part	12.3	45	M5	Steel	30 gr
M 034	30x30	90° Connection Part	14	45	M6	Steel	33.5 gr
M 032	40x40	90° Connection Part	16.5	61.5	M8	Steel	52.3 gr
M 035/T	45x45	90° Connection Part	19.5	55	M8	Steel	71 gr

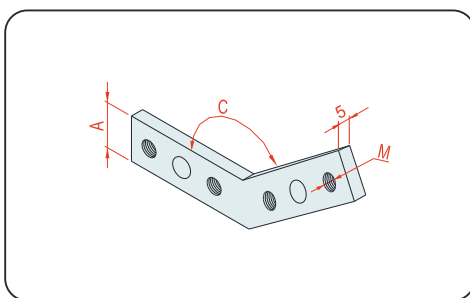

Code	Prof External	Product Name	A	C	M	Material	Weight
M 35/G	20x20	120° Connection Part	9.3	41	M4	Steel	17 gr
M 35/E	25x25	120° Connection Part	12.3	40	M5	Steel	27 gr
M 35	30x30	120° Connection Part	14	54	M6	Steel	43 gr
M 35/X	40x40	120° Connection Part	16.5	54	M8	Steel	49 gr
M 33	45x45	120° Connection Part	19.5	61	M8	Steel	92 gr

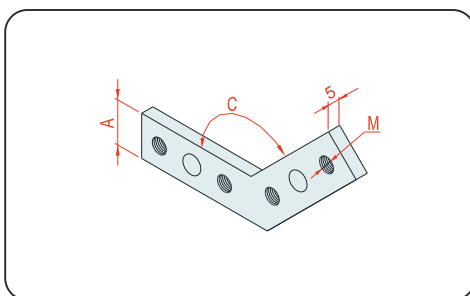
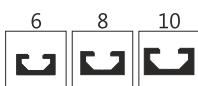

Code	Prof External	Product Name	A	C	M	Material	Weight
M 34/D	20x20	135° Connection Part	9.3	38.5	M4	Steel	16 gr
M 32/B	25x25	135° Connection Part	12.3	39.5	M5	Steel	27 gr
M 35/A	30x30	135° Connection Part	14	51	M6	Steel	41 gr
M 33/X	40x40	135° Connection Part	16.5	52	M6	Steel	48 gr
M 33/A	45x45	135° Connection Part	19.5	63	M8	Steel	88 gr

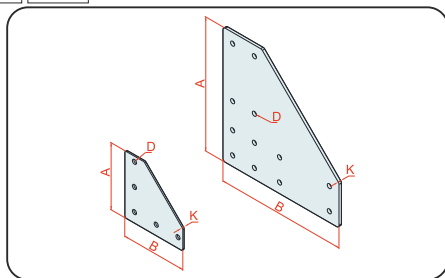
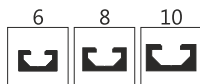

Code	Prof External	Product Name	A	B	ØD	K	Material	Weight
M 051	20x25	2 Way Connection Plate	75	75	5	3	Steel	96.5 gr
M 72/A	30x30	2 Way Connection Plate	80	80	6.5	3	Steel	119 gr
M 56/L	40x40	2 Way Connection Plate	110	110	6.5	3	Steel	218 gr
M 56	45x45	2 Way Connection Plate	120	120	8.5	3	Steel	256 gr
M 76	45x90	2 Way Connection Plate	180	180	8.5	4	Steel	850 gr
M 76/L	80x80	2 Way Connection Plate	200	200	6.5	4	Steel	990 gr
M 66	90x90	2 Way Connection Plate	240	240	8.5	5	Steel	1.782 gr

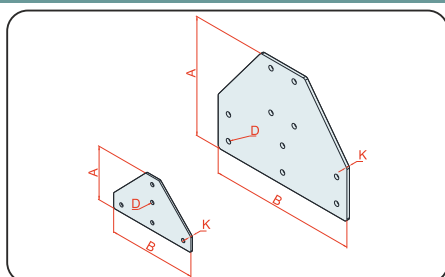

Code	Prof External	Product Name	A	B	ØD	K	Material	Weight
M 051/A	20x25	3 Way Connection Plate	75	86	5	3	Steel	109.5 gr
M 72/B	30x30	3 Way Connection Plate	90	150	6.5	3	Steel	221.5 gr
M 72/L	40x40	3 Way Connection Plate	110	150	6.5	3	Steel	280 gr
M 56/A	45x45	3 Way Connection Plate	120	160	8.5	3	Steel	322 gr
M 76/A	45x90	3 Way Connection Plate	170	130	8.5	4	Steel	622 gr
M 66/L	80x80	3 Way Connection Plate	160	220	6.5	4	Steel	900 gr
M 66/A	90x90	3 Way Connection Plate	200	250	8.5	5	Steel	1.581 gr

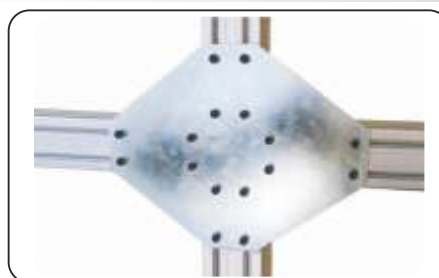
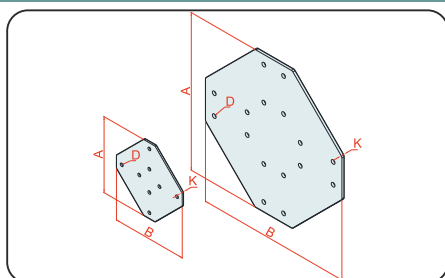

Code	Prof External	Product Name	A	B	ØD	K	Material	Weight
M 051/B	20x25	4 Way Connection Plate	130	130	5	3	Steel	248 gr
M 72/C	30x30	4 Way Connection Plate	150	150	6.5	3	Steel	334 gr
M 56/B	45x45	4 Way Connection Plate	180	180	8.5	4	Steel	689 gr
M 66/J	80x80	4 Way Connection Plate	200	200	6.5	4	Steel	1180 gr
M 66/B	90x90	4 Way Connection Plate	311	311	8.5	5	Steel	2.739 gr

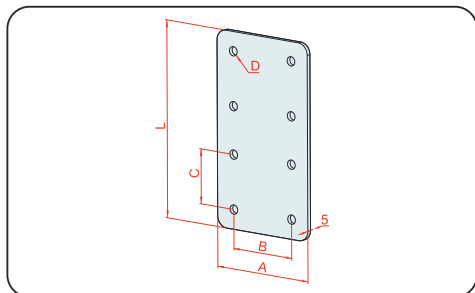
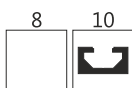

Code	Product Name	A	B	C	ØD	L	Material	Weight
M 148	Plain Additional Connection Plate	85	45	45	8.5	175	Steel	564 gr

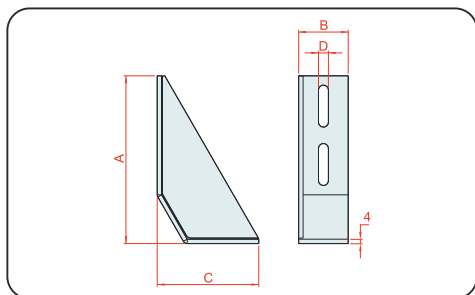
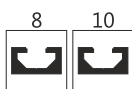

Code	Product Name	A	B	C	D	Material	Weight
M 57	Foot Fixing Bracket	153	45	92	9	Steel	488.5 gr

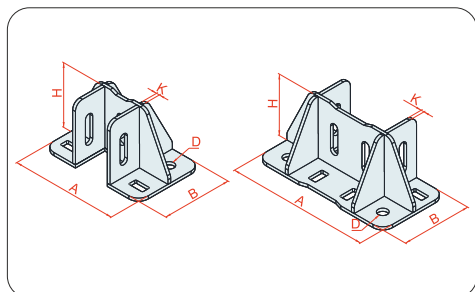
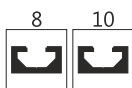

Code	Prof External	Product Name	A	B	D	H	K	Material	Weight
M 152	45x45	Based Foot Connection Elements	135	89	13	80	4	Steel	862 gr
M 153	45x90	Based Foot Connection Elements	180	89	13	80	4	Steel	972 gr
M 154	40x40	Based Foot Connection Elements	130	89	13	66	4	Steel	740 gr
M 155	40x80	Based Foot Connection Elements	170	89	13	66	4	Steel	860 gr

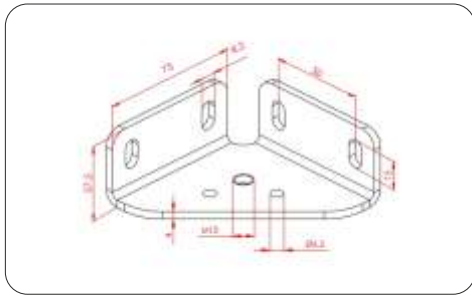
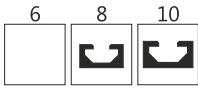

Code	Product Name	Material	Weight
M 39	Corner foot connection piece	Steel	301 gr

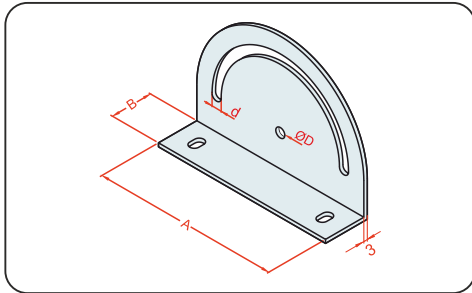

Code	Slot	Product Name	A	B	d	Ø D	Material	Weight
M 98	Slot 8	Shelf Adjusting Plate	120	30	6.5	6.5	Steel	247.5 gr
M 98/K	Slot 10	Shelf Adjusting Plate	120	38	8.5	8.5	Steel	242.5 gr

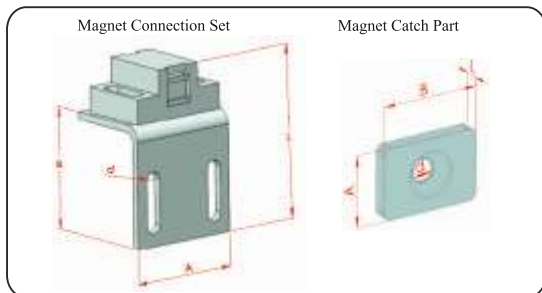

Code	Slot	Product Name	A	B	L	Ød	Material	Weight
M 069/D	Slot 6	Magnet Connection Set	45	20	40	5.5	Steel Plate +plastic	88.5 gr
M 69/B	Slot 8	Magnet Connection Set	45	35	55	6.5	Steel Plate +plastic	104 gr
M 069	Slot 10	Magnet Connection Set	45	47	67	6.5	Steel Plate +plastic	113 gr

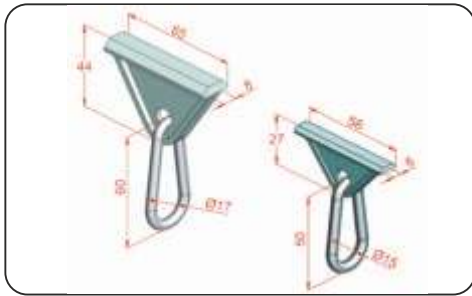

Code	Product Name	Material	Weight
M 72/20	Hanger 20.25	Plastic+ Steel	18 gr
M 73	Hanger 30.45	Plastic+ Steel	36 gr

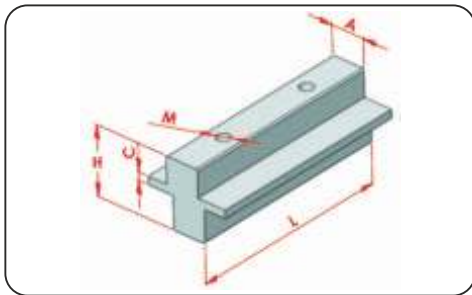

Code	Slot	Product Name	A	C	H	L	M	Material	Weight
M 75/B	Slot 8	Slide Rail	8	2	18.7	53	M4	Derlin	8.5 gr
M 75/A	Slot 10	Slide Rail	10	2.5	20.3	60	M4	Derlin	13 gr

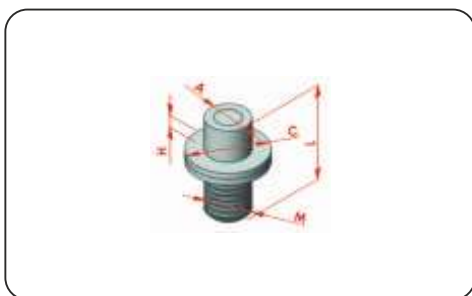

Code	Slot	Product Name	A	C	H	L	M	Material	Weight
M 75/D	Slot 8	Accordion Slide Pin	8	15	3	24	M8	Steel+Derlin	7 gr
M 75/C	Slot 10	Accordion Slide Pin	10	18	3	27	M10	Steel+Derlin	12.5 gr

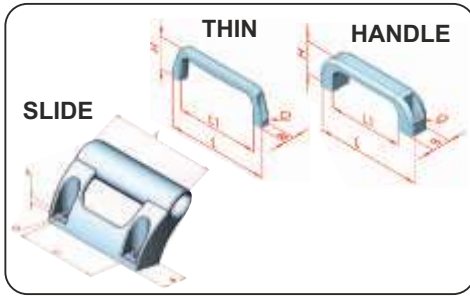

Code	Product Name	H	L	L1	B	D	Material	Weight
M 67	Plastic Handle	40.5	131.5	91.5	25	Ø8.4	Plastic	44.5 gr
M 68	Plastic Handle Thin	40.5	130	104	12	Ø5	Plastic	25 gr
M 69	Plastic Slide-in Handle	6	134	100	27	Ø8.5	Plastic	110 gr

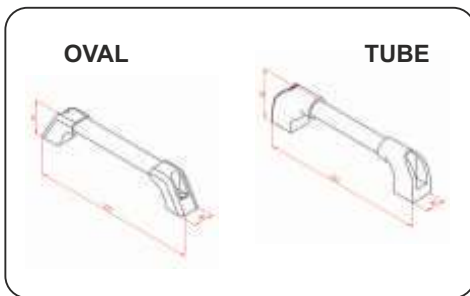

Code	Product Name	H	L	L1	B	D	Material	Weight
M 67 AO	Aluminium Tube Handle Oval	47	233	-	38	-	Aluminium & PVC	88 gr
M 68 AO	Aluminium Tube Handle Oval	43	230	-	34	-	Aluminium & PVC	70 gr
M 69 AT	Aluminium Tube Handle	56	232	-	30	-	Aluminium & PVC	81 gr
M 78	Aluminium Tube Handle	68	236	-	36	-	Aluminium & PVC	103 gr

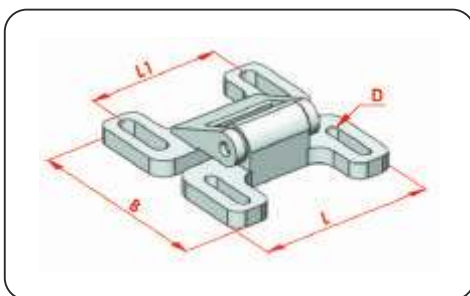

Code	Product Name	Prof External	L	L1	B	D	Material	Weight
M 69/C	Ball Catch	20 - 25 - 30	53	40	55	Ø5	Plastic	25 gr
M 69/F	Ball Catch	35 - 40 - 45	74	57	77	Ø5.5	Plastic	40 gr



Code	Product Name	M	H	h1	L	Material	Weight
M 73/A	Adjustable Handle	M6	72	30	78	Plastic	41 gr
M 73/B	Adjustable Handle	M8	92	50	78	Plastic	52 gr
M 73/C	Adjustable Handle	M10	102	60	78	Plastic	65 gr

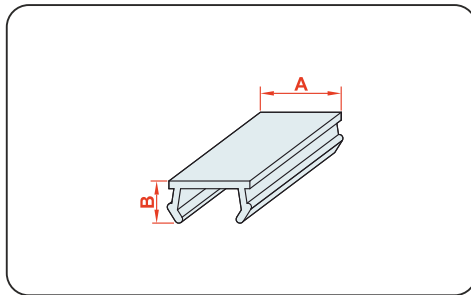

Code	Icon	Product Name	Colour	A	B	Material
M 79	Slot 6	Slot Seal	●	7.3	3.8	Plastic
M 49	Slot 8	Slot Seal	●	8.9	4.3	Plastic
M 59	Slot 10	Slot Seal	●	11.7	8.1	Plastic
ΚΑΤΟΠΙΝ ΠΑΡΑΓΓΕΛΙΑΣ	Slot 6	Slot Seal Colorful	● ●	7.3	3.8	Plastic
ΚΑΤΟΠΙΝ ΠΑΡΑΓΓΕΛΙΑΣ	Slot 8	Slot Seal Colorful	● ● ●	8.9	4.3	Plastic
ΚΑΤΟΠΙΝ ΠΑΡΑΓΓΕΛΙΑΣ	Slot 10	Slot Seal Colorful	● ● ●	11.7	8.1	Plastic

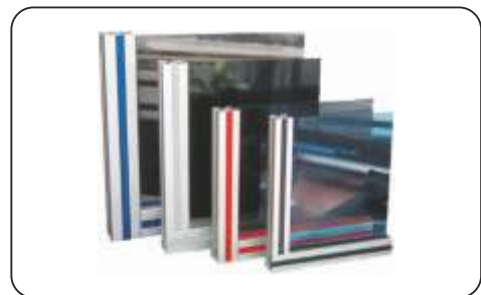
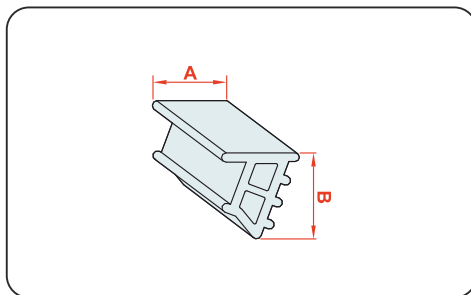

Code	Icon	Product Name	Colour	A	B	Material
M 70	Slot 6	Glass Seal	●	7	7	Plastic
M 72	Slot 8	Glass Seal	●	8.5	11.3	Plastic
M 71	Slot 10	Glass Seal	●	11	12.1	Plastic

Πόμολα μαργαρίτα από PF Duroplast με θηλυκό πάσο

Ανθεκτικά σε έλαια, λίπη, καύσιμα και διαλύτες.

Κωδικός	Διάμετρος	Πάσο	Κωδικός	Διάμετρος	Πάσο
01PB2A PB2 M4	20mm	M4	01PB4F PB4 M12	40mm	M12
01PB2B PB2 M5	20mm	M5	01PB5D PB5 M8	50mm	M8
01PB2C PB2 M6	20mm	M6	01PB5E PB5 M10	50mm	M10
01PB3B PB3 M5	30mm	M5	01PB5F PB5 M12	50mm	M12
01PB3C PB3 M6	30mm	M6	01PB6E PB6 M10	60mm	M10
01PB3D PB3 M8	30mm	M8	01PB6F PB6 M12	60mm	M12
01PB4C PB4 M6	40mm	M5	01PB7E PB7 M10	70mm	M10
01PB4D PB4 M8	40mm	M8	01PB7F PB7 M12	70mm	M12
01PB4E PB4 M10	40mm	M10	01PB7N PB7 M14	70mm	M14



THENAR
quality industrial components

Πόμολα μαργαρίτα από PF Duroplast με αρσενικό πάσο

Ανθεκτικά σε έλαια, λίπη, καύσιμα και διαλύτες.

Κωδικός	Τύπος	Πάσο	Κωδικός	Τύπος	Πάσο
01PF2B20 PF2 M5X20	20mm	M5X20mm	01PF5E25 PF5 M10X25	50mm	M10X25mm
01PF2B30 PF2 M5X30	30mm	M5X30mm	01PF5E30 PF5 M10X30	50mm	M10X30mm
01PF3C20 PF3 M6X20	30mm	M6X20mm	01PF6E50 PF6 M10X50	50mm	M10X40mm
01PF3C30 PF3 M6X30	30mm	M6X30mm	01PF6F35 PF6 M12X35	50mm	M12X35mm
01PF3P25 PF3 M8X25	30mm	M8X25mm	01PF6D25 PF6 M8X25	60mm	M8X25mm
01PF4C25 PF4 M6X25	40mm	M6X25mm	01PF6D40 PF6 M8X40	60mm	M8X40mm
01PF4C40 PF4 M6X40	40mm	M6X40mm	01PF6E30 PF6 M10X30	60mm	M10X30mm
01PF4D20 PF4 M8X20	40mm	M8X20mm	01PF6E70 PF6 M10X70	60mm	M10X70mm
01PF4D25 PF4 M8X25	40mm	M8X25mm			
01PF4D40 PF4 M8X40	40mm	M8X40mm			
01PF4D50 PF4 M8X50	40mm	M8X50mm			
01PF4E30 PF4 M10X30	40mm	M10X30mm			
01PF5E40 PF5 M10X40	40mm	M10X40mm			
01PF6F45 PF6 M12X45	45mm	M12X45mm			
01PF5D20 PF4 M8X20	50mm	M8X20mm			
01PF5D35 PF5 M8X35	50mm	M8X35mm			



THENAR
quality industrial components

Πόμολα μαργαρίτα από PF Duroplast με αρσενικό πάσο **INOX**

Ανθεκτικά σε έλαια, λίπη, καύσιμα και διαλύτες.

Κωδικός	Τύπος	Πάσο
01PF2B20X PF2 M5X20	20mm	M5X20mm
01PF2B30X PF2 M5X30	20mm	M5X30mm
01PF2B40X PF2 M5X40	20mm	M5X40mm
01PF2C20X PF2 M6X20	20mm	M6X20mm
01PF2C30X PF2 M6X30	20mm	M6X30mm
01PF2C40X PF2 M6X40	20mm	M6X40mm
01PF3D15X PF3 M8X15	30mm	M8X15mm
01PF3D25X PF3 M8X25	30mm	M8X25mm
01PF4C25X PF4 M6X25	40mm	M6X25mm
01PF4D40X PF4 M8X40	40mm	M8X40mm



THENAR
quality industrial components

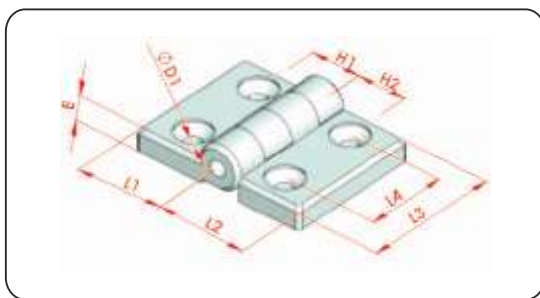

Code	Prof External	Product Name	E	H1	H2	L1	L2	L3	L4	D1	Material	Weight
M 65/K	20x20	Hinge (Thin Series)	5	10.25	10.25	18.35	18.35	35	19	6	PA6 Black	8.5 gr
M 65/G	25x25	Hinge (Thin Series)	5	12.75	12.75	23.35	23.35	35	19	6	Pa6 Black	11 gr
M 65/H	20x30	Hinge (Thin Series)	5	10.25	15.25	18.35	23.35	35	19	6	Pa6 Black	9.5 gr
M 65/A	30x30	Hinge	8	15	15	25	25	50	30	6.5	Pa6 Black	29.5 gr
M 65/B	35x35	Hinge	8	17.5	17.5	32	32	50	30	6.5	Pa6 Black	34 gr
M 65/D	45x30	Hinge	8	22.75	15	32	25	50	30	6.5	Pa6 Black	31 gr
M 65/J	35x45	Hinge	8	22.75	17.5	32	32	50	30	6.5	Pa6 Black	33 gr
M 65/C	45x45	Hinge	8	22.75	22.75	32	32	50	30	6.5	Pa6 Black	34 gr

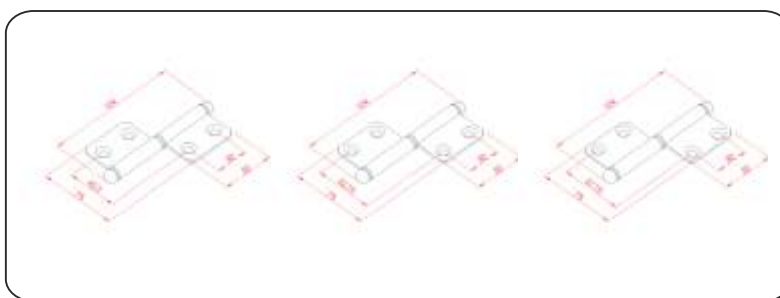

Code	Prof External	Product Name	Material	Weight
ML 30	30x30	30x30 Leaf Hinge	Aluminium	8.5 gr
ML 40	40x40	40x40 Leaf Hinge	Aluminium	11 gr
ML 45	45x45	45x45 Leaf Hinge	Aluminium	9.5 gr

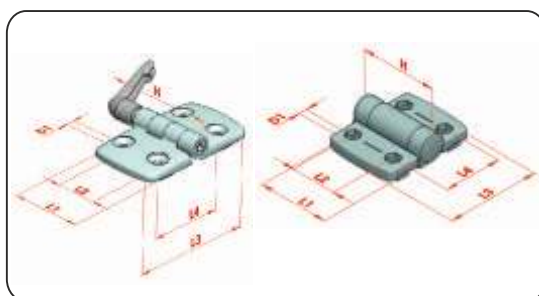

Code	Prof External	Product Name	H	L1	L2	L3	L4	D1	Material	Weight
M 92/A	25x25	Hinges With Lock	72	48	28	52	30	6,6	Pa6 Black	46 gr
M 92/B	30x30	Hinges With Lock	72	48	28	59	35	6,9	Pa6 Black	48 gr
M 92/C	45x45	Hinges With Lock	72	48	28	87	50	6,6	Pa6 Black	60,5 gr
M 92/D	45x45	Hinge Cover	62,2	56	36	73	45,5	6,6	Pa6 Black	41 gr

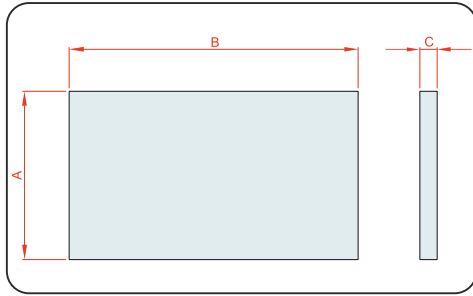

Code	Product Name	A	B	C	Material	Weight
	Plexiglass 3 mm	2050	3050	3	Plexiglass	3,57 kg/m ²
	Plexiglass 4 mm	2050	3050	4	Plexiglass	4,76 kg/m ²
	Plexiglass 5 mm	2050	3050	5	Plexiglass	5,95 kg/m ²
	Plexiglass 6 mm	2050	3050	6	Plexiglass	7,14 kg/m ²
	Plexiglass 8 mm	2050	3050	8	Plexiglass	9,52 kg/m ²
	Plexiglass 10 mm	2050	3050	10	Plexiglass	11,90 kg/m ²

ΜΠΟΡΟΥΝ ΝΑ ΚΟΠΟΥΝ
ΣΤΙΣ ΕΠΙΘΥΜΗΤΕΣ
ΔΙΑΣΤΑΣΕΙΣ

ΔΙΑΤΙΘΟΝΤΑΙ ΣΕ
ΔΙΑΦΟΡΑ ΧΡΩΜΑΤΑ

ΤΙΜΗ ΚΑΤΟΠΙΝ
ΣΥΝΝΕΝΟΗΣΗΣ

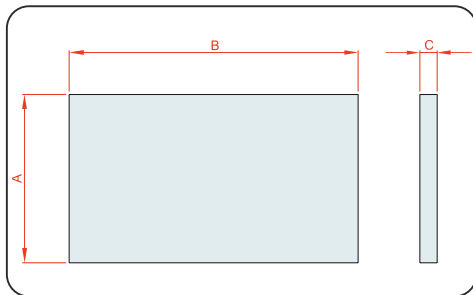

Code	Product Name	A	B	C	Material	Weight
	Πολυκαρβονικό 4 mm	2100	6000	4	Πολυκαρβονικό	0,80 kg/m ²
	Πολυκαρβονικό 6 mm	2100	6000	6	Πολυκαρβονικό	1,30 kg/m ²
	Πολυκαρβονικό 8 mm	2100	6000	8	Πολυκαρβονικό	1,50 kg/m ²
	Πολυκαρβονικό 10 mm	2100	6000	10	Πολυκαρβονικό	1,70 kg/m ²
	Πολυκαρβονικό 16 mm	2100	6000	16	Πολυκαρβονικό	2,55 kg/m ²
	Πολυκαρβονικό 20 mm	2100	6000	20	Πολυκαρβονικό	3,10 kg/m ²

ΜΠΟΡΟΥΝ ΝΑ ΚΟΠΟΥΝ
ΣΤΙΣ ΕΠΙΘΥΜΗΤΕΣ
ΔΙΑΣΤΑΣΕΙΣ

ΔΙΑΤΙΘΟΝΤΑΙ ΣΕ
ΔΙΑΦΟΡΑ ΧΡΩΜΑΤΑ

ΤΙΜΗ ΚΑΤΟΠΙΝ
ΣΥΝΝΕΝΟΗΣΗΣ

Code	Product Name	A	B	C	Material	Weight
	Συμπ. Πολυκαρβονικό 3 mm	2050	3050 6100	3	Πολυκαρβονικό	3,600 kg/m ²
	Συμπ. Πολυκαρβονικό 4 mm	2050	3050 6100	4	Πολυκαρβονικό	4,800 kg/m ²
	Συμπ. Πολυκαρβονικό 5 mm	2050	3050 6100	5	Πολυκαρβονικό	6,00 kg/m ²
	Συμπ. Πολυκαρβονικό 6 mm	2050	3050 6100	6	Πολυκαρβονικό	7,200 kg/m ²
	Συμπ. Πολυκαρβονικό 8 mm	2050	6100	8	Πολυκαρβονικό	9,600 kg/m ²
	Συμπ. Πολυκαρβονικό 10 mm	2050	6100	10	Πολυκαρβονικό	12,00 kg/m ²

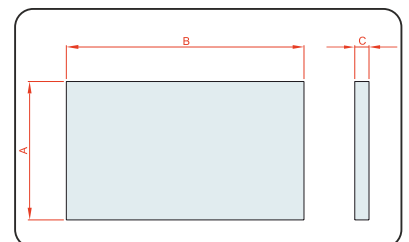

ΜΠΟΡΟΥΝ ΝΑ ΚΟΠΟΥΝ
ΣΤΙΣ ΕΠΙΘΥΜΗΤΕΣ
ΔΙΑΣΤΑΣΕΙΣ

ΔΙΑΤΙΘΟΝΤΑΙ ΣΕ
ΔΙΑΦΟΡΑ ΧΡΩΜΑΤΑ

ΤΙΜΗ ΚΑΤΟΠΙΝ
ΣΥΝΝΕΝΟΗΣΗΣ

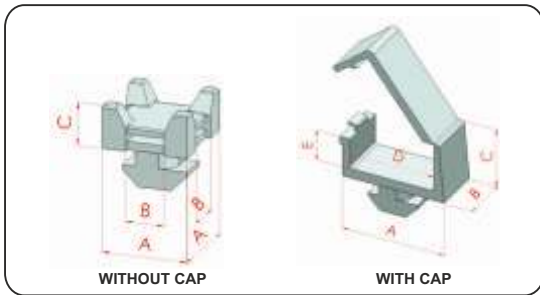
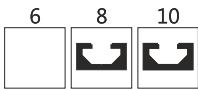

Code	Product Name	A	B	C	D	E	Material	Weight
M 82	Cable Holder Without Cap	22	10	22.3	-	-	Plastic	4.24 gr
NEW M 82/8	Cable Holder Without Cap	22	8	17.2	-	-	Plastic	3.55 gr
M 83	Cable Holder With Cap	34	16	20	30	10	Plastic	5.74 gr
NEW M 83/8	Cable Holder With Cap	28	15	20	24	10	Plastic	4.86 gr

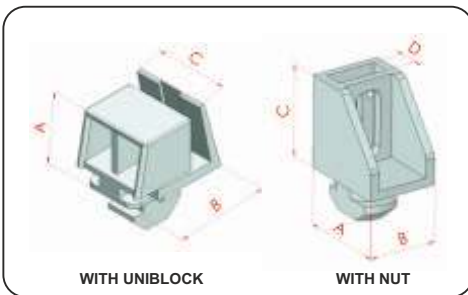

Code	Product Name	A	B	C	D	Material	Weight
M 109	Plexi Holder With Nut	25	18	25	5,5	Plastic	5.74 gr
NEW M 109/S8	Plexi Holder With Nut	23,5	18	25	5,5	Plastic	4.86 gr
M 109/A	Plexi Holder With Uniblock	20,8	29	22,2	-	Plastic	7,46 gr

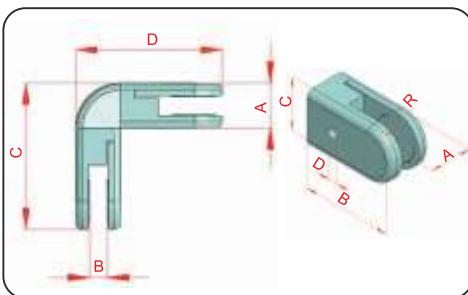

Code	Product Name	A	B	C	D	R	Material	Weight
M 120	Plexi Holder Metal Single	20	32,5	25	Ø4,2	12,5	Aluminium	25 gr
M 120/A	Metal Plexi Holder Dual	20	8	65	65	-	Aluminium	82 gr

Slot Sliding Wheel

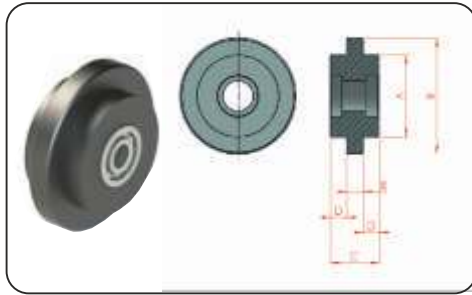

Code		Product Name	A	B	C	D	E	Material	Weight
M 88/B	Slot 8	Slot Sliding Wheel	33.5	47	19.3	5.8	7.8	Black Polyethylene	47 gr
M 88/A	Slot 10	Slot Sliding Wheel	68.5	48	29	9.5	9.5	Black Polyethylene	90 gr
M 88/X	Slot 10	Sliding Wheel set 40x40	40	40	40			Aluminium	116 gr
M 88/Y	Slot 10	Sliding Wheel set 45x45	45	45	45			Aluminium	170 gr
M 88/J	Slot 10	Sliding Wheel set 30x30	30	30	30			Aluminium	80 gr

Safety Lock

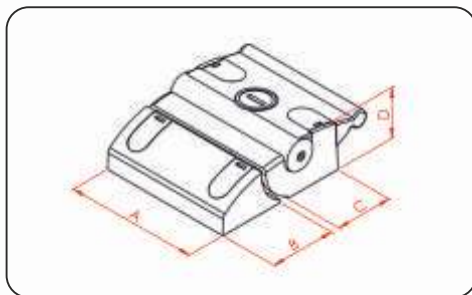

Code	Product Name	A	B	C	D	Material	Weight
M 92	Safety Lock	80	40	35	31	Aluminium	243 gr

Safety Fence Connector

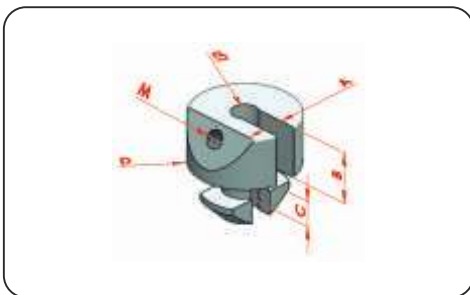

Code	Product Name	A	B	C	D	d1	M	Material	Weight
M 77	Safety fence Connection Part	5	12	6	24	5	M5	Aluminium	13.5 gr

Parallel Profile Connection Kit

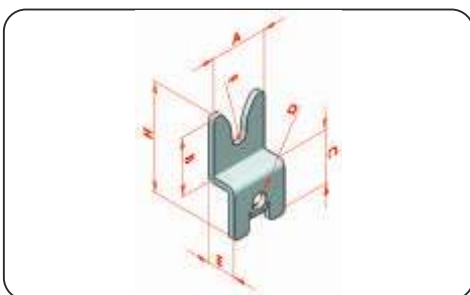

Code	Product Name	A	B	C	ØD	E	F	H	Material	Weight
M 135	Parallel Profile Connection Kit	30	30	27	8,5	15	8,5	57	Steel	38.5 gr

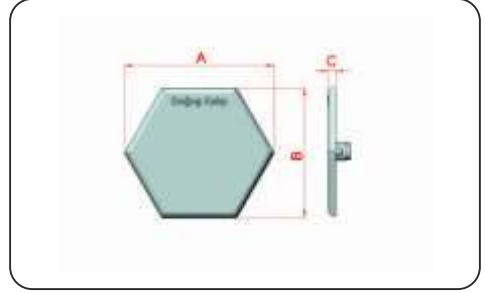
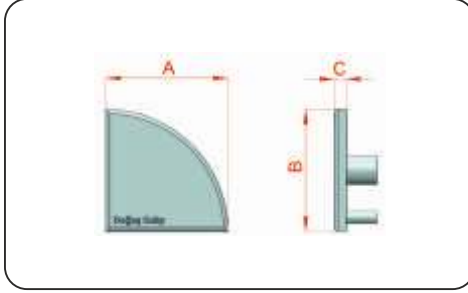
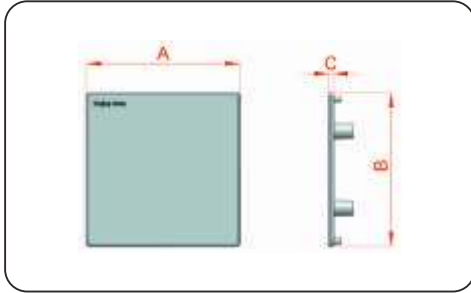
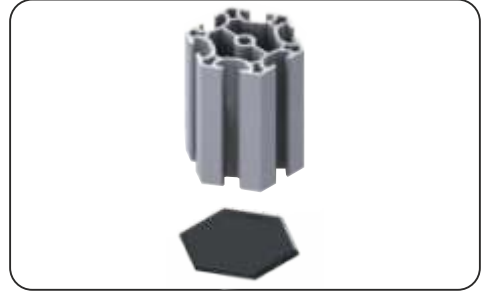
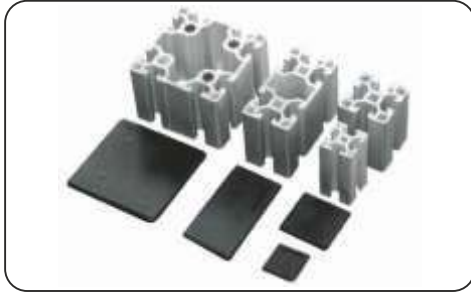

Code	Product Name	A	B	C	Color	Material	Weight
M 58/P	20x20 Profile Cover	20	20	2	●	Plastic	1 gr
M 58/B	20x40 Profile Cover	20	40	3	●	Plastic	2 gr
M 58/F	20x80 Profile Cover	20	80	3	●	Plastic	4 gr
M 58/R	25x25 Profile Cover	25	25	3	●	Plastic	1.5 gr
M 58/A	30x30 Profile Cover	30	30	3	●	Plastic	3.5 gr
M 58/H	35x35 Profile Cover	35	35	3.3	●	Plastic	4.5 gr
M 58/HV	35x35 Profile Cover (S10)	35	35	3.3	●	Plastic	4 gr
M 170	30x60 Profile Cover	30	60	3	●	Plastic	7 gr
M 171	30x90 Profile Cover	30	90	3.3	●	Plastic	7.5 gr
M PK 40	40x40 Profile Cover (S10)	40	40	3.3	●	Plastic	5.5 gr
M 172	40x40 Profile Cover (S8)	40	40	3.3	●	Plastic	5.5 gr
M 173	40x80 Profile Cover (S8)	40	80	3.3	●	Plastic	8.88 gr
M PK 48	40x80 Profile Cover (S10)	40	80	3.3	●	Plastic	9.5 gr
M 58/C	45x45 Profile Cover	45	45	3.6	●	Plastic	8 gr
M 58/J	45x60 Profile Cover	45	60	3.6	●	Plastic	9.5 gr
M 58/D	45x90 Profile Cover	45	90	3.6	●	Plastic	15.5 gr
M 174	45x135 Profile Cover	45	135	3.6	●	Plastic	19 gr
M 175	50x50 Profile Cover	50	50	3.6	●	Plastic	8 gr
M 176	50x100 Profile Cover	50	100	3.6	●	Plastic	17 gr
M 58/G	60x60 Profile Cover	60	60	3.6	●	Plastic	11.5 gr
M 177	60x60 Profile Cover (S8)	60	60	3.6	●	Plastic	12.5 gr
M 177/G	60x90 Profile Cover	90	60	3.6	●	Plastic	18.33 gr
M PK 80/8	80x80 Profile Cover (S8)	80	80	3.6	●	Plastic	21.6 gr
M PK 80	80x80 Profile Cover	80	80	3.6	●	Plastic	19.5 gr
M 58/E	90x90 Profile Cover	90	90	3.6	●	Plastic	31 gr
M 178	20x20 Radius Profile Cover	20	20	3	●	Plastic	1 gr
M 58/L	30x30 Radius Profile Cover	30	30	3	●	Plastic	2.5 gr
M 58/M	45x45 Radius Profile Cover	45	45	3	●	Plastic	7 gr
M 179	23x127 Profile Cover	23	126.8	4.2	●	Plastic	18.5 gr
M 179/X	Hexagon Stand Profile	60	52	3	●	Plastic	5.67 gr

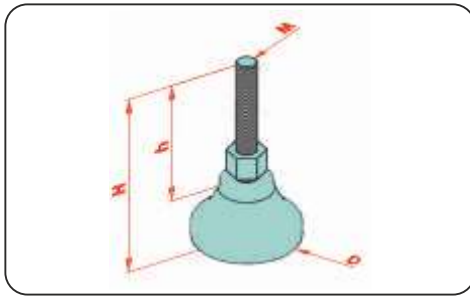

Code	Product Name	D	M	H	h	Material	Weight	Load Capacity
M 62/D	M6 Plastic Levelling Foot	Ø 41	M6	80	50	Plastic	41 gr	39 kg
M 62	M8 Plastic Levelling Foot	Ø 41	M8	80	50	Plastic	47 gr	49.5 kg
M 61	M10 Plastic Levelling Foot	Ø 60	M10	100	60	Plastic	116 gr	114 kg
M 61/C	M12 Plastic Levelling Foot	Ø 60	M12	100	60	Plastic	136 gr	152kg
M 61/B	M16 Plastic Levelling Foot	Ø 110	M16	160	110	Plastic	314 gr	325.5 kg



Code	Product Name	D	M	H	h	Material	Weight	Load Capacity
M 62/C	M10 Chrome Coated Metal Levelling Feet	Ø 60	M10	85	50	Chrome-steel	188 gr	190 kg
M 62/B	M12 Chrome Coated Metal Levelling Feet	Ø 80	M12	150	100	Chrome-steel	479 gr	489 kg
M 62/A	M16 Chrome Coated Metal Levelling Feet	Ø 120	M16	150	100	Chrome-steel	1.081 gr	1.150 kg

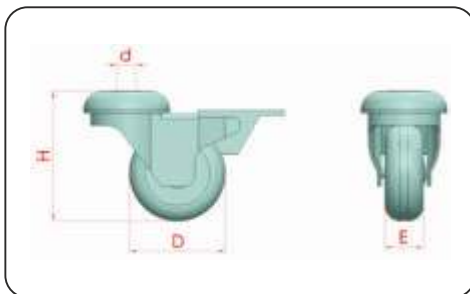

Code	Product Name	E	ØD	Ød	H	Load Capacity	Material	Weight
M 99/A	Ρόδα τρελή Φ 50	24	50	10	70	50 kg	Polyamid	204 gr
M 99/B	Ρόδα τρελή Φ 50 με φρένο	24	50	10	70	50 kg	Polyamid	277 gr
M 99/C	Ρόδα τρελή Φ 75	24	75	10	100	70 kg	Polyamid	298 gr
M 99/D	Ρόδα τρελή Φ 75 με φρένο	24	75	10	100	70 kg	Polyamid	538 gr
M 99/E	Ρόδα τρελή Φ 100	24	100	12	130	80 kg	Polyamid	719 gr
M 99/F	Ρόδα τρελή Φ 100 με φρένο	24	100	12	130	80 kg	Polyamid	820 gr

ΚΑΤΟΠΙΝ ΖΗΤΗΣΗΣ ΥΠΑΡΧΟΥΝ ΚΑΙ ΣΕ ΑΛΛΕΣ ΔΙΑΜΕΤΡΟΥΣ

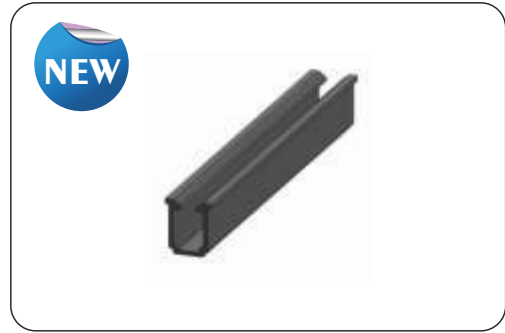
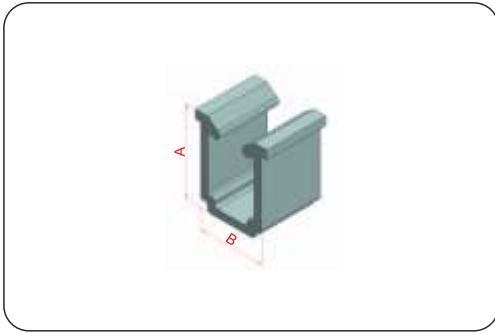
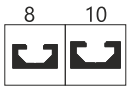

Code		Product Name	Color	A	B	Material	Weight
U 8	Slot 8	In Slot U 8 seal	●	9	8,2	PVC	44,6 gr
U 10	Slot 10	In Slot U 10 seal	●	14,00	10,20	PVC	50,6 gr

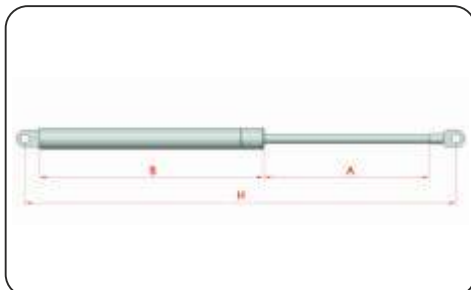
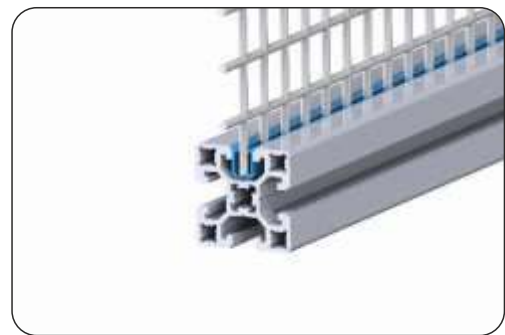

Code	Product Name	A	B	H Min. Max	Material	Weight
M 84	Absorbers (Strok 150mm) F300N	150	195	233 - 383	Steel	205 gr
M 84/B	Absorbers (Strok 105mm) F150N	105	145	188 - 293	Steel	159 gr
M 84/C	Absorbers (Strok 85mm) F85N	85	130	168 - 253	Steel	148 gr

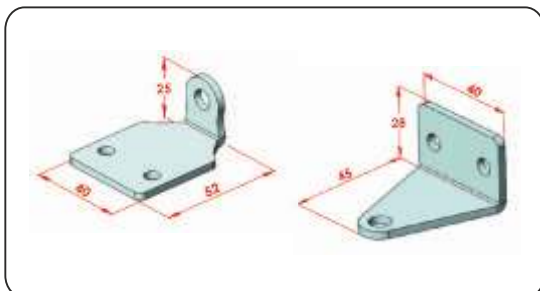

Code	Product Name	Material	Weight
M 84/D - M84/F	Absorber Connection Part	Steel	48 gr

Αλενόβιδες σε μετρικό DIN912 **INOX A2**

Πάχος →	3	4	5	6	8	10	12	14	16
↓ Μήκος ↓									
3-6									
8									
10									
12									
16									
20									
25									
30									
35									
40									
45									
50									
60									
70									
80									
90									
100									
110									
120									
130									
140									
150									



*τα 100 τεμάχια

Αλενόβιδες φρεζάτες DIN7991 **INOX A2**

Πάχος →	4	5	6	8	10	12
↓ Μήκος ↓						
10						
12						
16						
20						
25						
30						
35						
40						
45						
50						
60						
70						
80						

*τα 100 τεμάχια

Αλενόβιδες πομπέ DIN7380
INOX A2

Πάχος →	4	5	6	8	10
↓ Μήκος ↓					
10					
12					
16					
20					
25					
30					
35					
40					
50					
60					

*τα 100 τεμάχια

Ροδέλες DIN125 INOX A2

Τύπος	Τύπος
3X7	18X34
4X9	20X37
5X10	22X39
6X13	24X44
8X17	27X50
10X21	30X56
12X24	33X60
14X28	36X66
16X30	*τα 100 τεμάχια

Ροδέλες φαρδιές DIN9021 INOX A2

Τύπος	Τύπος
3X9	16X50
4X12	18X56
5X15	20X60
6X18	22X66
8X25	24X72
10X30	27X81
12X40	*τα 100 τεμάχια
14X45	

Ντίζες DIN976 1 μέτρου INOX A2

Πάχος	Πάχος
3	16
4	18
5	20
6	22
8	24
10	27
12	30
14	33

Γκρόβερ DIN127B INOX A2

Οπή	Οπή
3	16
4	18
5	20
6	22
8	24
10	27
12	30
14	*τα 100 τεμάχια

Ανοξείδωτα περικόχλια DIN934 INOX A2

Πάχος	Πάχος
2	16
2,5	18
3	20
4	22
5	24
6	27
8	30
10	33
12	36
14	*τα 100 τεμάχια

Περικόχλια ασφαλείας DIN985 INOX A2

Πάχος	Πάχος
3	14
4	16
5	18
6	20
8	22
10	24
12	*τα 100 τεμάχια



Περικόχλια τυφλά DIN1587 INOX A2

Πάσο	Πάσο
3	12
4	14
5	16
6	18
8	20
10	*τα 100 τεμάχια

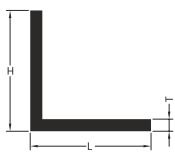

Περικόχλια πεταλούδες DIN315AF INOX A2

Πάσο
3
4
5
6
8
10
12
14
16
*τα 100 τεμάχια



Γωνίες Corners	Περιγραφή Description (LxHxT)	Θ.Β. Weight	Περιγραφή Description (LxHxT)	Θ.Β. Weight
	15x15x1,9	0,132	10x10x4,0	0,100
	20x20x1,5	0,160	30x20x1,50	0,200
	25x25x1,5	0,200	50x20x2,0	0,370
	30x30x1,5	0,240	60x60x3,0	0,950
	40x40x1,5	0,318	75x50x5,0	1,640
	40x20x1,5	0,240	60x20x1,5	0,320
	50x30x3,0	0,620	60x40x4,0	1,040
	50x50x2,0	0,530	80x40x4,0	1,250
	60x20x1,5	0,320	80x20x1,5	0,400
	100x20x2,0	0,640	100x100x8,0	4,150
100x50x5,0	1,960	120x20x2,0	0,750	

Ζητήστε μας τιμές

Λάμες Profiles	Περιγραφή Description (LxT)	Θ.Β. Weight	Περιγραφή Description (LxT)	Θ.Β. Weight
	20x3	0,160	80x50	1,080
	20x5	0,270	80x10	2,160
	25x3	0,200	80x15	3,240
	25x5	0,340	100x8	2,160
	30x3	0,240	100x10	2,700
	40x5	0,540	100x20	5,400
	30x5	0,410	100x30	8,100
	30x10	0,810	120x10	3,240
	40x3	0,320	120x15	4,860
	40x5	0,540	120x20	6,480
	40x10	1,080	150x10	4,050
	40x15	1,620	150x15	6,080
	40x20	2,160	150x20	8,100
	50x3	0,410	200x10	5,400
	50x5	0,620	200x15	8,100
	50x8	1,080	200x20	10,800
	50x10	1,350	20x10	0,540
	60x3	0,490	40x8	0,860
	60x5	0,810	60x8	1,300
	60x10	1,620	95x11	2,822
60x15	2,430	95x11	2,822	

Ζητήστε μας τιμές

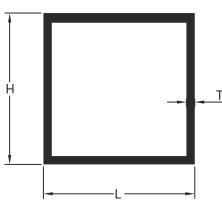
Καρέ Square	Περιγραφή Description (LxHxT)	Θ.Β. Weight	Περιγραφή Description (LxHxT)	Θ.Β. Weight
	12x12x1,0	0,120	40x40x1,5	0,624
	15x15x1,5	0,220	50x50x1,5	0,786
	20x20x1,5	0,300	100x50x2,0	1,580
	25x25x1,5	0,380	60x20x1,5	0,620
	30x30x1,3	0,403	60x40x2,0	1,041
	40x20x1,5	0,460	80x20x1,3	0,684

Ζητήστε μας τιμές

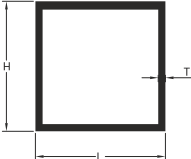
Καρέ Square	Περιγραφή Description (LxHxT)	Θ.Β. Weight	Περιγραφή Description (LxHxT)	Θ.Β. Weight
	80x40x1,3	0,824	100x40x1,6	1,180
	80x80x1,8	1,520	100x50x2,0	1,580
	100x20x1,5	0,950	100x100x2,0	2,120
	120x20x1,6	1,180	100x100x4,0	4,150

Ζητήστε μας τιμές

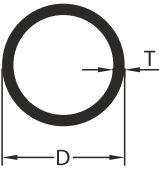
Σωλήνες Tubes	Περιγραφή Description (DxT)	Θ.Β. Weight	Περιγραφή Description (DxT)	Θ.Β. Weight
	Φ8x1mm	0,060	Φ30x2mm	0,480
	Φ10x1mm	0,080	Φ32x2mm	0,510
	Φ12x2mm	0,170	Φ42,4x2mm	0,685
	Φ16x1,5mm	0,184	Φ50x2mm	0,814
	Φ16x3,5mm	0,370	Φ60x2mm	0,984
	Φ18x2,0mm	0,270	Φ70x2mm	1,154
	Φ20x1,85mm	0,285	Φ80x2mm	1,320
	Φ22x1,5mm	0,260	Φ100x2mm	1,663
	Φ25x2mm	0,390	Φ120x3mm	1,154
	Φ26x2mm	0,407		

Ζητήστε μας τιμές

Λαμαρίνες Αλουμινίου	Περιγραφή Description (DxT)	Περιγραφή Description (DxT)
	2000x1000x0.60 mm	2500x1250x0.60 mm
	2000x1000x0.80 mm	2500x1250x0.80 mm
	2000x1000x1.00 mm	2500x1250x1.00 mm
	2000x1000x1.50 mm	2500x1250x1.50 mm
	2000x1000x2.00 mm	2500x1250x2.00 mm
	2000x1000x3.00 mm	2500x1250x3.00 mm
	2000x1000x4.00 mm	2500x1250x4.00 mm
	2000x1000x5.00 mm	2500x1250x5.00 mm
	2000x1000x6.00 mm	2500x1250x6.00 mm
	2000x1000x8.00 mm	2500x1250x8.00 mm
	2000x1000x10.00 mm	2500x1250x10.00 mm
	2000x1000x12.00 mm	2500x1250x12.00 mm
	2000x1000x15.00 mm	2000x1000x20.00 mm

Ζητήστε μας τιμές

- ΜΠΟΡΟΥΝ ΝΑ ΚΟΠΟΥΝ ΚΑΙ ΝΑ ΕΠΕΞΕΡΓΑΣΤΟΥΝ ΚΑΤΟΠΙΝ ΠΑΡΑΓΓΕΛΙΑΣ
- ΕΠΙΣΗΣ ΥΠΑΡΧΟΥΝ ΛΑΜΑΡΙΝΕΣ ΤΥΠΟΥ ΚΡΙΘΑΡΑΚΙ & ΜΠΑΚΛΑΒΩΤΟ

**Η ΕΤΑΙΡΙΑ ΜΑΣ ΔΙΑΘΕΤΕΙ ΥΠΕΡΣΥΓΧΡΩΝΟ ΕΞΟΠΛΙΣΜΟ ΟΠΩΣ
ΣΤΡΑΝΤΖΑ - ΨΑΛΙΔΙ - LASER ΠΑΝΤΟΓΡΑΦΟ**



ΚΑΤΑΛΟΓΟΣ

**ΕΞΑΡΤΗΜΑΤΑ ΒΙΟΜΗΧΑΝΙΚΩΝ ΜΕΤΑΦΟΡΕΩΝ
ACCESSORIES CONVEYOR SYSTEMS**

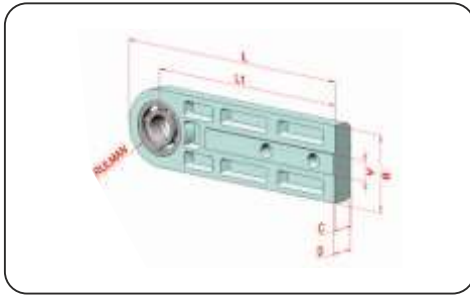

CODE	PRODUCT NAME	A	B	C	L	L1	Roller	Material	Weight
TL 10	30x30 Drive plate	8.2	30	13	115	100	61802	ΣΚΛΗΡΟ ΑΛΟΥΜΙΝΙΟ	96 gr
TL 20	45x45 Drive plate	10.2	45	13.6	152	129.5	1202	ΣΚΛΗΡΟ ΑΛΟΥΜΙΝΙΟ	210 gr

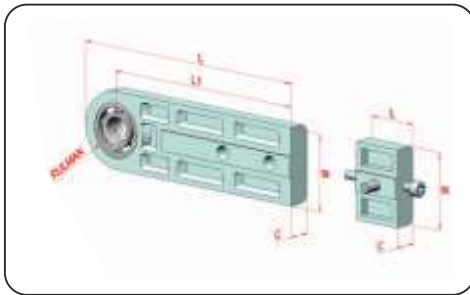

CODE	PRODUCT NAME	A	B	C	L	L1	Roller	Material	Weight
TL 30	30x30 Tension plate	8.2	30	13	115	100	61802	ΣΚΛΗΡΟ ΑΛΟΥΜΙΝΙΟ	96 gr
TL 40	45x45 Tension plate	10.2	45	13.6	152	129.5	1202	ΣΚΛΗΡΟ ΑΛΟΥΜΙΝΙΟ	207 gr

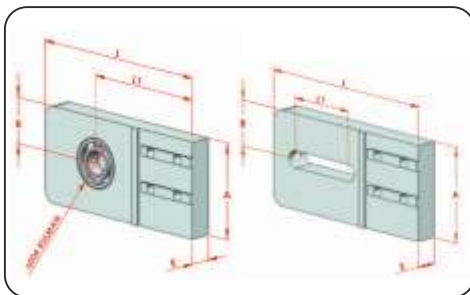
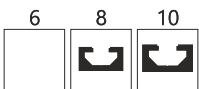

CODE	PRODUCT NAME	A	B	E	L	L1	Roller	Material	Weight
TL 50	30x60-60x60 Tension plate	80	38	20	165	60	-	ΑΛΟΥΜΙΝΙΟ	863 gr
TL 60	30x60-60x60 Drive plate	80	38	20	165	108	6004	ΑΛΟΥΜΙΝΙΟ	931 gr
TL 70	45x90-90x90 Tension plate	90	55	19,3	200	69.8	-	ΑΛΟΥΜΙΝΙΟ	1043 gr
TL 80	45x90-90x90 Drive plate	90	55	19,3	200	132	6004	ΑΛΟΥΜΙΝΙΟ	1115 gr

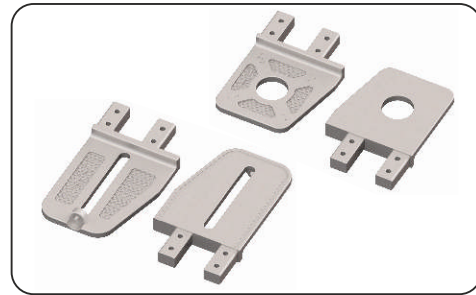
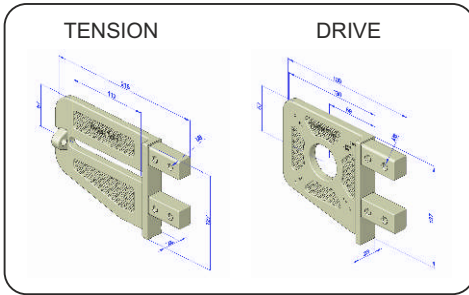

CODE	PRODUCT NAME	Material	Weight
TL 100	23x127 Tension Plate	XYTO ΑΛΟΥΜΙΝΙΟ	1162 gr
TL 120	23x127 Drive plate	XYTO ΑΛΟΥΜΙΝΙΟ	972 gr

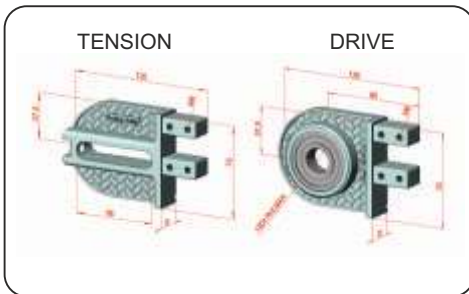

CODE	PRODUCT NAME	Material	Weight
TL 90	23x75 Tension Plate	XYTO ΑΛΟΥΜΙΝΙΟ	181 gr
TL 130	23x75 Drive plate	XYTO ΑΛΟΥΜΙΝΙΟ	256 gr

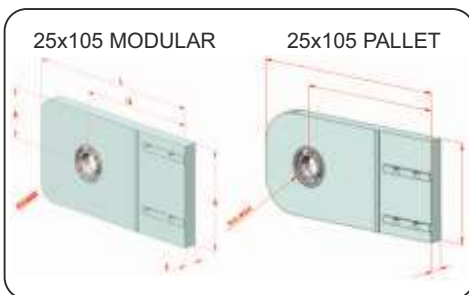

CODE	PRODUCT NAME	A	B	E	L	L1	Roller	Material	Weight
TL 105 M	25x105 Modular conveyor left	90	40	14	170	130	6004	ΑΛΟΥΜΙΝΙΟ	577 gr
TL 105 R	25x105 Pallet conveyor right	90	40	14	170	130	6004	ΑΛΟΥΜΙΝΙΟ	577 gr
TL 105 P	25x105 Pallet conveyor plate	120	65	17	250	185	6005	ΑΛΟΥΜΙΝΙΟ	1343 gr
TL 150 M	25x150 Modular conveyor left	130	65	17	245	165	6005	ΑΛΟΥΜΙΝΙΟ	1400 gr
TL 110 R	25x150 Modular conveyor right	130	65	17	245	165	6005	ΑΛΟΥΜΙΝΙΟ	1400 gr
TL 150 L	25x150 Pallet conveyor left	150	75	17	245	185	6005	ΑΛΟΥΜΙΝΙΟ	1500 gr
TL 150 R	25x150 Pallet conveyor right	150	75	17	245	185	6005	ΑΛΟΥΜΙΝΙΟ	1500 gr

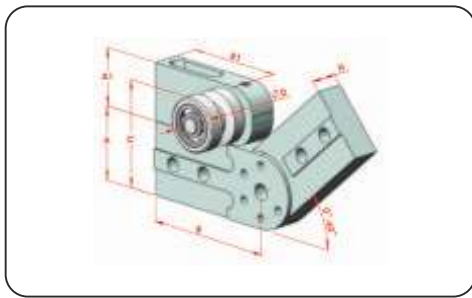

CODE	PRODUCT NAME	A	A1	B	B1	C	D	H	Material	Weight
TL 1	30x30 Miniature conveyor joint plate	30	-	65	-	48	-	13	ΑΛΟΥΜΙΝΙΟ	129 gr
TL 2	30x30 Roller pin & connection parts	-	35,5	-	65	-	33	17	ΑΛΟΥΜΙΝΙΟ	105,5 gr
TL 3	45x45 Miniature conveyor joint plate	45	-	87,5	-	65,5	-	17,5	ΑΛΟΥΜΙΝΙΟ	343 gr
TL 4	45x45 Roller pin & connection parts	-	36	-	57	-	26	14,6	ΑΛΟΥΜΙΝΙΟ	186,5 gr

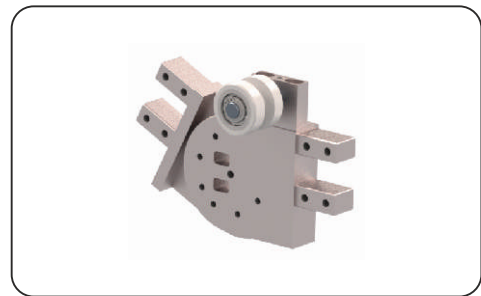
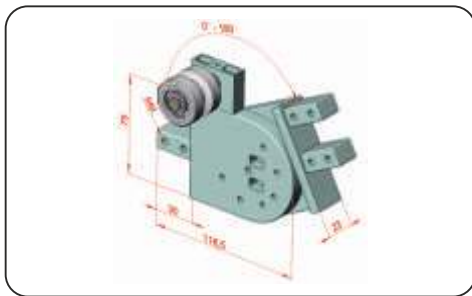

CODE	PRODUCT NAME	A	B	C	Material	Weight
TL 2375 LR	23x75 Conveyor joint plate	48	185	127	ΑΛΟΥΜΙΝΙΟ	450 gr
TL 237550	23x127 Roller Φ 50 pin & connection parts	29	36	50	ΑΛΟΥΜΙΝΙΟ	100 gr

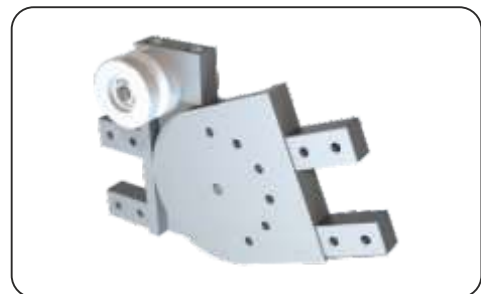
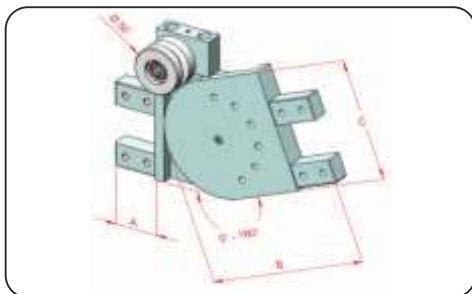

CODE	PRODUCT NAME	A	B	C	Material	Weight
TL 5 R	23x127 Conveyor joint plate right	48	185	127	ΑΛΟΥΜΙΝΙΟ	1289 gr
TL 5 L	23x127 Conveyor joint plate left	48	185	127	ΑΛΟΥΜΙΝΙΟ	1289 gr
TL 6	23x127 Roller Φ 50 pin & connection parts	39	60	50	ΑΛΟΥΜΙΝΙΟ	230 gr
TL 7	23x127 Roller Φ 90 pin & connection parts	60	100	90	ΑΛΟΥΜΙΝΙΟ	686 gr
TL 8	23x127 Elevator interior roller connection	32	-	50	ΑΛΟΥΜΙΝΙΟ	52 gr

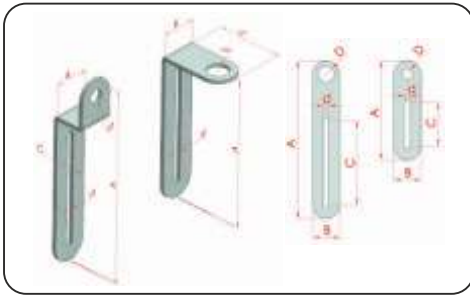
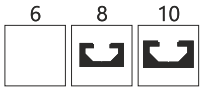

CODE	PRODUCT NAME	A	B	C	D	d	Material	Weight
TL 41	Sensor Connection Cassete Flat	110	30	48,8	12,2	6.2	HRP	61 gr
TL 42	Sensor Connection Cassete Flat	175	30	93,8	12,2	6.2	HRP	106 gr
TL 43	Sensor Connection Cassete Flat (L)	128	30	48	12,2	6.2	HRP	97 gr
TL 44	Sensor Connection Cassete Flat (S)	168	30	28	12,2	6.2	HRP	118 gr
TL 45	Sensor Connection Cassete Flat	110	30	48,8	18,2	6.2	HRP	61,5 gr
TL 46	Sensor Connection Cassete Flat	175	30	93,8	18,2	6.2	HRP	101 gr
TL 47	Sensor Connection Cassete Flat (L)	128	30	58	18,2	6.2	HRP	106 gr
TL 48	Sensor Connection Cassete Flat (S)	186	30	53	18,2	6.2	HRP	146,5 gr

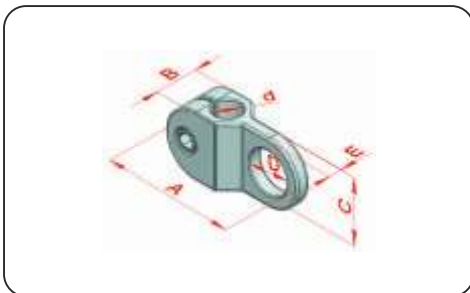

CODE	PRODUCT NAME	A	B	C	D	d	E	Material	Weight
TL 31	Sensor Holder Φ 10	60	20	30	Ø19	Ø10	8	ΠΛΑΣΤΙΚΟ	20 gr
TL 32	Sensor Holder Φ 12	60	20	30	Ø19	Ø12	6	ΠΛΑΣΤΙΚΟ	17 gr

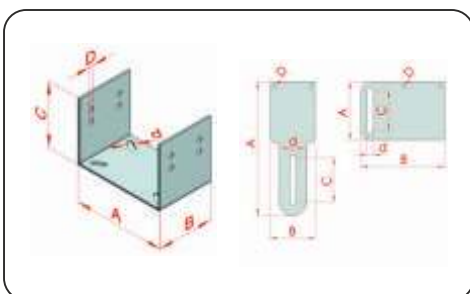

CODE	PRODUCT NAME	A	B	C	D	d	Material	Weight
TL 33	Flat horizontal 3 mm	64	92	44	3,3	7	HRP	126 gr
TL 34	Flat vertical 3 mm	147,5	50	48,8	3,6	6.2	HRP	130,5 gr
TL 35	Conveyor (U) plate	146	90	103	8	8	HRP	685 gr

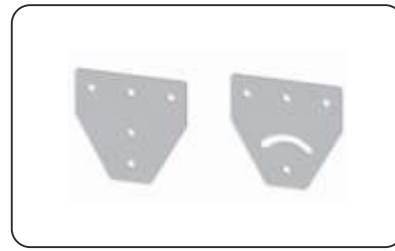
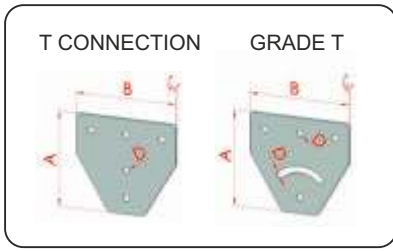
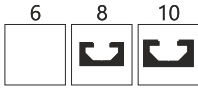

CODE	PRODUCT NAME	A	B	C	D	Material	Weight
TL 51	T Connection	120	126	3	8,5	ZINC	283 gr
TL 52	Grade T Connection	120	126	3	8,5	ZINC	271 gr

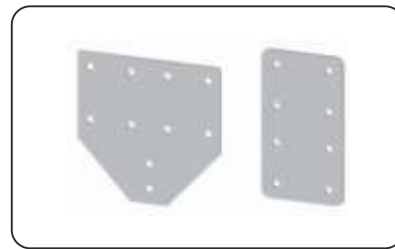
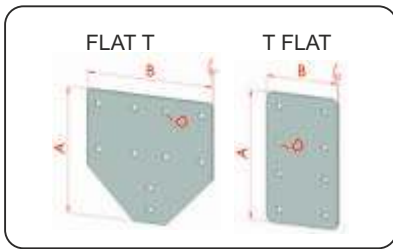

CODE	PRODUCT NAME	A	B	C	D	Material	Weight
TL 53	Flat T Attachment	175	175	3	8,5	ZINC	601 gr
TL 54	T Flat Attachment	180	100	3	8,5	ZINC	563.5 gr

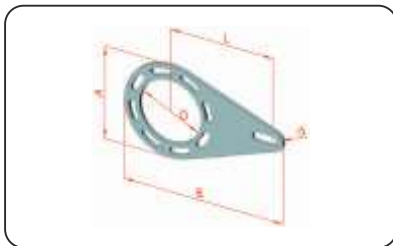

CODE	PRODUCT NAME	D	d	A	B	L	Material	Reducer Type	Weight
TL 55	Torque arm	Ø45	Ø8,2	65	143,5	101	3 mm ZINC	EV 25	95,5 gr
TL 56	Torque arm	Ø55	Ø8,2	78	164	115	3 mm ZINC	EV 30	127,5 gr
TL 57	Torque arm	Ø60	Ø8,5	90	155	100	3 mm ZINC	EV 40	125 gr
TL 58	Torque arm	Ø70	Ø8,5	100	170	106	3 mm ZINC	EV 50	164 gr
TL 59	Torque arm	Ø80	Ø10,5	115	200	130	5 mm ZINC	EV 63	333 gr

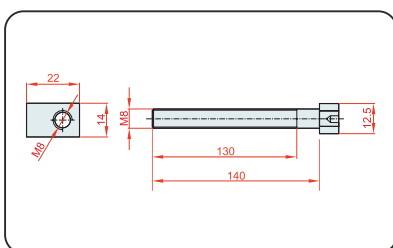

CODE	PRODUCT NAME	Material	Weight
TL 71	23 x 127 Tension bolt	STEEL 8.8	50 gr
TL 72	23 x 127 Tension nut	STAINLESS	29 gr

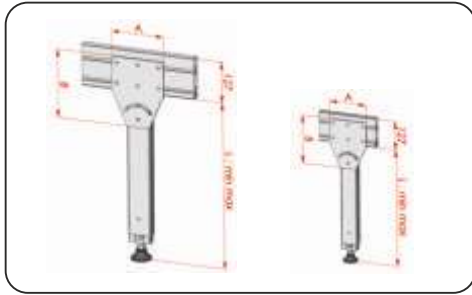

CODE	PRODUCT NAME	A	B	L min	L max	Material	Weight
TL 73	Grade Metal Feet (small)	180	233	570	870	ZINC	3.12 Kg
TL 74	Grade Metal Feet (big)	200	240	750	1200	ZINC	4.82 Kg



CODE	PRODUCT NAME	Dimension/mm	Inverter	Weight
TL 75	Speed Panel inverter 0,37 Kw	145x150x230	LS-SV-IE5	2.150 gr
TL 76	Speed Panel inverter 0,37 Kw	170x205x300	LS-SV-IC5	2.950 gr
TL 77	Speed Panel inverter 0,75 Kw	170x205x300	LS-SV-IC5	2.950 gr
TL 78	Speed Panel inverter 1,75 Kw	170x205x300	LS-SV-IC5	2.950 gr

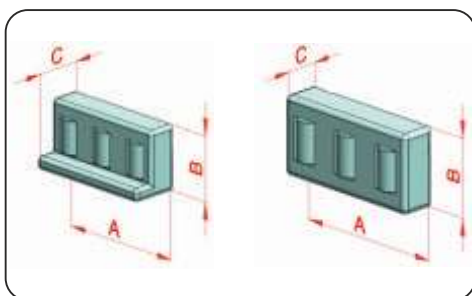

CODE	PRODUCT NAME	A	B	C	Material	Weight
TL 91	Pallet conveyor roller unbarrier	80	40	18	ΠΛΑΣΤΙΚΟ	45 gr
TL 92	Pallet conveyor roller barrier	80	40	30	ΠΛΑΣΤΙΚΟ	51 gr

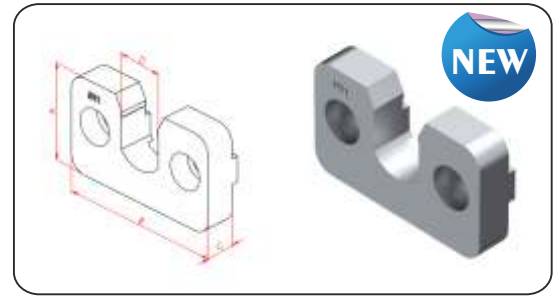
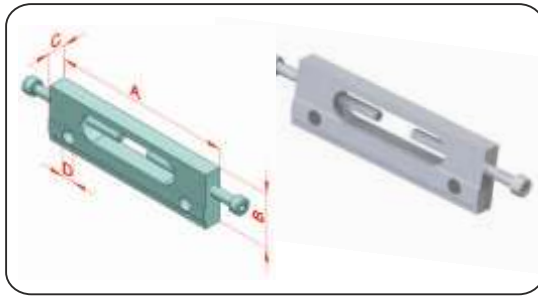

CODE	PRODUCT NAME	A	B	C	ØD	Material	Weight
TL 93	Bottom return roller bearing	100	30	9	7	ΑΛΟΥΜΙΝΙΟ	66 gr
TL 93/50	Roll Bed Ø50	25	50,5	7,5	8	Nylon	10,66 gr
TL 93/51	Roll Bed Ø51	30	51,5	9	14	Nylon	14,55 gr

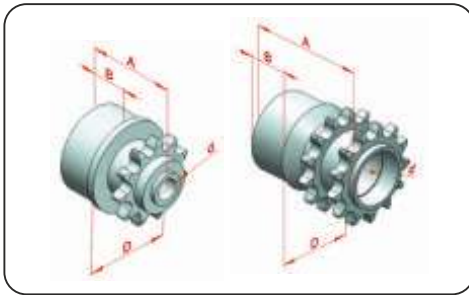

CODE	PRODUCT NAME	A	B	D	d	Material	Weight
TL 94	Roller chain wheel Φ50 1/2	56	24,8	50	12	ΠΛΑΣΤΙΚΟ	82 gr
TL 95	Double roller chain wheel Φ50 1/2	72,5	24,5	47	12	ΠΛΑΣΤΙΚΟ	87,6 gr

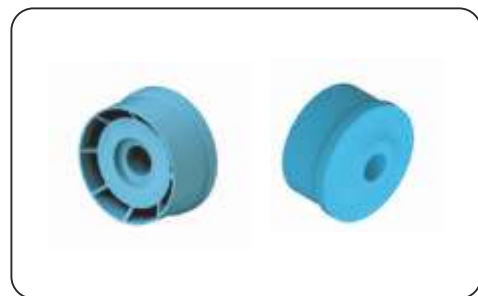
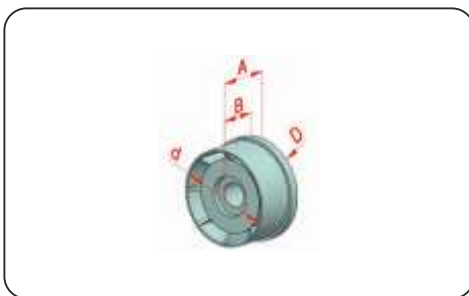

CODE	PRODUCT NAME	A	B	ØD	Ød	Material	Weight
PLS 50	PLS roll head Φ50 x 1,5	27,5	19,5	50	47	ΠΛΑΣΤΙΚΟ	60 gr
PLS 30	PLS roll head Φ30 x 1	27	19	30	28	ΠΛΑΣΤΙΚΟ	11,5 gr
PLS 30 D	PLS roll head Φ30 x 1,5	27	19	30	27	ΠΛΑΣΤΙΚΟ	11 gr
PLS 20	PLS roll head Φ20 x 1	26	18	20	18	ΠΛΑΣΤΙΚΟ	5,5 gr
PLS 40	PLS roll head Φ40 x 1,5	27	19	40	38	ΠΛΑΣΤΙΚΟ	60 gr
PLS 40 B	PLS roll head Φ40 x 1,5 black	27,5	19,5	50	47	ΠΛΑΣΤΙΚΟ	60 gr

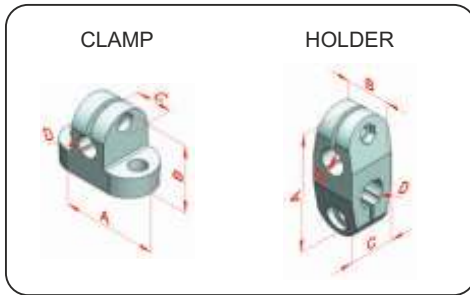

CODE	PRODUCT NAME	A	B	C	D	Material	Weight
TL 61	Console body connection clamp	55,5	21	21,8	Ø12	ΠΛΑΣΤΙΚΟ	32,5 gr
TL 62	Console cross holder Φ12	56	39	21,5	Ø12	ΠΛΑΣΤΙΚΟ	27 gr

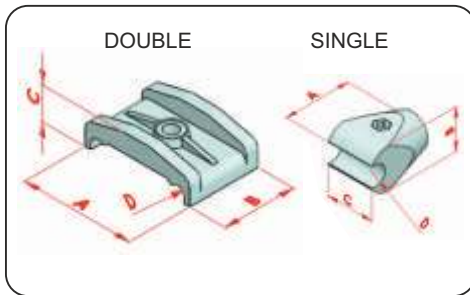

CODE	PRODUCT NAME	A	B	C	D	Material	Weight
TL 63	Single shaft holder Φ12	38	24	27	Ø12	ΠΛΑΣΤΙΚΟ	24 gr
TL 64	Double shaft holder Φ12	92	60	28	Ø12	ΠΛΑΣΤΙΚΟ	96 gr



CODE	PRODUCT NAME	A	D	d	H	Material	Weight
TL 65	Frame side connection mount	93,5	Ø50	Ø10	77,5	ΠΛΑΣΤΙΚΟ	486 gr

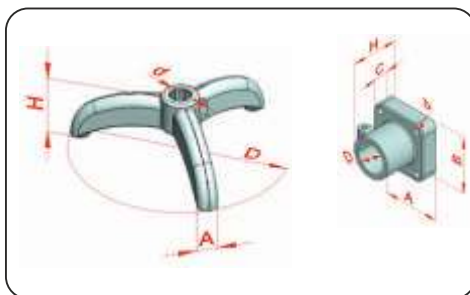

CODE	PRODUCT NAME	A	D	d	H	Material	Weight
TL 66	Triple Feet	44	Ø482	Ø50	140	ΠΛΑΣΤΙΚΟ	1.045 gr
TL 67	Frame loner connection mount	70	Ø50	Ø10	175	ΠΛΑΣΤΙΚΟ	344 gr

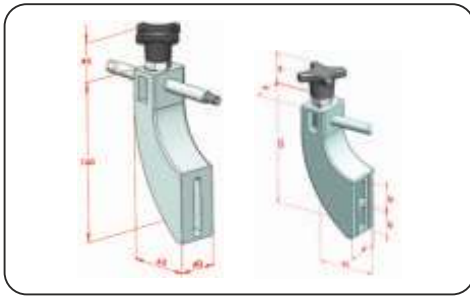
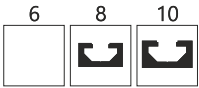

CODE	PRODUCT NAME	ØD	M	L	Material	Weight
TL 131	Console connection kit	-	-	-	Plastic	203 gr
TL 139	Miniature console connection kit	-	-	-	Plastic	179 gr
TL 133	Console connection shaft (120mm)	Ø12	M8	120	Stainless steel	103 gr
TL 134	Console connection shaft (150mm)	Ø12	M8	150	Stainless steel	130 gr
TL 135	Console connection shaft (200mm)	Ø12	M8	200	Stainless steel	175 gr

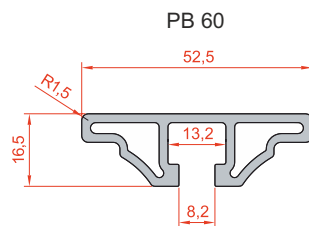
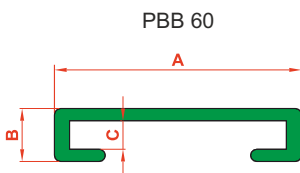
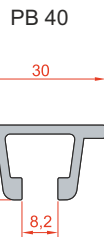
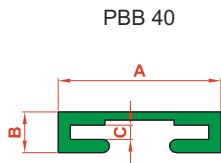

CODE	Size	Quality	L (mm)	Moment of inertia		Area	Mass
				I _x	I _y		
PB 40	40 mm	6063	6000	0,50cm ⁴	1,06cm ⁴	1,52cm ²	0,41Kg/m
PB 60	60 mm	6063	6000	0,77cm ⁴	6,10cm ⁴	2,83cm ²	0,77Kg/m

CODE	Size	PRODUCT NAME	A	B	C	Material	Mass
PBB 40	40 mm	Side barrier (10x40)	40	9,5	4,5	PVC	0,26 Kg/m
PBB 60	60 mm	Side barrier (13x60)	60	13	7	PVC	0,35 Kg/m

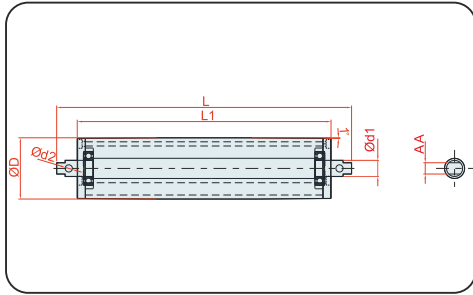

CODE	PRODUCT NAME	ALUMINIUM PROFILE	ΦΑΡΔΟΣ	L	L1	AA	ØD	Ød1	Ød2	Material	Weight
TL 151	Φ76 Tension drum	23 x 127	300	366	315	14	76	20	9	ΑΛΟΥΜΙΝΙΟ	2.557 gr
TL 152	Φ76 Tension drum	23 x 127	450	516	465	14	76	20	9	ΑΛΟΥΜΙΝΙΟ	3.607 gr
TL 153	Φ76 Tension drum	23 x 127	600	666	615	14	76	20	9	ΑΛΟΥΜΙΝΙΟ	4.646 gr
TL 154	Φ76 Tension drum	23 x 127	800	866	815	14	76	20	9	ΑΛΟΥΜΙΝΙΟ	6.321 gr
TL 155	Φ76 Tension drum	23 x 127	1000	1066	1015	14	76	20	9	ΑΛΟΥΜΙΝΙΟ	7.432 gr
TLT 30	Φ76 Tension drum	23 x 75	300	366	315	14	76	20	8.5	ΑΛΟΥΜΙΝΙΟ	2.405 gr
TLT 45	Φ76 Tension drum	23 x 75	450	516	465	14	76	20	8.5	ΑΛΟΥΜΙΝΙΟ	3.457 gr
TLT 60	Φ76 Tension drum	23 x 75	600	666	615	14	76	20	8.5	ΑΛΟΥΜΙΝΙΟ	4.509 gr
TLT 80	Φ76 Tension drum	23 x 75	800	866	815	14	76	20	8.5	ΑΛΟΥΜΙΝΙΟ	5.911 gr
TLT 100	Φ76 Tension drum	23 x 75	1000	1066	1015	14	76	20	8.5	ΑΛΟΥΜΙΝΙΟ	7.314 gr

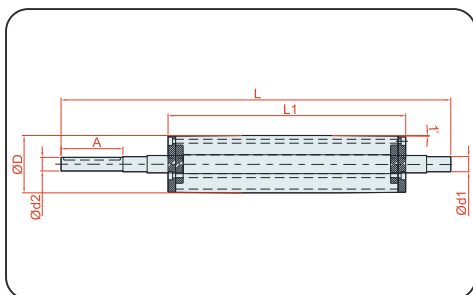

CODE	PRODUCT NAME	ALUMINIUM PROFILE	ΦΑΡΔΟΣ	L	L1	A	ØD	Ød1	Ød2	Material	Weight
TL 156	Φ76 Drive drums	23 x 127	300	516.6	315	82	76	20	18	ΑΛΟΥΜΙΝΙΟ	2.943 gr
TL 157	Φ76 Drive drums	23 x 127	450	666.6	465	82	76	20	18	ΑΛΟΥΜΙΝΙΟ	3.973 gr
TL 158	Φ76 Drive drums	23 x 127	600	816.6	615	82	76	20	18	ΑΛΟΥΜΙΝΙΟ	5.017 gr
TL 159	Φ76 Drive drums	23 x 127	800	1016.6	815	82	76	20	18	ΑΛΟΥΜΙΝΙΟ	6.385 gr
TL 160	Φ76 Drive drums	23 x 127	1000	1216.6	1015	82	76	20	18	ΑΛΟΥΜΙΝΙΟ	7.810 gr
TLD 30	Φ76 Drive drums	23 x 75	300	464.1	315	82	76	20	18	ΑΛΟΥΜΙΝΙΟ	2.745 gr
TLD 45	Φ76 Drive drums	23 x 75	450	614.1	465	82	76	20	18	ΑΛΟΥΜΙΝΙΟ	3.797 gr
TLD 60	Φ76 Drive drums	23 x 75	600	764.1	615	82	76	20	18	ΑΛΟΥΜΙΝΙΟ	4.849 gr
TLD 80	Φ76 Drive drums	23 x 75	800	964.1	815	82	76	20	18	ΑΛΟΥΜΙΝΙΟ	6.252 gr
TLD 100	Φ76 Drive drums	23 x 75	1000	1164.1	1015	82	76	20	18	ΑΛΟΥΜΙΝΙΟ	7.654 gr

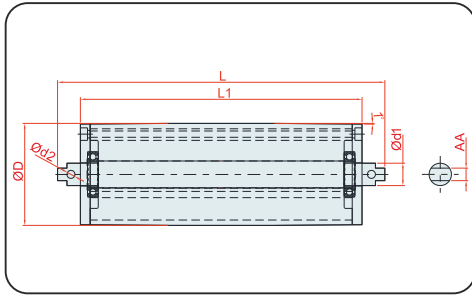

CODE	PRODUCT NAME	ΦΑΡΔΟΣ	L	L1	AA	ØD	Ød1	Ød2	Material	Weight
TD 30	Φ114 Tension drums	300	366	315	14	114	25	9	ΑΛΟΥΜΙΝΙΟ	4.446 gr
TD 45	Φ114 Tension drums	450	516	465	14	114	25	9	ΑΛΟΥΜΙΝΙΟ	6.231 gr
TD 60	Φ114 Tension drums	600	666	615	14	114	25	9	ΑΛΟΥΜΙΝΙΟ	7.665 gr
TD 80	Φ114 Tension drums	800	866	815	14	114	25	9	ΑΛΟΥΜΙΝΙΟ	10.220 gr
TD 100	Φ114 Tension drums	1000	1066	1015	14	114	25	9	ΑΛΟΥΜΙΝΙΟ	12.540 gr
TD 120	Φ114 Tension drums	1200	1271	1220	20	114	30	9	ΑΛΟΥΜΙΝΙΟ	17.160 gr
TD 135	Φ114 Tension drums	1350	1421	1370	20	114	30	9	ΑΛΟΥΜΙΝΙΟ	19.240 gr
TD 150	Φ114 Tension drums	1500	1571	1520	20	114	30	9	ΑΛΟΥΜΙΝΙΟ	21.120 gr

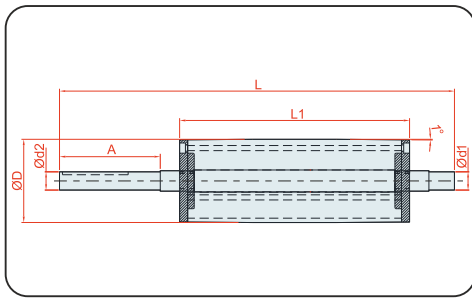

CODE	PRODUCT NAME	ΦΑΡΔΟΣ	L	L1	A	ØD	Ød1	Ød2	Material	Weight
TD 30 A	Φ114 Drive drums	300	541	315	138	114	25	25	ΑΛΟΥΜΙΝΙΟ	5.235 gr
TD 65 A	Φ114 Drive drums	450	691	465	138	114	25	25	ΑΛΟΥΜΙΝΙΟ	6.979 gr
TD 60 A	Φ114 Drive drums	600	841	615	138	114	25	25	ΑΛΟΥΜΙΝΙΟ	8.658 gr
TD 80 A	Φ114 Drive drums	800	1041	815	138	114	25	25	ΑΛΟΥΜΙΝΙΟ	10.980 gr
TD 100 A	Φ114 Drive drums	1000	1241	1015	138	114	25	25	ΑΛΟΥΜΙΝΙΟ	13.280 gr
TD 120 A	Φ114 Drive drums	1200	1500	1220	138	114	30	25	ΑΛΟΥΜΙΝΙΟ	18.200 gr
TD 135 A	Φ114 Drive drums	1350	1650	1370	138	114	30	25	ΑΛΟΥΜΙΝΙΟ	19.980 gr
TD 150 A	Φ114 Drive drums	1500	1800	1520	138	114	30	25	ΑΛΟΥΜΙΝΙΟ	21960 gr

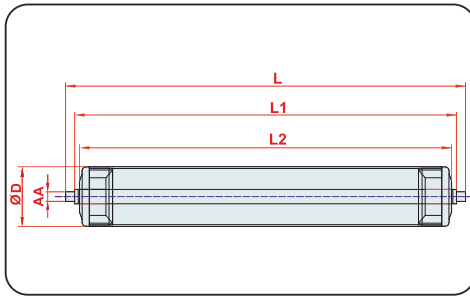

CAPACITY
250 KG



CODE	PRODUCT NAME	L	L1	L2	ØD	AA	Material	Weight
TL 290	Φ50 x 290 Aluminium roller	335	310	320	50	8	ΑΛΟΥΜΙΝΙΟ	584 gr
TL 440	Φ50 x 440 Aluminium roller	485	460	470	50	8	ΑΛΟΥΜΙΝΙΟ	816 gr
TL 590	Φ50 x 590 Aluminium roller	635	610	620	50	8	ΑΛΟΥΜΙΝΙΟ	1.079 gr
TL 790	Φ50 x 790 Aluminium roller	835	810	820	50	8	ΑΛΟΥΜΙΝΙΟ	1.384 gr

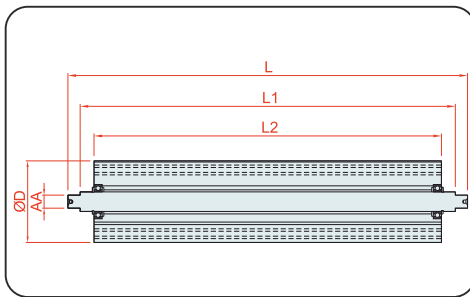

CAPACITY
300 KG



CODE	PRODUCT NAME	L	L1	L2	ØD	AA	Material	Weight
KNU 29	Φ50 x 290 Aluminium KNURLED	335	310	320	50	8	ΑΛΟΥΜΙΝΙΟ	880 gr
KNU 44	Φ50 x 440 Aluminium KNURLED	485	460	470	50	8	ΑΛΟΥΜΙΝΙΟ	1300 gr
KNU 59	Φ50 x 590 Aluminium KNURLED	635	610	620	50	8	ΑΛΟΥΜΙΝΙΟ	1720 gr
KNU 79	Φ50 x 790 Aluminium KNURLED	835	810	820	50	8	ΑΛΟΥΜΙΝΙΟ	2280 gr
KNU 99	Φ50 x 990 Aluminium KNURLED	1035	1010	1020	50	8	ΑΛΟΥΜΙΝΙΟ	2850 gr

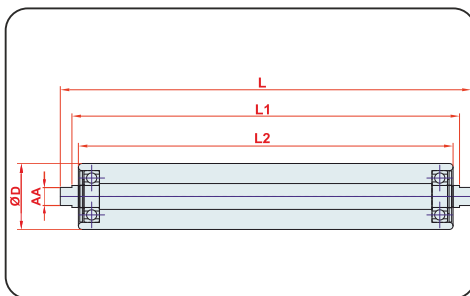

CAPACITY
400 KG



CODE	PRODUCT NAME	L	L1	L2	ØD	AA	Material	Weight
TL 290 S	Φ51 x 290 Steel roller	318	300	290	Ø51	14	Steel	1603 gr
TL 440 S	Φ51 x 440 Steel roller	468	450	440	Ø51	14	Steel	2426 gr
TL 590 S	Φ51 x 590 Steel roller	618	600	590	Ø51	14	Steel	3162 gr
TL 790 S	Φ51 x 790 Steel roller	818	800	790	Ø51	14	Steel	3987 gr
TL 1000 S	Φ51 x 1000 Steel roller	1018	1000	990	Ø51	14	Steel	4812gr
TL 1200 S	Φ51 x 1200 Steel roller	1223	1205	1195	Ø51	14	Steel	5662 gr

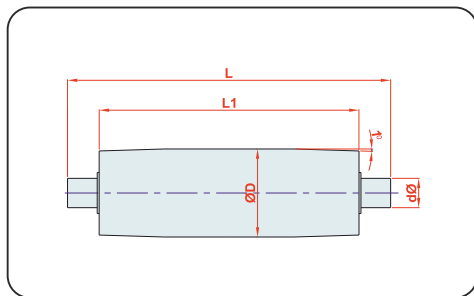

CODE	PRODUCT NAME	ΦΑΡΔΟΣ	L	L1	ØD	Ød	Material	Weight
TDS 25	Φ30 Tension drums	25	42	28	30	15	Steel	160 gr
TDS 55	Φ30 Tension drums	55	72	58	30	15	Steel	346 gr
TDS 85	Φ30 Tension drums	85	102	88	30	15	Steel	645 gr
TDS120	Φ30 Tension drums	120	140	126	34	15	Steel	855 gr
TDS 40	Φ45 Tension drums	40	63	43	45	15	Steel	668 gr
TDS 85/45	Φ45 Tension drums	85	108	88	45	15	Steel	1.607 gr
TDS 130	Φ45 Tension drums	130	153	133	45	15	Steel	1.927 gr
TDS 150	Φ45 Tension drums	150	176	156	49	15	Steel	1.979 gr
TDS 175	Φ45 Tension drums	175	198	178	45	15	Steel	2.629 gr
TDS 200	Φ45 Tension drums	200	226	206	49	15	Steel	2.919 gr
TDS 300	Φ45 Tension drums	300	326	306	49	15	Steel	4.389 gr
TDS 450	Φ45 Tension drums	450	476	456	49	15	Steel	4.399 gr

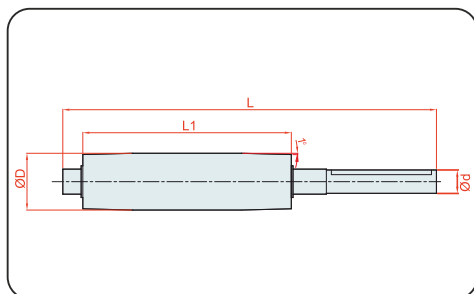

CODE	PRODUCT NAME	ΦΑΡΔΟΣ	L	L1	ØD	Ød	Material	Weight
DDS 25	Φ30 Drive drums	25	121	28	30	14	Steel	256 gr
DDS 55	Φ30 Drive drums	55	151	58	30	14	Steel	455 gr
DDS 85	Φ30 Drive drums	85	181	88	30	14	Steel	723 gr
DDS 120	Φ30 Drive drums	120	219	126	34	14	Steel	989 gr
DDS 40	Φ45 Drive drums	40	140	43	45	14	Steel	650 gr
DDS 85/45	Φ45 Drive drums	85	185	88	45	14	Steel	1.195 gr
DDS 130	Φ45 Drive drums	130	230	133	45	14	Steel	1.750 gr
DDS 150	Φ45 Drive drums	150	253	156	49	14	Steel	2.376 gr
DDS 175	Φ45 Drive drums	175	275	178	45	14	Steel	2.694 gr
DDS 200	Φ45 Drive drums	200	303	206	49	14	Steel	3.102 gr
DDS 300	Φ45 Drive drums	300	403	306	49	14	Steel	4.543 gr
DDS 450	Φ45 Drive drums	450	553	456	49	14	Steel	6.706 gr

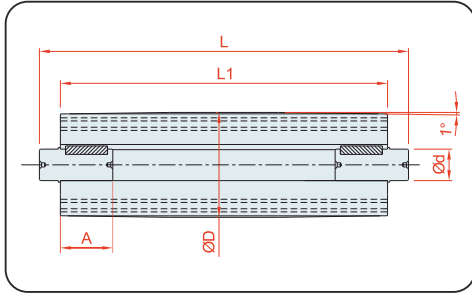

CODE	PRODUCT NAME	ΦΑΡΔΟΣ	A	L	L1	ØD	Ød	Material	Weight
KNT 40	Φ45 Tension drums	40	25	63	43	50	15	ΑΛΟΥΜΙΝΙΟ	170 gr
KNT 85	Φ45 Tension drums	85	25	108	88	50	15	ΑΛΟΥΜΙΝΙΟ	260 gr
KNT 130	Φ45 Tension drums	130	25	153	133	50	15	ΑΛΟΥΜΙΝΙΟ	350 gr
KNT 150	Φ45 Tension drums	150	25	176	156	50	15	ΑΛΟΥΜΙΝΙΟ	390 gr
KNT 175	Φ45 Tension drums	175	25	198	178	50	15	ΑΛΟΥΜΙΝΙΟ	430 gr
KNT 200	Φ45 Tension drums	200	25	226	206	50	15	ΑΛΟΥΜΙΝΙΟ	490 gr
KNT 300	Φ45 Tension drums	300	25	326	306	50	15	ΑΛΟΥΜΙΝΙΟ	670 gr
KNT 450	Φ45 Tension drums	450	25	476	456	50	15	ΑΛΟΥΜΙΝΙΟ	950 gr

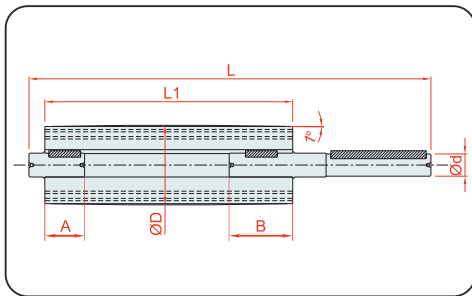

CODE	PRODUCT NAME	ΦΑΡΔΟΣ	A	B	L	L1	ØD	Ød	Material	Weight
KND 40	Φ45 Drive drums	40	25	45	140	43	50	14	ΑΛΟΥΜΙΝΙΟ	270 gr
KND 85	Φ45 Drive drums	85	25	45	185	88	50	14	ΑΛΟΥΜΙΝΙΟ	380 gr
KND 130	Φ45 Drive drums	130	25	45	230	133	50	14	ΑΛΟΥΜΙΝΙΟ	470 gr
KND 150	Φ45 Drive drums	150	25	45	253	156	50	14	ΑΛΟΥΜΙΝΙΟ	510 gr
KND 175	Φ45 Drive drums	175	25	45	275	178	50	14	ΑΛΟΥΜΙΝΙΟ	550 gr
KND 200	Φ45 Drive drums	200	25	45	303	206	50	14	ΑΛΟΥΜΙΝΙΟ	610 gr
KND 300	Φ45 Drive drums	300	25	45	403	306	50	14	ΑΛΟΥΜΙΝΙΟ	790 gr
KND 450	Φ45 Drive drums	450	25	45	553	456	50	14	ΑΛΟΥΜΙΝΙΟ	1070 gr

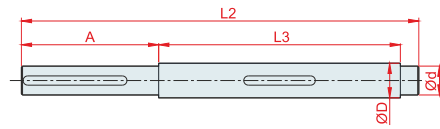
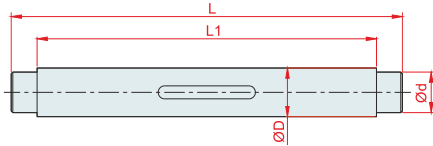

CODE	PRODUCT NAME	ΦΑΡΔΟΣ	L	L1	A	ØD	Ød	Material	Weight
PDM 82	Pallet conveyor drive miller	82,2	132,5	100,5	-	Ø30	Ø25	Steel	670 gr
PDM 114	Pallet conveyor drive miller	114,5	165	133	-	Ø30	Ø25	Steel	860 gr
PDM 190	Pallet conveyor drive miller	190,5	241,5	209,5	-	Ø30	Ø25	Steel	1270 gr
PTM 82	Pallet conveyor tension miller	82,2	235,5	100,5	119	Ø30	Ø25	Steel	1040 gr
PTM 114	Pallet conveyor tension miller	114	268	133	119	Ø30	Ø25	Steel	1220 gr
PTM 190	Pallet conveyor tension miller	190	344,5	209,5	119	Ø30	Ø25	Steel	1650 gr

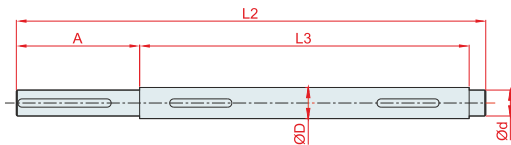
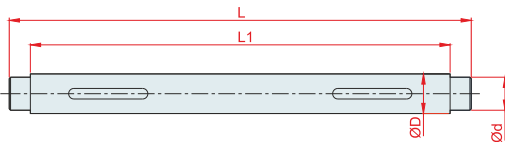
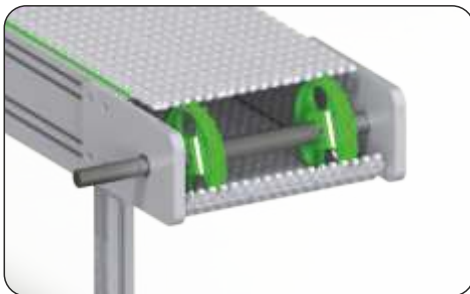

CODE	PRODUCT NAME	ΦΑΡΔΟΣ	L	L1	A	ØD	Ød	Material	Weight
PDM 200	Modular conveyor tension shaft	200	250	218	-	Ø30	Ø25	Steel	1300 gr
PDM 300	Modular conveyor tension shaft	300	350	318	-	Ø30	Ø25	Steel	1860 gr
PDM 400	Modular conveyor tension shaft	400	450	418	-	Ø30	Ø25	Steel	2410 gr
PDM 200 S	Modular conveyor drive shaft	200	353	218	119	Ø30	Ø25	Steel	1680 gr
PDM 300 S	Modular conveyor drive shaft	300	453	318	119	Ø30	Ø25	Steel	2240 gr
PDM 400 S	Modular conveyor drive shaft	400	553	418	119	Ø30	Ø25	Steel	2790 gr

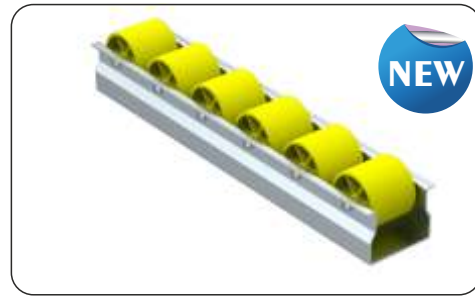
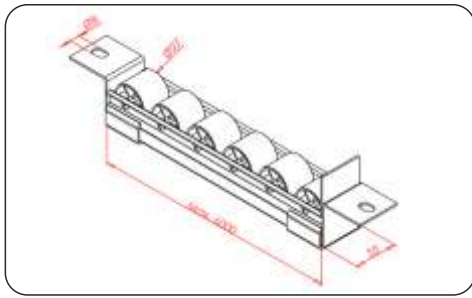

CODE	PRODUCT NAME	Material	Weight
RR 35	Roller Rail	Zinc	959 gr/m

ΔΙΑΤΙΘΕΤΑΙ ΣΕ 6m / 3m ΒΕΡΓΑ

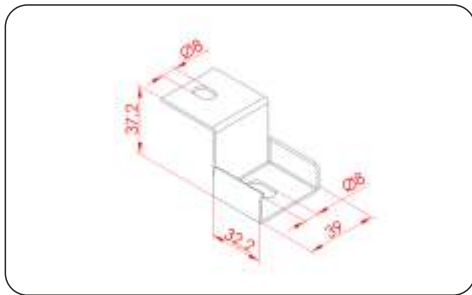

CODE	PRODUCT NAME	Material	Weight
RC 35	Roller R Connection sheet	Zinc	50,5 gr

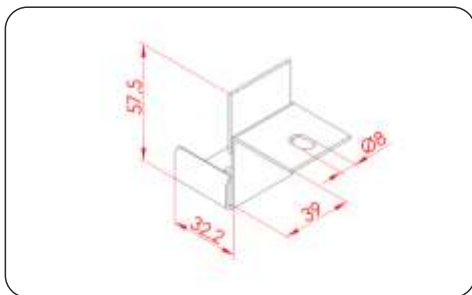

CODE	PRODUCT NAME	Material	Weight
RFS 35	Roller R Fastening & Stopping Sheet	Zinc	63 gr

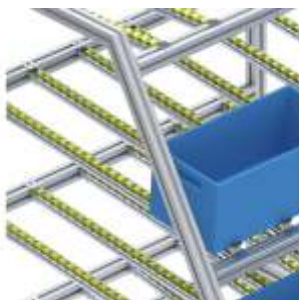



Καθαριστικό Αλουμινίων SCOOP

Κρεμώδης αλοιφή. Καθαρίζει, γυαλίζει και εξαλείφει τις γρατσουνιές, την οξείδωση και τις κηλίδες σε μέταλλα. Ειδικό για πόρτες και παράθυρα αλουμινίου.

Δεν αφήνει στάμπες και δεν αφαιρεί την γυαλάδα από την επιφάνεια.

Εγγυημένα καλό αποτέλεσμα σε λιγότερο από 1 λεπτό.

ΟΔΗΓΙΕΣ ΧΡΗΣΗΣ:

- Ανακινήστε καλά το μπουκάλι πριν την χρήση.
- Εφαρμόστε μια μικρή ποσότητα στην επιφάνεια προς επεξεργασία.
- Τρίψτε καλά με ένα καθαρό πανί για να επιτευχθεί το επιθυμητό αποτέλεσμα.

Συσκευασία: 1000 gr

Καθαριστικό Αλουμινίων NEW LINE

ΙΔΙΟΤΗΤΕΣ & ΕΦΑΡΜΟΓΕΣ

Αποτελεσματικό προϊόν για τον καθαρισμό των επεξεργασμένων με ηλεκτροστατική βαφή αλουμινίων (όπως παράθυρα, παντζούρια, μπαλκονόπορτες κ.τ.λ.

Αφαιρεί λεκέδες από καυσαέρια, άλατα νερού, διάφορες ξεραμένες επικαθίσεις εύκολα και γρήγορα. Αφαιρεί επίσης υπολείμματα κόλλας από χαρτοταινίες, πλαστικές ταινίες, καθώς και υπολείμματα αφρού πολυουρεθάνης, πλαστικά χρώματα εφόσον δεν έχει περάσει διάστημα μεγαλύτερο των 2-3 ημερών. Ιδανικό προϊόν για τον καθαρισμό αλουμινοκατασκευών αμέσως μετά από οικοδομικές εργασίες κατασκευής, επισκευής ή συντήρησης.

ΠΕΡΙΕΧΕΙ: Λιγότερο από 5% μη ιονικές και ανιονικές επιφανειοδραστικές ουσίες.

ΠΛΕΟΝΕΚΤΗΜΑΤΑ

- Έχει γρήγορη δράση και άριστο αποτέλεσμα καθαρισμού, σε μικτούς λεκέδες που προκύπτουν από την υγρασία της ατμόσφαιρας και άλλων λιπαρών επικαθίσεων.
- Δεν διαβρώνει τις επιφάνειες των αλουμινίων και μπορεί να χρησιμοποιηθεί για περιοδικό καθαρισμό.
- Αφαιρεί υπολείμματα κόλλας από χαρτοταινίες, πλαστικές ταινίες πολυουρεθάνης, p.v.c.
- Αφαιρεί (πιτσιλίσματα από τα πλαστικά χρώματα εντός 2-3 ημερών)
- Συσκευασία σε spray για ευκολία στη χρήση.

Συσκευασία: 500 ml



Aluminium Cleaner Durostick

Καθαριστικό υγρό για αλουμινοκατασκευές

Δραστικό καθαριστικό που αφαιρεί εύκολα, με ένα πέρασμα, ρύπους από καυσαέρια, άλατα, χρώματα, λασπобροχή, καθώς και νωπά (2-3 ημερών το πολύ) πιτσιλίσματα πλαστικών χρωμάτων. Είναι ιδανικό για χρήση σε κουφώματα αλουμινίου-άβαφα ή περασμένα με ηλεκτροστατική βαφή-χωρίς να αλλοιώνει ή να επηρεάζει το αρχικό τους χρώμα.

Συσκευασία: 500 ml



- Τρόπος πληρωμής μετρητοίς
- Τα μεταφορικά επιβαρύνουν τον πελάτη
- Ο παρών κατάλογος καταργεί τον προηγούμενο
- Στα προφίλ δεν γίνονται επιστροφές
- Στα εξαρτήματα οι επιστροφές θα γίνονται κατόπιν συνεννόησης
- Χρόνος παράδοσης κατόπιν συνεννόησης
- Η εταιρία δεν φέρει καμία ευθύνη για τυχόν φθορές από την μεταφορά

ΑΡΙΘΜΟΣ ΛΟΓΑΡΙΑΣΜΟΥ ΤΡΑΠΕΖΑ ΠΕΙΡΑΙΩΣ:

Αρ. λογ.: 5242 0035 75529

IBAN: GR 22017 22420 00524 20035 75529



INDUSTRIAL ALUMINIUM PROFILE SYSTEMS



Systems



Chassis



Conveyors



Machine



ΜΕΙΜΑΡΙΔΙΣ

ΕΜΠΟΡΙΑ ΣΙΔΗΡΟΥ - ΑΛΟΥΜΙΝΙΟΥ - ΓΥΦΟΣΑΝΙΔΑΣ - ΧΡΩΜΑΤΩΝ
ΣΟΒΑΔΩΝ - ΙΝΟΧ ΠΑΝΤΟΣ ΤΥΠΟΥ - ΒΙΟΜΗΧΑΝΙΚΑ ΕΡΓΑΛΕΙΑ
(ΣΤΡΑΝΤΖΑ - ΨΑΛΙΔΙ - ΚΥΛΙΝΔΡΟΣ - ΠΑΝΤΟΓΡΑΦΟΣ)

ΑΦΟΙ ΜΕΪΜΑΡΙΔΗ Ο.Ε.

Σταδίου 97 - Βέροια

Τηλ.: 23310 23342 - 23178 / Fax: 23310 67869

www.meimaridis.gr | info@meimaridis.gr



MODULAR CONSTRUCTION TECHNOLOGIES

ΚΑΤΑΛΟΓΟΣ

2021

e-mail: sales@aluminium-profile.gr

www.aluminium-profile.gr

